



DEVELOPMENT REVIEW COMMITTEE (DRC) COMMENT REPORT

MEETING DATE: July 10, 2018

APPLICANT: Bear Traxx, LLC.

PROJECT NAME: 1401 SW 1st Avenue

CASE NUMBER: E18013

REQUEST: Easement Vacation: Partial Vacation
(1,796 Square Foot) of Drainage and Utility
Easement

LOCATION: South of SW 14th Street, west of SW 1st Avenue,
north of SW 15th Street and east of the FEC
railroad tracks

ZONING: South Regional Activity Center - South Andrews
west (SRAC-SAw)

LAND USE: South Regional Activity Center (S-RAC)

CASE PLANNER: Yvonne Redding



Case Number: E18013

CASE COMMENTS:

Please provide a written response to each of the following comments:

1. Demonstrate compliance with Adequacy Review requirements per ULDR Sections 47-25.2.C (Drainage facilities) and 47-25.2.L (Stormwater), that the easement area to be considered for vacation will not adversely affect adjacent streets and properties.
2. Applicant to provide copy of deed book records for easement background and purpose.
3. Please contact City's Public Works Department, Rick Johnson at rjohnson@fortlauderdale.gov or 954-828-7809 for water and sewer utilities, and Elkin Diaz at 954-828-6539 or ediaz@fortlauderdale.gov for stormwater infrastructure, to verify and determine whether there are any public utilities present within the easement to be considered for vacation. If so, a surveyed location of the utilities shall be provided to staff for review, the full cost of relocation of the utilities shall be borne by the Applicant, and the utility relocation plan shall be reviewed and approved by the City's Public Works Department prior to implementation.
4. Provide letters from all franchise utility providers, including Public Works as appropriate (i.e. if easement being vacated is public), demonstrating their interests in maintaining or no objection to the vacation of this Easement; the letters should specifically state whether or not the franchise utility providers have existing facilities within the Easement vacation area that will need to be relocated or abandoned.
5. Submit a stamped copy of the surveyor's sketch and legal description to the City's Surveyor for his review and approval of the easement to be considered for vacation. The approved surveyor's sketch shall then be routed to the Land Development Manager or designee for signoff, prior to submittal to the case planner for final authorization to present this item to the City Commission.
6. Please be advised that the vacating ordinance shall not be in full force and effect until an Engineer's Certificate is executed by the City Engineer or designee. This Engineer's Certificate shall be executed by the proper authorities and recorded in the public records of Broward County. A copy of the recorded certificate is to be provided to the City upon recordation. The City Engineer's certificate shall also state that all the existing facilities within the vacated easement have been relocated or abandoned to the satisfaction of the respective utility owners.
7. Additional comments may be forthcoming at the meeting.



Case Number: E18013

CASE COMMENTS:

The City owns and maintains stormwater infrastructure adjacent to the proposed development as shown with green line work in the GIS map provided at the end of this report. The following comments pertain to possible impacts of the proposed development and/or construction activities to the existing condition of the City's stormwater assets. The applicant shall provide an itemized response letter addressing the following comments:

Prior to Final DRC Sign Off, the applicant shall respond to the following comments:

1. Please email CRBARRETT@FORTLAUDERDALE.GOV to obtain copies of the City utility maps as applicable to the project location and show existing City utilities and easements (water, sewer, forcemain, and stormwater utilities) in proposed engineering plans (utility demolition, stormwater pollution prevention plan (SWPPP), and civil plans).
2. Please note that private stormwater infrastructure (drainage pipes, wells, or basins,), Trees, or Permanent Structures (fences, walls, etc) are not permitted in City Right of Way or City drainage easements. Please remove any proposed stormwater systems, trees, or permanent structures that are not in compliance with this requirement or provide appropriate documentation of City Rights-of-Way or easement vacated to allow the construction of private underground utilities.
3. The location of the 48" drainage pipe running on the West side of the property needs to be verified by the applicant via potholes or other survey means. A title search may be necessary to evaluate utility easements and maintenance agreements that may have been done in the past in reference to the existing drainage infrastructure. Any impacts to the existing stormwater assets own by the City and the ability to Public Works staff to maintain the assets due to the proposed development shall be addressed by applicant to comply with all applicable City, County, and State regulations.
4. If dewatering activities are anticipated, a notarized City dewatering affidavit shall be filed at City's building department when submitting a demolition or foundation permit along with any applicable dewatering permit form regulatory agencies such as the South Florida Water Management District or Broward County Department of Environmental Protection.

Prior to Issuance of Building Permit, the applicant shall address the following comments:

1. Please provide (or revise if already submitted) an erosion, sedimentation, and stormwater pollution prevention plan (**SWPPP**) showing the adjacent City's existing stormwater system as shown in the survey and to the limits shown with green line work in the storm map provided at the end of this report. A copy of the approved SWPP shall be at the construction site from the date of demolition initiation to the date of final construction activities.

Add the following notes to the **SWPPP** (CCTV Notes, Pollution Prevention Notes, and Dewatering Notes):

Closed Circuit TV inspection (CCTV) Notes (Applicable if dewatering to City stormwater assets)

- a) Contractor shall provide CCTV videotapes to City STW OPS of the existing stormwater system to the limits shown with green line work in the storm map provided at the end of this report in order to document the PRE and POST construction conditions of the City's storm system.
- b) Contractor shall provide the PRE construction CCTV to City STW OPS when applying for a demolition permit at the City's building department.
 - i. If debris is found in the City's stormwater system prior to demolition or construction, the applicant, contractor, developer or designer (as applicable) shall inform the City's stormwater operations department for proper removal.



- c) Contractor shall provide the POST construction videotape to City STW OPS when requesting the Certificate of Occupancy (CO) to verify that the City's stormwater systems have not been negatively impacted by the demolition and construction activities.
 - I. If debris is found in the City's storm systems as a result of demolition or construction activities, it will be the responsibility of the contractor to vacuum clean the City's stormwater system (or make repairs as requested by City's stormwater operations group) prior to issuance of final CO.
 - II. If surface water runoff or debris from demolition or construction activities is found to have negatively impacted the condition of the City's stormwater assets, it will be the responsibility of the applicant (contractor, developer, and owner) to rectify the infraction(s) as requested by City.

Pollution Prevention Notes (Applicable to most site developments)

- a) Contractor shall adhere to of the National Pollution Discharge Elimination System (NPDES) requirements. The contractor shall institute Best Management Practices (BMPs) to ensure compliance with the NPDES program and to minimize the impact to public stormwater facilities. A Notice of Intent (NOI) shall be filed prior to start construction activities.
- b) Prior to demolition activities, contractor shall install pollution prevention control devices (i.e., silt barriers, sediment basins, turbidity barriers around stormwater outfalls on the waterside of lakes, ponds, canals, or waterways, silt screens, etc. according to the approved SWPPP and as recommended by the Florida Department of Environmental Protection (DEP) latest guidelines and permitting requirements.
- c) Prior to demolition activities, a silt fence in accordance with the approved SWPPP details and latest DEP standards shall be erected around the site property lines. All public inlets surrounding the site shall be protected by the installation of filter fabric into the frame and grate or other approved BMPs to protect against storm runoff.
- d) Pollution control installations, as approved and shown in the SWPPP, shall be maintained throughout demolition and construction periods until the project has been completed and approved by City engineering inspector or project engineer.
- e) Contractor shall inspect the pollution control devices daily for signs of malfunction, failure, or needed repairs, and shall make remedial actions immediately upon discovery.
- f) Existing stormwater inlets, catch basins, or manholes, onsite and offsite, shall be protected from sediment storm runoff from the proposed demolitions and construction activities.
- g) Contractor shall immediately remove all mud, dirt, or other materials tracked or spilled onto existing roads and facilities due to demolition or construction activities from the proposed development.
- h) In order to minimize the amount of sediments, mud, and dust transported onto public roadways by the construction vehicles or runoff, the contractor shall install stabilized temporary construction entrance(s) from the construction site as recommended by FDEP. Each temporal construction entrance is a stabilized 6 inch thick layer of 2 to 3 inch Course Aggregate Stone, 12" minimum width, and length to accommodate a minimum of one trucking vehicle.
 - i. The entrance shall be maintained periodically as conditions demand in a condition that will prevent tracking or flowing of sediments onto public rights-of-way. Sediment shall be trapped in cleanout areas and properly handled as onsite debris per applicable state regulations.
 - ii. When necessary, vehicle wheels shall be cleaned prior to entrance onto public right-of-way.
 - iii. All materials spilled, dropped, washed or tracked from vehicles onto roadways or into public storm drains must be removed by the contractor immediately.
 - iv. Trucks shall not 'cut corners' where the construction exit meets the roadways.
 - v. Sweeping of public roadways shall be done periodically as condition demand.
- i) Dust generated from construction shall be minimized by daily watering of the site.



- j) Contractor shall provide an erosion and sedimentation control inspector to inspect all points of discharge into nearby waterbodies to record the condition of discharge points, integrity of silt fence and pollution control devices, dust control measures, vehicular traffic and construction material storage and disposal. Written record of all inspections shall be stored by the contractor during demolition and construction periods and shall be submitted to City inspectors upon request.

The inspection report shall include at a minimum the following information:

- i. Name of inspector and his/her qualifications in erosion and sedimentation control
- ii. Date of the inspection
- iii. Rainfall rate
- iv. Observations about the SWPP
- v. Actions taken by contractor for all incidents of noncompliance with permit(s)
- vi. Certification that the facility is in compliance with the SWPP and permit(s)

Dewatering Notes (Applicable if dewatering activities are anticipated)

- a) The applicant shall use Broward County's latest [Plate WM 2.1 - Future Conditions](#) for determining the average wet season ground water levels to evaluate if demolition or excavation/earthwork will require dewatering activities. The Plate WM 2.1 – Future Conditions average wet season ground water levels can be accessed through the following link:
<http://bcgis.maps.arcgis.com/apps/View/index.html?appid=70c3f3ffc88748c28e432719ec2844c4>
- b) If dewatering activities are anticipated, a notarized City dewatering affidavit shall be filed at City's building department when submitting a demolition or foundation permit along with any applicable dewatering permit form regulatory agencies such as the South Florida Water Management District or Broward County Department of Environmental Protection.
- c) If dewatering is going to be needed, please submit a dewatering plan, so it can be reviewed by the City's stormwater and environmental groups.
- d) Dewatering activities will not be allowed without an approved dewatering affidavit, SWPPP, and dewatering permit from applicable regulatory agencies.

GENERAL COMMENTS

2. Please prepare and submit a separate utility demolition plan for review of impact to existing City's stormwater systems.



Existing Stormwater Asset Map possibly affected by the Proposed Development





Case Number: E18013

CASE COMMENTS:

1. Please provide a 10 foot public easement on the west side of the site. This easement would be used in the future to continue the proposed Flagler greenway adjacent to the Florida East Coast Railroad.
2. Additional comments may be provided upon further review.
3. Signature required.

GENERAL COMMENTS:

Please address comments below where applicable.

1. Contact Benjamin Restrepo at 954-828-5216 or brestrepo@fortlauderdale.gov to set up an appointment for final plan approval.
2. The City's Transportation & Mobility Department encourages the use of sustainable materials such as permeable pavement and electric car charge stations and installation of multimodal facilities such as bicycle pump stations and bike lockers.
3. Please note that any work within the City's right-of-way will require an MOT approved by Transportation and Mobility and Engineering for permitting. Any full closures of roadways, alleys, or sidewalks that are over 72 hours will require a Revocable License Agreement (RLA) with the City of Fort Lauderdale.



Case Number: E18013

CASE COMMENTS:

Please provide a response to the following:

- 1) The applicant is strongly encouraged to contact all neighborhood associations located within three hundred feet (300) of the development site, to advise of this proposal (a map and listing of all neighborhood associations are listed on the City's website).
- 2) Please provide information satisfactory to our Engineering Reviewer regarding the 40" storm drain which exists within the easement.
- 3) Provide signed/sealed sketch and legal descriptions for the City Surveyor's review and approval. Signoffs from the City Surveyor and the Urban Design Engineer will be required prior to City Commission submittal. The signoff for the City Surveyor will be routed by Planning Staff.
- 4) The proposed project requires review approval by the City Commission. A separate application and fee is required for City Commission review.
- 5) The resolution approving the vacation of easement shall be recorded in the public records of Broward County within (30) days after adoption.

GENERAL COMMENT:

The following easement documents must be reviewed and approved by City Staff prior to final approval:

- Attorney's Opinion of Title
- Easement Deed
- Survey, Sketch and Legal Description
- Joinder, Consent, and Partial Release by Mortgagee/Lien Holder

The instructions and templates for these documents may be found at <https://www.fortlauderdale.gov/departments/sustainable-development/building-services/engineering-forms-and-info> listed under the topic "Dedicated Public Rights of Way and Easements." Please submit these documents electronically to Judy Johnson at jjohnson@fortlauderdale.gov.

*Also, Provide a copy of the instruction sheet and the flow chart (See Procedures and Forms)

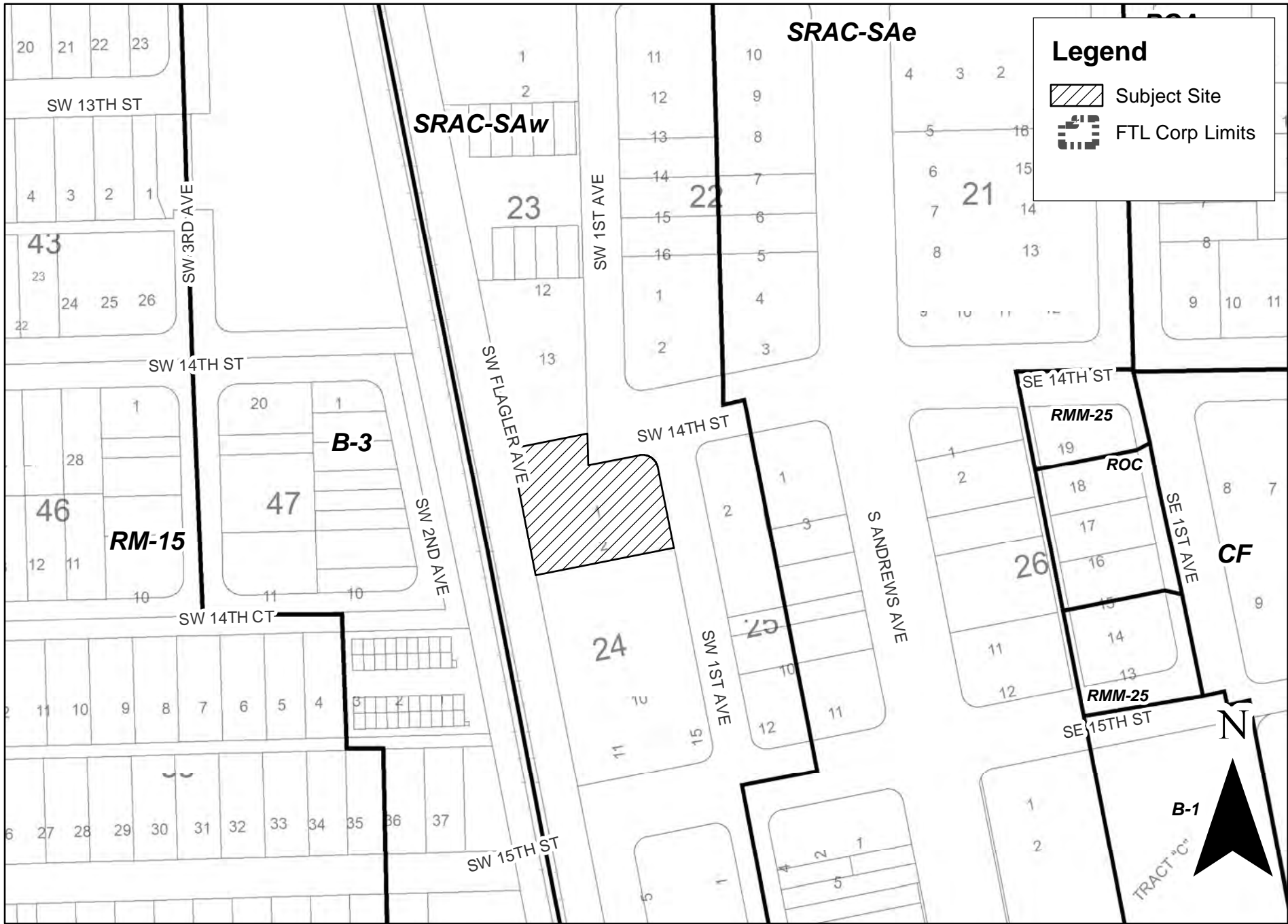

E18013

