



DEVELOPMENT REVIEW COMMITTEE (DRC) COMMENT REPORT

MEETING DATE: October 8, 2019

APPLICANT: Amu Corporation

PROJECT NAME: Holiday Inn Express & Suites

CASE NUMBER: R19047

REQUEST: Site Plan Level II Review: 110-Room Hotel

LOCATION: 2731 North Federal Highway

ZONING: Boulevard Business (B-1)

LAND USE: Commercial

CASE PLANNER: Yvonne Redding



Case Number: R19047

CASE COMMENTS:

- 1) Provide the FBC Building Type designation (Chapter 6) on the plans.
- 2) Indicate Code compliant Sprinkler System.
- 3) Indicate Provisions for Enclosed Parking per FBC 406.6

GENERAL COMMENTS

The following comments are for informational purposes.

Please consider the following prior to submittal for Final DRC:

1. The Florida Building Code shall apply to the construction, alteration, movement, enlargement, replacement, repair, equipment, use and occupancy, location, maintenance, removal and demolition of every building or structure or any appurtenances connected or attached to such buildings or structures.
2. All projects must consider safeguards during the construction process. Florida Building Code Chapter 33 delineates various safeguards that may apply during the construction phase. All structures associated with the protection of pedestrians will require a separate permit. A licensed professional must sign and seal the plans and specifications.
3. The City of Fort Lauderdale is a participating municipality in the National Flood Insurance Program (NFIP). The requirements specific to the City of Fort Lauderdale can be found in

Chapter 14 - FLOODPLAIN MANAGEMENT of the Code of Ordinances and accessed at;

a. https://www.municode.com/library/fl/fort_lauderdale/codes/code_of_ordinances?nodeId=COOR_CH14FLMA

Please consider the following prior to submittal for Building Permit:

1. On January 1st, 2018 the 6th Edition of the Florida Building Code was adopted. All work described in Section 101.2, of the Broward County Administrative portion of the Florida Building Code, will govern the administration and enforcement of the proposed work. Each building and or structure will require a separate permit. The following websites will assist in the design considerations:
 - a. <http://www.fortlauderdale.gov/departments/sustainable-development/building-services>
 - b. https://floridabuilding.org/bc/bc_default.aspx
 - c. <http://www.broward.org/codeappeals/pages/default.aspx>

General Guidelines Checklist is available upon request.



Case Number: R19047

DEDICATION OF RIGHTS-OF-WAY: Per ULDR Section 47-25.2.M.5, property shall be conveyed to the public by plat, deed or grant of easement as needed in accordance with the Broward County Trafficways Plan, the city's comprehensive plan, subdivision regulations and accepted applicable traffic engineering standards:

- a. Provide 10' x 15' (min.) permanent Utility Easement for any 4 Inch or larger water meter and/or the first private sanitary sewer manhole located within the proposed development (for City Maintenance access); show / label delineation in the plans as appropriate.

CASE COMMENTS:

Prior to Final DRC sign-off, please provide updated plans and written response to the following review comments:

1. Meet the City's Adequacy requirements to services provided to the public (fire service, water, wastewater, stormwater, transportation, etc.), per ULDR Section 47-25.2 of the City's Code of Ordinances. Assess potential demands and impacts on City services and prepare a design for each that utilizes existing water, wastewater, stormwater, and transportation infrastructure to adequately serve this project. If the adequate infrastructure is not available, prepare a design that extends/expands the connection to the nearest City system to adequately serve this development.
 - a. Prepare service demand calculations for water & wastewater services and obtain a letter of service availability from the City's Public Works – Engineering Department. Submit water and wastewater capacity availability request form and documents/ plans at <https://www.fortlauderdale.gov/departments/sustainable-development/urban-design-and-planning/development-applications-boards-and-committees/development-review-committee-service-dema>
2. Provide disposition of existing utilities on-site and within the adjacent right of way that maybe impacted by the proposed development. Label information on plans (i.e. utility to remain/ be relocated/ removed). Provide correspondence from utility owner (as applicable) and depict any additional requirements they may have on plan (i.e. easements). Utilities include but are not limited to above and underground water, sewer, drainage, electrical, communications, light/power poles, down guys, fire hydrants, manholes, etc.
3. Proposed required on-site improvements shall not be constructed within existing or proposed right of way/ dedications/ easements. If encroachments are proposed, provide correspondence from FDOT indicating the same is allowed.
4. Clearly indicate on plans the limits of construction and how the proposed improvements will transition into the existing (on-site and off-site) as applicable. Proposed sidewalk on south side of property does not appear to align with existing sidewalk.
5. Provide disposition of existing light poles, fire hydrants, and any other utilities within the adjacent right of way that maybe impacted by the proposed development.
6. Per ULDR Section 47-2.2.Q, show and label sight triangles as appropriate for safe and adequate access of drivers and pedestrians, on the Site Plan, Landscape Plans, and Civil Plans: intersections of driveways with streets and alleys (10' measured from intersection point of pavement edges), alleys with alleys (15' measured from intersection point of extended property lines), alleys with streets (15'



measured from intersection point of extended property lines), and streets with streets (25' measured from intersection point of extended property lines). The request for reduction of sight triangle dimensions is subject to review by the City Engineer on a case-by-case basis. Per ULDR Section 47-19.1.E, no accessory use or structure shall be permitted within a sight triangle except as provided in [ULDR Section 47-35](#).

7. Provide and label FDOT sight triangle (per the most current FDOT Design Standards) on the Site Plan, Landscape Plan, and Civil Plans.
8. Provide and label typical roadway cross-sections for the proposed development side of North Federal Highway, at driveway access points, at on-street parallel parking lanes, and at landscape swale areas (i.e. between travel lane and sidewalk) as appropriate.
9. Existing public sidewalks adjacent to proposed development (to remain) must be inspected by Engineer of Record to ensure existing sidewalks meet ADA standards and are in good condition. A signed and sealed assessment must be provided indicating sidewalks were inspected and any sidewalk replacement requirements. Plans shall reflect extent of sidewalk replacement accordingly.
10. Continue concrete sidewalk across driveway tie-in per the appropriate FDOT Design Standard.
11. For surface or ground-level parking lot layout:
 - a. Show and label total number of parking stalls, dimension areas including drive aisle widths, and typical parking stall width/depth.
 - b. Per ULDR Section 47-20.11.A, drive aisle width shall be 24' (min.) adjacent to 90-degree angle parking stalls, 18' (min.) adjacent to 60-degree angled parking stalls, 13' (min.) adjacent to 45-degree angled parking stalls, and 12' (min.) adjacent to 30-degree angled parking stalls.
 - c. The minimum clear width and depth parking stall dimensions shall be 8'-8" and 18'-0", respectively, and shall not be encroached upon by building columns.
12. For all levels in the parking garage:
 - a. Show and label total number of parking stalls, dimension areas including drive aisle widths, vertical clearances, typical parking stall width/depth, as well as sloping floor and ramp grades.
 - b. Per ULDR Section 47-20.9.A, parking garage sloping floor grades shall not exceed 5% and 4%, adjacent to 90-degree and 60-degree angle parking stalls, respectively; angle parking on sloping floors shall be minimum 60 degrees. Ramp grades shall have 12% maximum slope where not adjacent to parking stalls.
 - c. Per ULDR Section 47-20.11.B, compact parking spaces are only permitted when expanding an existing parking garage.
 - d. The minimum clear width and depth parking stall dimensions shall be 8'-8" and 18'-0", respectively, and shall not be encroached upon by building columns.
13. Clearly depict trash enclosure on site plan. Show truck turning movements in and out the proposed dumpster enclosure/ building as applicable. Per ULDR Section 47-19.4.D.6, all dumpster enclosures and adjacent service access drive shall be placed on poured concrete, solid or perforated interlocking concrete block paving (ICB), or any existing hardened paving system.
14. Depict proposed building doors and provide sufficient grades/details on conceptual paving, grading and drainage plans to verify ADA accessibility design for the site, especially ground floor access to the new building, as well as crossing proposed driveways and connecting to existing sidewalks (at intersections and with adjacent property) as appropriate; coordinate proposed site grading and 1st Level Finished Floor Elevations to meet ADA accessibility requirements.



15. Per ULDR Section 47-19.3 (Seawall Ordinance): the top of seawall for redeveloped property shall be between elevation 3.9 feet NAVD88 (minimum height) and FEMA base flood elevation for the property (maximum height) except as described under ULDR Section 47-19.3.f; allowance for fixed docks to extend 10 inches above the adjacent seawall; allowance for floating docks and requirement that they be permitted and permanently attached.
16. Verify whether existing seawall will be structurally affected by construction of proposed parking garage.
17. Proposed trees shall be installed a min. 4 feet behind proposed curbs when adjacent to travel lanes and a min. 6 feet away from adjacent travel lanes when no curb is present.
18. Within adjacent City Right-of-Way, staging/storage will not be allowed, construction fence shall not encroach within intersection corner sight triangles, construction fence gates shall not swing into the public Right-of-Way, and any Jib Crane radius shall not extend beyond private property boundaries. Any City Right-of-Way closure over 72 hours requires a Revocable License Agreement, processed by Property Right-Of-Way Committee (DRC) and approved by the City's Commission, prior to Right-of-Way permit issuance by the Department of Sustainable Development for Maintenance of Traffic.

Prior to submitting Administrative Review (i.e. DRC Level I) application to request Revocable License Agreement, please contact Dennis Girisgen at 954-828-5123 or dgirisgen@fortlauderdale.gov to discuss proposed scope of closure within City Right-of-Way.

19. Provide Maintenance Agreement Area Exhibit, which provides a visual representation of the area within the adjacent public Right-of-Way (adjacent to the proposed development) to be maintained in perpetuity by the developer. Label whether the adjacent Right-of-Way is FDOT, BCHCED, or City jurisdiction, as well as label all proposed improvements, including asphalt and other specialty paving, specialty sidewalks, landscaping, irrigation, lighting, curb and gutter etc. that will be maintained by the Applicant throughout the life of the improvements. Perpetual maintenance of newly constructed exfiltration trenches, inlets, etc. within adjacent City Right-of-Way will typically revert back to the City, upon successful inspection/acceptance by Public Works after 1-year warranty period.
20. Please email CRBARRETT@FORTLAUDERDALE.GOV to obtain copies of the City utility maps as applicable to the project location and show existing City utilities and easements (water, sewer, forcemain, and stormwater utilities) in proposed engineering plans (utility demolition, stormwater pollution prevention plan (SWPPP), and civil plans).
21. Conceptual Paving, Grading, and Drainage Plan
 - a. Provide sufficient existing and proposed grades and information on conceptual Paving, Grading, and Drainage Plan and details to demonstrate how stormwater runoff will remain onsite (include typical cross-sections along all property lines, typical lot grading for the proposed single family homes within the development, and depict how the new stormwater system will connect to the existing on-site drainage system), and how the proposed project improvements (i.e. on-street parking, sidewalks, etc.) will not adversely impact the adjacent Right-of-Way, properties and waterways. Show location of building roof drains, and their proposed connection(s) to the on-site drainage system. **Label existing storm inlets using the labels provided in the figure at the end of these notes.**
22. Provide storm runoff calculations, signed and sealed by a Florida registered professional engineer, which demonstrate how minimum criteria regarding adjacent street crown, water quality and finished floor elevations are met, as well as how the 25-year, 3-day storm event is maintained on site with zero discharge to Right-of-Way and adjacent properties. Please also comply with the City of Fort Lauderdale Comprehensive Plan (Ordinance C-08-18), Objective 4.1 under Infrastructure Elements,



and be advised that effective 7/1/2017, all projects must comply with the Broward County 'Future Conditions Average Wet Season Groundwater Level' map.

23. If dewatering activities are anticipated, a notarized City dewatering affidavit shall be filed at City's building department when submitting a demolition or foundation permit along with any applicable dewatering permit form regulatory agencies such as the South Florida Water Management District or Broward County Department of Environmental Protection.
24. Contact the Floodplain Manager, Richard Benton at 954-828-6133 or rbenton@fortlauderdale.gov regarding proposed Finished Floor elevation and fill requirements per City's Code of Ordinances Chapter 14 – Floodplain Management, including Ordinance C-14-26. Provide correspondence and depict information on plans accordingly.
25. Show and label all existing and proposed utilities (utility type, material and size) on civil and landscaping plans for potential conflict. A min. 5 feet and 10 feet horizontal clearance horizontal separation is required between city utilities infrastructure and proposed small and large trees, respectively (including proposed water and sewer services to the development). Any new trees (located within or adjacent to City Right-of-Way) should be placed with sufficient horizontal and vertical distances (per City, County, and State guidelines) to / from City's public infrastructure, including stormwater assets, to allow for continued Public Works maintenance without obstruction. If this cannot be accommodated due to field conditions, then the developer shall relocate the existing City's public infrastructure to resolve the conflict(s) and to comply with City's, County's & State's engineering standards/permits/policies. Ensure separation is provided and include a note regarding horizontal clearance requirement on the landscape plans.
26. Discuss how surface runoff from the proposed development (between building and Right-of-Way boundaries) will be mitigated such that it won't be conveyed into the adjacent existing public storm drain infrastructure or waterways, and whether additional infrastructure will be required within City Right-of-Way (coordinate as appropriate with the respective FDOT and BCHCED agencies for mitigation of additional runoff within those jurisdictions). Show location of building roof drains, and their proposed connection(s) to the on-site drainage system.
27. Evaluate the possibility of utilizing a sustainable stormwater approach with the possibility of low impact (cisterns, pervious pavers, bioswales, raingardens, etc.) uses for landscaping along the streetscape.
28. For Engineering General Advisory DRC Information, please visit our website at <https://www.fortlauderdale.gov/home/showdocument?id=30249>
29. Additional comments may be forthcoming at the DRC meeting and once additional/ revised information is provided on plans.



Existing Stormwater Asset Map possibly affected by the Proposed Development





Case Number: R19047

CASE COMMENTS:

Please provide a response to the following:

1. The City has adopted Florida Friendly Landscaping requirements into our ULDR Section 47-21. This basically means that plant material must be grouped together based on watering needs (hydro zone) and turf areas must be limited and/or consolidated to less than 50% of the landscaped area. Plant material species must be minimum 50% Florida Friendly Landscaping. Planting areas are to be irrigated on a separate zone than the turf areas so that once the plants are established, that particular zone can be shut off based on the season. The overall goal is to decrease water use through irrigation. Illustrate hydro zones on planting plan, and include calculations in table.
2. Approval from jurisdiction for landscape installation in Right Of Way, preferred prior to final DRC sign off. If jurisdiction approval is obtained after DRC final sign off and the plans require any change, Administrative Review will be required prior to permit review.
3. Please verify FDOT dedication requirement for along N. Federal HWY.
 - a. This dedication if required will require the site to be redesigned to fulfill the Interdistrict Corridor requirement.
4. Illustrate and label the horizontal clearance from tree trunk to edge of utility on the landscape plan. Landscaping must provide a minimum horizontal clearance of 5 feet for small trees and palms, and a minimum of 10 feet for large trees and palms from underground utilities. Provide a cross section detail to illustrate this clearance.
 - a. There appears to be a storm drain on N. Federal HWY. at the south end of the property. Please verify the underground portion of this utility in relation to the propose trees.
5. Provide street trees in the right of way swale area, as per ULDR 47-21.13.B.16. Please provided at a ratio of one street tree per forty feet of street frontage or greater fraction thereof not subtracting ingress and egress dimensions. Please Consider that, in order to maximize the shade for a positive pedestrian experience, the city prefers continuous canopy coverage with 100% large canopy trees in these areas.
 - a. Being that there may be a conflict with horizontal clearances from underground utility and possible FDOT requirements. For the positive pedestrian experience, please propose large shade trees on the west side of the sidewalk along N. Federal HWY.
 - b. Please demonstrate how the sidewalk will transition on the south end of the site along N. Federal HWY.
6. The use of CU structural soil is required in paved sites to provide adequate soil volumes for tree roots under pavements, as per ULDR Section 47-21.13. CU Structural soil details and specifications can be obtained at <http://www.hort.cornell.edu/uhi/outreach/index.htm#soil> This is to be provided at a minimum of 8' radii of tree trunks, and is to be consistently illustrated and noted on landscape, site and civil plans.
7. The structural soil drain is required when percolation rates are less than 4" vertical clearance per hour. Provide documentation of report used to prove this calculation. The drain and connections are to be illustrated on civil plans.
 - a. Demonstrate hashing on landscape, site and civil plans as to the extent of use of the Structural Soil.



- b. Provide Structural Soil Detail and composition.
8. There is a product that the Landscape Department will approve the use of in place of Structural soil. With the Structural soil repositioning of the underground utilities is required. A suspension modular paving system product will provide the required root development area for a healthy and vibrant tree, along with their use it will allow the utilities to be in place and not affect their location in conjunction with the tree's root system. Please look into the use of the Green Blue Urban soil cell, Silva cell or like product for this and all future site developments.

As with the use of Structural soil a detail of the product and indication of the extent of use to be provided of the soil cell pavement support systems product.

9. In lieu of tree grates, the City of Fort Lauderdale prefers the use of a cold applied, poured in place tree grate system that is designed to bind a selection of decorative aggregates, which provide a bonded, walkability, attractive and porous surface for tree pit such as ADDAPAVE TP, etc.
10. Light fixtures with an overall height of more than ten feet shall be located a minimum of 15 feet aware from shade trees, as per ULDR Section 47-21.12.
- a. Is any up lighting being proposed for security and or enhanced visual aesthetics?
11. Please consider placing the overhead power line utilities underground.
12. For parcels on a waterway, the first twenty (20) feet of the yard fronting on the waterway shall be landscaping. Measurement shall be from the existing bulkhead line. When the parcel is used for marina or yacht club purposes or for other businesses which are established primarily to repair or service watercraft, the waterway landscape area setback is not required. Section 47-21.13.B.7.
- a. Please propose a lush vegetative landscape screening installation within the 20 feet waterway yard fronting the view of the neighboring residential properties. Please provide a multi - tiered installation utilizing shade and flowering trees, shrubs and ground covers. Please also investigate the use of immediate impact landscape materials such as Bamboo. Mast trees (Polyalthia longifolia) may also be a benefit due to their narrow yet tall canopy.
13. Utilities and site amenities such as walkways, flagpoles, transformers, fire hydrants, sewer and water supply lines, trash enclosures, and similar items located on the site shall not be placed adjacent to, in, or under required tree planting areas, as per ULDR Section 47-21.12. Confirm with civil, site and life safety plans that utilities and site amenities are not causing conflicts with proposed landscaping. Where conflicts exist, shift the utility and/or site amenities.

GENERAL COMMENTS

The following comments are for informational purposes.

Please consider the following prior to submittal for Building Permit:

1. A separate sub-permit application for Tree Removal, Relocation, and General Landscaping for site is required at time of master permit submittal. These are Landscape and Tree permit application documents different than the Broward County standard applications. Please not this at time of submittal.



2. Proposed landscaping work in the City's right of way requires engineering permit and approval (Landscape permit). This approval requires documents to be submitted for Engineering review. Note that Landscape will not approve permit review without these Engineering documents being submitted.
3. Provide separate Plumbing sub permit application for irrigation. Irrigation plans are required at time of Building permit submittal. Plans are to be in compliance with ULDR 47-21.6.A.11 and 47-21.10. Note that planting areas are to be irrigated on a separate zone than the turf areas so that once the plants are established, that particular zone can be shut off based on the season. The overall goal is to decrease water use through irrigation. Plant material must be grouped together based on watering needs (hydrozone) and turf areas must be limited and/or consolidated to less than 50% of the landscaped area. Illustrate hydrozones on planting plan, and include calculations in table.



Case Number: R19047

CASE COMMENTS:

Please provide a response to the following:

1. Unit entry doors should be solid, impact resistant or metal and should be equipped with a 180 degree view peephole.
2. Unit entry doors should have a secondary deadbolt locking system.
3. All glazing should be impact resistant.
4. Each hotel room should have a safe for guest to secure valuables.
5. Stairs should be Egress-Only at the ground floor to avoid unauthorized intrusion.
6. There should be a system to track any individual access into each hotel room. (Guest, housekeeping or service calls).
7. The pool area should be equipped with a child proof access control feature to prevent unsupervised children access to the pool.
8. A CCTV system should be employed throughout the property with focus on entry / exit points, elevators, Parking garage, hallways and common areas. It should be capable of retrieving an identifiable image of a person.
9. Emergency communication devices should be placed in the parking garage and common areas. These should be easily identifiable and accessible.
10. Light reflecting paint should be used in the parking garage to increase visibility and safety.
11. All restricted areas and guest only areas should be access controlled and label as such.
12. Valet key room and luggage storage areas should be access controlled.
13. There should be a secured valet key management system for the vehicles on site.
14. Office doors and common area doors should be lockable from the inside to provide safe shelter in the case of an active threat such as an active killer event.
15. Elevators should be access controlled.
16. All lighting and landscape should follow C.P.T.E.D. guidelines.

GENERAL COMMENTS

It is highly recommended that the managing company make arrangements for private security during construction.

Please submit responses in writing prior to DRC sign off.



Case Number: R19047

CASE COMMENTS:

Please provide a response to the following:

1. Garbage, Recycling and Bulk Trash shall be provided.
2. Recycling reduces the amount of trash your business creates and it is the best way to reduce monthly waste disposal costs and improve your company's bottom line.
3. Solid Waste Services shall be provided by a Private Contractor licensed by the City.
4. Service Days shall be: No restriction for Commercial collection. Service may not occur earlier than 7:00 am or later than 10:00 pm within 250 feet of residential.
5. Solid Waste Collection shall be on private property container shall not be placed, stored or block the public street to perform service (large multifamily and commercial parcels).
6. Containers: must comply with 47-19.4
7. Draw equipment on plan to show it will fit in trash room.
8. Solid Waste transport to trash rooms or to primary waste container shall be performed inside building using interior service corridor (Retail, Office, Condo, Hotel).
9. Provide letter from chute company indicating make and model of proposed equipment and that it will meet the capacity needs of building.
10. Trash Room services will be handled by private collector, or Trash Room services will be done by on site personnel, or Trash Room services will be done by custodial staff.
11. Provide on the site plan a garbage truck turning radii for City review. Indicate how truck will circulate within property.
12. Submit a Solid Waste Management Plan on your letterhead containing name of project, address, DRC case number, number of units if applicable, and indicate whether it is Pre or Final DRC.
 - o This letter is to be approved and signed off by the Sustainability Division, and should be attached to your drawings. Please email an electronic copy to smccutcheon@fortlauderdale.gov. Letter should include an analysis of the expected amounts of solid waste and recyclables that will be generated (if different from current capacity), and container requirements to meet proposed capacity.
 - o Community Inspections will reference this Solid Waste Plan for sanitation compliance issues at this location.

General Comments

The following comments are for informational purposes.

Please consider the following prior to submittal for Final DRC:

1. None



Case Number: R19047

CASE COMMENTS:

1. Submit a traffic impact statement and coordinate with the Transportation and Mobility Department regarding traffic calming and a traffic impact study if needed. If a traffic study is needed Pursuant to 47-25.2.M.4. Applicant must fund City's review by consultant and pay a \$4,000 deposit prior to scheduling a methodology meeting after which the study will be prepared, transmitted and reviewed by the City's consultant. Staff and consultant's review concerns shall be adequately resolved prior to gaining authorization for either the Planning & Zoning Board or City Commission hearings. Take into consideration that the review of this study, once submitted, will take about 4-6 weeks once all documents are received.
2. How many guest rooms are being proposed? The parking data table number of lodging units does not match the number of guest room units in the guest room matrix. Update the tables as necessary.
3. All loading and unloading must be contained on site including postal delivery services and rideshare pick up and drop off.
4. Show inbound and outbound stacking requirements from the property line to the first conflict point according to sec 47-20.5 General design of parking facilities for each driveway.
5. If valet parking being proposed: For information on the required vehicular reservoir requirement for valet parking, please look at the section in our city code listed below:
 - a. Sec. 47-20.17. - Vehicular reservoir spaces for drive-thru facilities. Valet parking facilities, 50 spaces or more are required to have a minimum 6 vehicular reservoir spaces.
 - b. A vehicular reservoir space ("VRS") is a space within a vehicular use area for the temporary stopping of a vehicle awaiting service as provided in this section. A VRS shall be twenty (20) feet long by ten (10) feet wide. A VRS shall be located in an area within a parking facility which is not used for any other vehicular use such as access, parking, site circulation or loading.
 - c. Each VRS shall be clearly defined on the site plan and shall be in a location that does not conflict or interfere with other traffic entering, using or leaving the site. Design configuration shall be such that there shall be no backing into the street permitted.
 - d. Reservoir spaces shall be measured from the front of the service position to the rear of the VRS.
6. Per ULDR Section 47-2.2.Q, show and label sight triangles as appropriate for safe and adequate access of drivers and pedestrians, on the Site Plan, Landscape Plans, and Civil Plans: intersections of driveways with streets and alleys (10' measured from intersection point of pavement edges), alleys with alleys (15' measured from intersection point of extended property lines), alleys with streets (15' measured from intersection point of extended property lines), and streets with streets (25' measured from intersection point of extended property lines). The request for reduction of sight triangle dimensions is subject to review by the City Engineer on a case-by-case basis. Per ULDR Section 47-19.1.E, no accessory use or structure shall be permitted within a sight triangle except as provided in ULDR Section 47-35.
7. Ensure all access points, sidewalks, walkways, and curb cuts are unobstructed and ADA accessible with appropriate slopes and detectible warning devices and indicate on the site plan.



8. Additional comments may be provided upon further review.
9. Signature required.

GENERAL COMMENTS:

Please address comments below where applicable.

1. Contact Benjamin Restrepo at 954-828-5216 or brestrepo@fortlauderdale.gov to set up an appointment for final plan approval.
2. The City's Transportation & Mobility Department encourages the use of sustainable materials such as permeable pavement and electric car charge stations and installation of multimodal facilities such as bicycle pump stations and bike lockers.
3. Please note that any work within the City's right-of-way will require an MOT approved by Transportation and Mobility and Engineering for permitting. Any full closures of roadways, alleys, or sidewalks that are over 72 hours will require a Revocable License Agreement (RLA) with the City of Fort Lauderdale.



Case Number: R19047

CASE COMMENTS:

Please provide a response to the following:

- 1) The applicant is strongly encouraged to contact neighbors adjacent to, as well as condominium and neighborhood associations located within three hundred feet (300') of the development site, to advise of this proposal. A listing of officially-recognized associations is provided on the City's website: www.fortlauderdale.gov/neighbors/civic-associations and a map of neighborhood associations may be found at: <http://gis.fortlauderdale.gov>. Please provide acknowledgement and/or documentation of any public outreach.
- 2) The site is designated Commercial on the City's Future Land Use Map. The proposed use is permitted in this designation. This is not a determination on consistency with Comprehensive Plan Goals, Objectives and Policies.
- 3) Verify that copy of plat is the most current recorded plat, including notes and amendments, for the proposed site. Provide documentation from the Broward County Planning Council verifying that the site does not require platting or replatting. If replatting or platting is not required, contact the Development Review Services Section of the Planning and Environmental Regulation Division of Broward County at (954) 357-6637 to ensure that proposed project is consistent with the latest recorded plat restriction.
- 4) Indicate the project's compliance with the following ULDR sections by providing a point-by-point narrative response, on letterhead, with date and author indicated.
 - a. Sec. 47-23.9, Interdistrict Corridor requirements
- 5) Provide the following changes on site plan:
 - a. Consider providing the porte-cochere on the south side of the hotel to improve guest circulation.
 - b. Consider providing covered walkway from parking garage to hotel at the ground floor level.
 - c. Indicate all adjacent building footprints, indicating their uses and heights, and dimension approximate setbacks.
 - d. Indicate all utilities (both above and below ground) that would affect the proposed planting or landscape plan. Overhead lines (if any) should be placed underground. If the lines cannot be placed underground, provide documentation from Florida Power & Light Company indicating such.
 - e. Provide location of trash receptacles or dumpsters; discuss location with solid waste and recycling representative. Show typical trash container dimensions and location for each unit.
 - f. Clearly label on site plan the location of enclosure(s), dumpster(s), recycling area(s), containers, etc. as applicable relating to Solid Waste / Recycling. Indicate on plans where users' accessibility is accommodated for all container areas
- 6) Applicant shall provide additional screening within the garage to shield interior garage lighting and install a solid surface along the west elevation to screen vehicular lights facing the waterway. Provide information on garage ventilation system.
- 7) Provide legible photometric plan for the entire site. Extend values on photometric plans to all property lines. Show values pursuant to the Unified and Land Development Regulations ("ULDR"), Section 47-25.3.A.3.a and 47-20.14. Indicate lighting poles on site plan and landscape plan, and provide detail with dimensions. Garage internal lighting fixtures and glare cannot be visible from neighboring properties.

- 8) Provide the following changes on elevations:
 - a. Provide a variety of materials on all facades.
 - b. Provide additional articulation on the east façade facing Federal Highway.
- 9) Discuss Fire access lane at southern portion of site. If this is not required by Fire, please remove this egress.
- 10) Pursuant to 47-23.9, Interdistrict corridor requirements, the following shall be permitted within the twenty-foot yard:
 - a. Landscaping;
 - b. Outdoor dining;
 - c. Enhanced pedestrian amenities such as, but not limited to: plazas, benches, shade structures, pedestrian access, bus shelters, bicycle racks, multi-modal pathways.
- 11) Discuss all newly proposed seawalls, any repair to existing seawalls and/or re-location of existing seawalls with Engineering Design Manager.
- 12) Provide renderings which accurately match the proposed site plan.
- 13) The City's Vision is to support sustainable infrastructure. Consider employing green building practices throughout the project such as, but not limited to; charging stations, tank-less water heaters, rain collection systems, pervious pavement where appropriate, bio-swales, Florida Friendly™ plant materials, solar panels and green roofs
- 14) It is recommended the following pedestrian and bicycle-related comments be addressed:
 - a. Provide bicycle parking for visitors in visible, well-lit areas as close as possible to pedestrian entryways/doors. Where possible, locate bicycle parking in an area that is sheltered/covered;
 - b. Provide bicycle storage lockers for residents, preferably in a room with natural light; and,
 - c. Consult the Association of Pedestrian and Bicycle Professionals ("APBP") for Bicycle Parking Guidelines and Broward County End-of-Trip Bicycle Facilities Guide at <http://www.apbp.org/>. For more information on bicycle parking standards, please email Ben Restrepo at brestrepo@fortlauderdale.gov.

GENERAL COMMENTS

The following comments are for informational purposes.

- 1) Provide a written response to all DRC comments within 180 days.
- 2) An additional follow-up coordination meeting may be required to review project changes necessitated by the DRC comments. Prior to routing your plans for Final DRC sign-off, please schedule an appointment with the project planner (call 954-828-6495) to review project revisions and/or to obtain a signature routing stamp. Please note applicant is responsible for obtaining signatures from all discipline members that had comments and may need to resolve comments through individual appointments if necessary.
- 3) If a temporary construction/sales trailer is needed for this project, provide the details and location of the trailer on an additional site plan, to avoid additional review in the future. Ensure details and locations receive approval from the Building Service Department's DRC Representative.
- 4) Additional comments may be forthcoming at the DRC meeting.

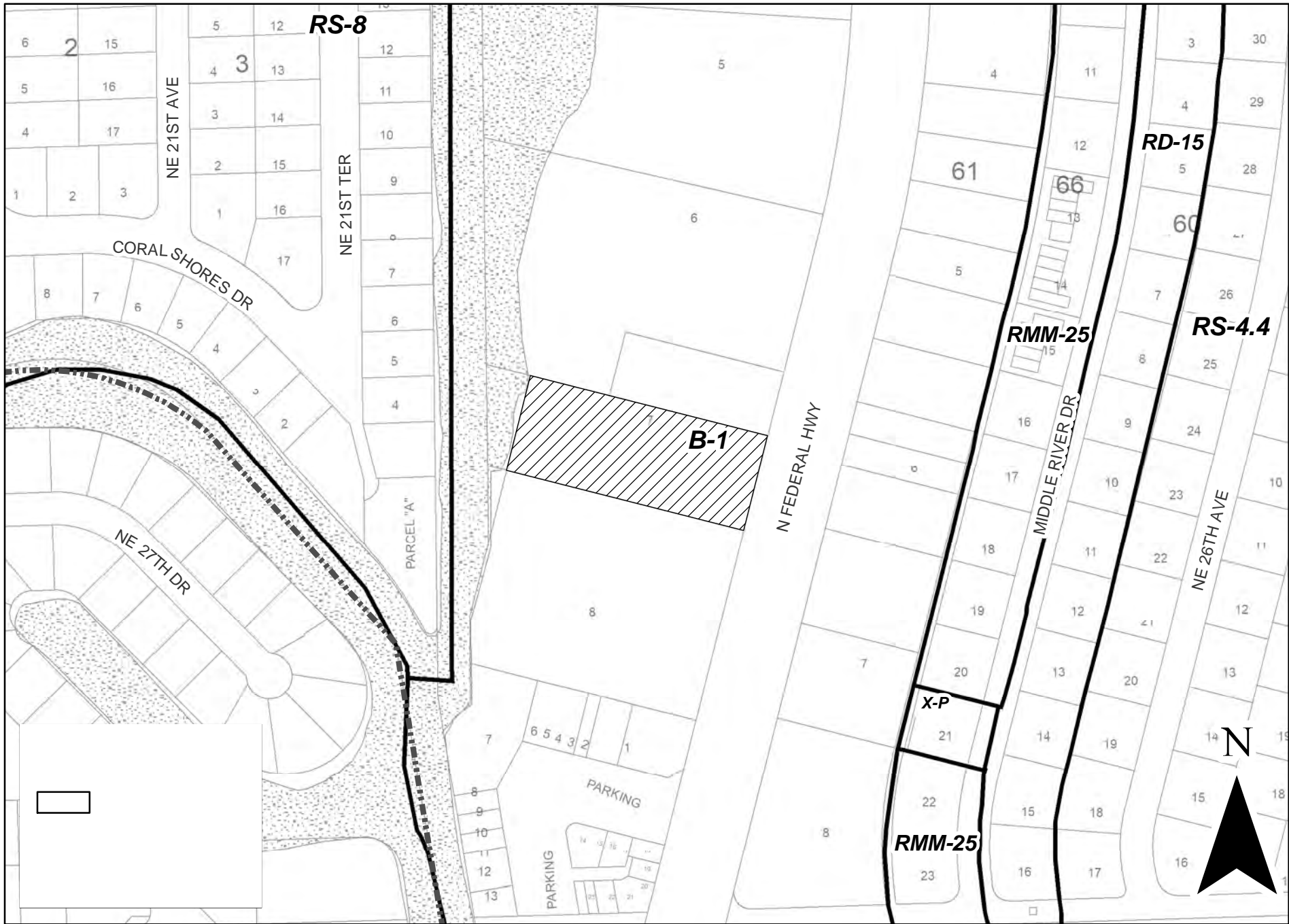

R19047

