



DEVELOPMENT REVIEW COMMITTEE (DRC) COMMENT REPORT

MEETING DATE: November 12, 2019

**APPLICANT /
PROPERTY OWNER:** 1771 E Sunrise, LLC.

AGENT: Lowndes, Drosdick, Doster, Kantor & Reed, P.A.

PROJECT NAME: MedMen - Sunrise

CASE NUMBER: PLN-SITE-19100008

REQUEST: Site Plan Level III Review: Conditional Use for Medical Cannabis Dispensing Facility

LOCATION: 1771 E Sunrise Boulevard

ZONING: Boulevard Business (B-1)

LAND USE: Commercial

CASE PLANNER: Karlanne Grant



Case Number: PLN-SITE-19100008

CASE COMMENTS:

- 1) Provide the FBC Building Type (Chapter 6) Designation on the plans.
- 2) Designate dimensional detail required for ADA and Life Safety Egress.
- 3) Detail Accessible travel in the Building and On- Site.

GENERAL COMMENTS

The following comments are for informational purposes.

Please consider the following prior to submittal for Final DRC:

1. The Florida Building Code shall apply to the construction, alteration, movement, enlargement, replacement, repair, equipment, use and occupancy, location, maintenance, removal and demolition of every building or structure or any appurtenances connected or attached to such buildings or structures.
2. All projects must consider safeguards during the construction process. Florida Building Code Chapter 33 delineates various safeguards that may apply during the construction phase. All structures associated with the protection of pedestrians will require a separate permit. A licensed professional must sign and seal the plans and specifications.
3. The City of Fort Lauderdale is a participating municipality in the National Flood Insurance Program (NFIP). The requirements specific to the City of Fort Lauderdale can be found in

Chapter 14 - FLOODPLAIN MANAGEMENT of the Code of Ordinances and accessed at;

a. https://www.municode.com/library/fl/fort_lauderdale/codes/code_of_ordinances?nodeId=COOR_CH14FLMA

Please consider the following prior to submittal for Building Permit:

1. On January 1st, 2018 the 6th Edition of the Florida Building Code was adopted. All work described in Section 101.2, of the Broward County Administrative portion of the Florida Building Code, will govern the administration and enforcement of the proposed work. Each building and or structure will require a separate permit. The following websites will assist in the design considerations:
 - a. <http://www.fortlauderdale.gov/departments/sustainable-development/building-services>
 - b. https://floridabuilding.org/bc/bc_default.aspx
 - c. <http://www.broward.org/codeappeals/pages/default.aspx>

General Guidelines Checklist is available upon request.



Case Number: PLN-SITE-19100008

CASE COMMENTS:

Prior to Planning and Zoning Board Meeting sign-off, please provide updated plans and written response to the following review comments:

1. Meet the City's Adequacy requirements to services provided to the public (fire service, water, wastewater, stormwater, transportation, etc.), per **ULDR Section 47-25.2** of the City's Code of Ordinances. Assess potential demands and impacts on City services and prepare a design for each that utilizes existing water, wastewater, stormwater, and transportation infrastructure to adequately serve this project. If the adequate infrastructure is not available, prepare a design that extends/expands the connection to the nearest City system to adequately serve this development.
 - a. Prepare service demand calculations for water & wastewater services and obtain a letter of service availability from the City's Public Works – Engineering Department. Submit water and wastewater capacity availability request form and documents/ plans at <https://www.fortlauderdale.gov/departments/sustainable-development/building-services/engineering-forms-and-info/development-review-committee-service-demand-calculations-for-water-se>
2. Provide disposition of existing utilities on-site and within the adjacent right of way that maybe impacted by the proposed development. Label information on plans (i.e. utility to remain/ be relocated/ removed). Provide correspondence from utility owner (as applicable) and depict any additional requirements they may have on plan (i.e. easements). Utilities include but are not limited to above and underground water, sewer, drainage, electrical, communications, light/power poles, down guys, fire hydrants, manholes, etc.
3. Proposed required on-site improvements, such as proposed pylon sign, shall not be constructed within existing or proposed right of way/ dedications/ easements. If encroachments are proposed, provide correspondence from FDOT indicating the same is allowed
4. Spot elevations/grades shown in proposed development plans shall be per North American Vertical Datum of 1988 (NAVD 88), instead of National Geodetic Vertical Datum of 1929 (NGVD 29).
5. Clearly indicate on plans the limits of construction and how the proposed improvements will transition into the existing (on-site and off-site) as applicable.
6. Depict/ label existing/ proposed stop sign/ bar on right of way adjacent to the site and on driveway connections to right of way as applicable.
7. Provide disposition of existing light poles, fire hydrants, and any other utilities within the adjacent right of way that maybe impacted by the proposed development.
8. Provide disposition of existing power pole and down guys located along N. Victoria Park Road that encroach within the proposed development, including possible conflict with required vertical clearance above public and private access sidewalks.
9. Per ULDR Section 47-2.2.Q, show and label sight triangles as appropriate for safe and adequate access of drivers and pedestrians, on the Site Plan, Landscape Plans, and Civil Plans: intersections of



driveways with streets and alleys (10' measured from intersection point of pavement edges), alleys with alleys (15' measured from intersection point of extended property lines), alleys with streets (15' measured from intersection point of extended property lines), and streets with streets (25' measured from intersection point of extended property lines). The request for reduction of sight triangle dimensions is subject to review by the City Engineer on a case-by-case basis. Per ULDR Section 47-19.1.E, no accessory use or structure shall be permitted within a sight triangle except as provided in [ULDR Section 47-35](#).

10. Building Elevations: Show and label existing Right-of-Way, proposed Right-of-Way and/or Easement boundaries, existing/ proposed utility easements and horizontal building clearances on all building elevation / section details, as appropriate.
11. Per ULDR Section 47-19.4.D.6, all dumpster enclosures and adjacent service access drive shall be placed on poured concrete, solid or perforated interlocking concrete block paving (ICB), or any existing hardened paving system.
12. Clearly depict trash enclosure on site plan. Show truck turning movements in and out the proposed dumpster enclosure as applicable.
13. Provide and label typical roadway cross-sections for the proposed development side of State Road 838 / W Sunrise Boulevard, and N. Victoria Park Road: at driveway access points, and at landscape swale areas (i.e. between travel lane and sidewalk) as appropriate.
14. Existing public sidewalks adjacent to proposed development (to remain) must be inspected by Engineer of Record to ensure existing sidewalks meet ADA standards and are in good condition. A signed and sealed assessment must be provided indicating sidewalks were inspected and any sidewalk replacement requirements. Plans shall reflect extent of sidewalk replacement accordingly.
15. Depict existing sidewalk adjacent to the development along N. Victoria Park Road and how proposed sidewalk/ pedestrian path will transition into existing sidewalk.
16. Continue concrete sidewalk across driveway access point; design driveway tie-in per the City's Driveway Plan Detail Sheets (Right-of-Way), available online at <http://www.fortlauderdale.gov/home/showdocument?id=1524>.
17. Label on Site Plan Data Table the required and proposed type of loading zone(s) required, per ULDR Section 47-20.2 Table 2 and Section 47-20.6; also label location of ADA van-accessible parking stalls. If applicable, show truck turning template circulation (label typical minimum centerline turning radius) entering and exiting the site as required for the proposed development. Turning geometries and loading zone design shall be in accordance with ULDR Section 47-20.6.
18. Provide conceptual Water and Sewer Plan that features proposed connections to City infrastructure, including limits of any existing City water main and/or sanitary sewer infrastructure to be removed and/or modified, and location of all existing utilities in vicinity of the proposed improvements (that may be in conflict). Additional comments/ requirements maybe forthcoming from Public Works water and wastewater service availability review.
19. Label proposed water service connections and sewer lateral sizes and material on conceptual Water and Sewer Plan. Sanitary sewer clean out must be provided at property line per City standards. Based on the City utility maps, the existing sewer main adjacent to this property is at a deeper elevation than assumed, verify elevations accordingly. Also provide disposition of existing services (i.e. water services and sewer laterals).

20. Any road cuts for utilities or curb cuts within City Right-of-Way shall be restored to full lane width for 50' minimum length (by contractor), per City Code of Ordinances Section 25-108; show and label in plans as appropriate. Verify with FDOT and/or BCHCED their requirements for any milling and asphalt pavement restoration in vicinity of proposed road cuts for utilities and/or curb cuts within their respective Right-of-Way jurisdictions.
21. Provide sufficient existing and proposed grades and information on conceptual Paving, Grading, and Drainage Plan and details to demonstrate how stormwater runoff will remain onsite ((include typical cross-sections along all property lines as appropriate, typical lot grading for the proposed single family homes within the development, and depict how the new stormwater system will connect to the existing on-site drainage system)), and how the proposed project improvements (i.e. on-street parking, sidewalks, etc.) will not adversely impact the adjacent Right-of-Way, properties and waterways. Drainage mitigation shall be required for any impacts within the adjacent City Right-of-Way such as increased runoff or reduction of existing storage/treatment due to proposed improvements, in accordance with the City of Fort Lauderdale Comprehensive Plan (Ordinance C-15-08), Objective 4.1 under Infrastructure Elements. Applicant shall be responsible for maintenance of these proposed storm drain infrastructure improvements located within City Right-of-Way during a 1-year warranty period, until accepted by the City's Public Works Department.
(include review comment if Civil Plans not provided)
22. Depict proposed building doors and provide sufficient grades/details on conceptual paving, grading and drainage plans to verify ADA accessibility design for the site, especially ground floor access to the new building, as well as crossing proposed driveways and connecting to existing sidewalks (at intersections and with adjacent property) as appropriate; coordinate proposed site grading and 1st Level Finished Floor Elevations to meet ADA accessibility requirements.
23. Provide storm runoff calculations, signed and sealed by a Florida registered professional engineer, which demonstrate how minimum criteria regarding adjacent street crown, water quality and finished floor elevations are met, as well as how the 25-year, 3-day storm event is maintained on site with zero discharge to Right-of-Way and adjacent properties (Pre vs. Post analysis will only be allowed in areas that are not flood-prone). Please also comply with the City of Fort Lauderdale Comprehensive Plan (Ordinance C-08-18), Objective 4.1 under Infrastructure Elements, and be advised that effective 7/1/2017, all projects must comply with the Broward County 'Future Conditions Average Wet Season Groundwater Level' map.

Drainage mitigation is required for any impacts within adjacent City of Fort Lauderdale Right-of-Way, such as increased runoff, additional impervious areas, and reduction of existing storage or treatment (i.e. swale areas). Engineer of Record (EOR) shall evaluate the adjacent City roadway system capacity and demonstrate that the proposed improvements will not negatively impact the City's existing drainage system, and provide recommendations in compliance with the City's Comprehensive Plan (i.e. meets or exceeds the 10-year/1-day storm event drainage criteria).

24. Exfiltration Trenches:
 - a. Provide at least a clean out structure at each end of exfiltration trench located within the property.
25. Contact the Floodplain Manager, Richard Benton at 954-828-6133 or rbenton@fortlauderdale.gov regarding proposed Finished Floor elevation and fill requirements per City's Code of Ordinances Chapter 14 – Floodplain Management, including Ordinance C-14-26. Especially where proposed elevations appear to be over 2' higher than existing ground. Provide correspondence and depict information on plans accordingly.



26. Coordinate with Public Works (Utilities Distribution and Collection Division) for any connections to and/or demolition of existing City infrastructure along N. Victoria Park Road. Any new trees (located within or adjacent to City Right-of-Way) should be placed with sufficient horizontal and vertical distances (per City, County, and State guidelines) to / from City's public infrastructure, including stormwater assets, to allow for continued Public Works maintenance without obstruction. If this cannot be accommodated due to field conditions, then the developer shall relocate the existing City's public infrastructure to resolve the conflict(s) and to comply with City's, County's & State's engineering standards/permits/policies.
 - a. For Storm Drainage, contact Elkin Diaz at 954-828-6539 or ediaz@fortlauderdale.gov.
 - b. For Sanitary Sewer, contact Steve Roberts, Jr. at 954-828-7855 or srobertsjr@fortlauderdale.gov. Per ULDR Section 47-19.4.D.7, dumpsters serving restaurants require grease traps, oil / sand separators, and drains connecting to sanitary sewer.
 - c. For Water Distribution, contact Keith Hutchison at 954-828-7682 or khutchison@fortlauderdale.gov. Public Works Operations does not allow 90 degree bends within the City's Right-of-Way.
 - d. For City Utility Atlas Maps, GIS, and as-built information, to help accurately plot and label utilities in the vicinity of proposed work, contact Craig Barrett at 954-828-5875 or crbarrett@fortlauderdale.gov.
 - e. Provide written correspondence between the Public Works (Utilities Distribution and Collection Division) and the Engineer of Record. When attaching plans on correspondence to the above contacts, please make sure only applicable sheets are included and proposed services/ connections are highlighted accordingly to assist on their review.
27. Show and label all existing and proposed utilities (utility type, material and size) on civil and landscaping plans for potential conflict. A min. 5 feet and 10 feet horizontal clearance horizontal separation is required between city utilities infrastructure and proposed small and large trees, respectively (including proposed water and sewer services to the development). Any new trees (located within or adjacent to City Right-of-Way) should be placed with sufficient horizontal and vertical distances (per City, County, and State guidelines) to / from City's public infrastructure, including stormwater assets, to allow for continued Public Works maintenance without obstruction. If this cannot be accommodated due to field conditions, then the developer shall relocate the existing City's public infrastructure to resolve the conflict(s) and to comply with City's, County's & State's engineering standards/permits/policies. Ensure separation is provided and include a note regarding horizontal clearance requirement on the landscape plans.
28. Proposed trees shall be installed a min. 4 feet behind proposed curbs when adjacent to travel lanes and a min. 6 feet away from adjacent travel lanes when no curb is present.
29. Discuss how surface runoff from the proposed development (between building and Right-of-Way boundaries) will be mitigated such that it won't be conveyed into the adjacent existing public storm drain infrastructure or waterways, and whether additional infrastructure will be required within City Right-of-Way (coordinate as appropriate with the respective FDOT and BCHCED agencies for mitigation of additional runoff within those jurisdictions). Show location of building roof drains, and their proposed connection(s) to the on-site drainage system
30. Within adjacent City Right-of-Way, staging/storage will not be allowed, construction fence shall not encroach within intersection corner sight triangles, construction fence gates shall not swing into the public Right-of-Way, and any loaded Jib Crane radius shall not extend beyond private property boundaries. Any City Right-of-Way closure over 72 hours requires a Revocable License Agreement, processed by Property Right-Of-Way Committee (DRC) and approved by the City's Commission,



prior to Right-of-Way permit issuance by the Department of Sustainable Development for Maintenance of Traffic.

Prior to submitting Administrative Review (i.e. DRC Level I) application to request Revocable License Agreement, please contact Dennis Girisgen at 954-828-5123 or dgrisgen@fortlauderdale.gov to discuss proposed scope of closure within City Right-of-Way.

31. Provide Maintenance Agreement Area Exhibit, which provides a visual representation of the area within the adjacent public Right-of-Way (adjacent to the proposed development) to be maintained in perpetuity by the developer. Label whether the adjacent Right-of-Way is FDOT, BCHCED, or City jurisdiction, as well as label all proposed improvements, including asphalt and other specialty paving, specialty sidewalks, landscaping, irrigation, lighting, curb and gutter etc. that will be maintained by the Applicant throughout the life of the improvements. Perpetual maintenance of newly constructed exfiltration trenches, inlets, etc. within adjacent City Right-of-Way will typically revert back to the City, upon successful inspection/acceptance by Public Works after 1-year warranty period.
32. For Engineering General Advisory DRC Information, please visit our website at <https://www.fortlauderdale.gov/home/showdocument?id=30249>
33. Additional comments may be forthcoming at the DRC meeting and once additional/ revised information is provided on plans.



Case Number: PLN-SITE-19100008

CASE COMMENTS:

Please provide a response to the following:

1. The City has adopted Florida Friendly Landscaping requirements into our ULDR Section 47-21. This basically means that plant material must be grouped together based on watering needs (hydro zone) and turf areas must be limited and/or consolidated to less than 50% of the landscaped area. Plant material species must be minimum 50% Florida Friendly Landscaping. Planting areas are to be irrigated on a separate zone than the turf areas so that once the plants are established, that particular zone can be shut off based on the season. The overall goal is to decrease water use through irrigation. Illustrate hydro zones on planting plan and include calculations in table.
2. The use of structural soil is required in paved sites to provide adequate soil volumes for tree roots under pavements, as per ULDR Section 47-21.13. Structural soil details and specifications can be obtained at <http://www.hort.cornell.edu/uhi/outreach/index.htm#soil> This is to be provided at a minimum of 8' radii of tree trunks, and is to be consistently illustrated and noted on landscape, site and civil plans.

The structural soil drain is required when percolation rates are less than 4" vertical clearance per hour. Provide documentation of report used to prove this calculation. The drain and connections are to be illustrated on civil plans.

- a. Demonstrate hashing on landscape, site and civil plans as to the extent of use of the Structural Soil.
 - b. Provide Structural Soil Detail and composition.
3. There is a product that the Landscape Department will approve the use of in place of Structural soil. With the Structural soil repositioning of the underground utilities is required. A suspension modular paving system product will provide the required root development area for a healthy and vibrant tree, along with their use it will allow the utilities to be in place and not affect their location in conjunction with the tree's root system. Please look into the use of the Green Blue Urban soil cell, Silva cell or like product for this and all future site developments. As with the use of Structural soil a detail of the product and indication of the extent of use to be provided of the soil cell pavement support systems product.
 4. Utilities and site amenities such as walkways, flagpoles, transformers, fire hydrants, sewer and water supply lines, trash enclosures, and similar items located on the site shall not be placed adjacent to, in, or under required tree planting areas, as per ULDR Section 47-21.12. Confirm with civil, site and life safety plans that utilities and site amenities are not causing conflicts with proposed landscaping. Where conflicts exist, shift the utility and/or site amenities.
 5. A minimum separation of 6 feet is required between the tree trunk and travel lane when curb and gutter DO NOT exist, and a minimum separation of 4 feet is required between the tree trunk and travel lane when curb and gutter DO exist. Illustrate this clearance.
 6. Provide street trees in the right of way swale area, as per ULDR 47-21.13.B.16. Street trees are to be a minimum of 12 feet tall and provided at a ratio of one street tree per forty feet of street frontage or greater fraction thereof not subtracting ingress and egress dimensions. When overhead utilities exist,



required street trees may be small trees provided at ratio of one street tree per twenty feet frontage or greater fraction thereof not subtracting ingress and egress dimensions.

- a. Please propose sidewalk along N. Victoria Park RD. at the minimum width of 5 feet and the backside of the sidewalk to the property line. Trees may be within the sight triangle area providing that the tree has a minimum 8 feet canopy clearance.
 - b. Site plan indicates 8 feet wide swale on N. Victoria Park RD. If there is 8 feet from the edge of the street to the street side edge of the sidewalk, small maturing trees are to be proposed if less than, please propose palm trees that are suitable with the overhead power lines. If needed thin trunked palm trees may be located 3 feet from the travel lane at least 1 foot from the sidewalk. If palm trees need to be proposed, please cluster them with 3 single canes at staggered heights.
 - c. Street trees along E. Sunrise BLVD. please propose a thin trunked maturing shade tree such as Bridalveil trees on 30 feet centers. Please proposed the trees at with a canopy clearance of 8 feet for sight triangle requirements. Please correspond early with FDOT as to the Sunrise BLVD. street trees, approval from FDOT will be required prior to city permit approval. Tree canopy within a sight triangle requires a clearance of 8 feet. Please maintain tree canopy 60% to tree clear trunk 40% ratio heights adjust overall height of trees in sight triangles.
 - d. In this site's proposed development configuration, it appears that additional trees may be proposed on the property side of the sidewalk on E Sunrise BLVD. Please investigate proposing additional trees for shade purposes of the public realm.
 - e. Being that larger type of tree is asked to be proposed as street trees along E. Sunrise BLVD. Please propose the use of Structural Soil or like product adjacent to the trees under the paved areas.
7. Approval from jurisdiction for landscape installation in Right Of Way, preferred prior to final DRC sign off. If jurisdiction approval is obtained after DRC final sign off and the plans require any change, Administrative Review will be required prior to permit review.
8. Provide an existing tree site plan or existing tree site survey illustrating all existing trees and palms, and number each one.
9. Provide a corresponding list, as per ULDR 47-21.15, of these trees/palms including:
- a. tree number for each
 - b. botanical name and common name for each
 - c. trunk diameter, in inches, at chest height for trees
 - d. clear trunk in feet for palms
 - e. condition percentage as a number for each
 - f. indicate status for all existing trees/palms on site (remain, relocate, remove)
10. Please have a certified ISA Arborist provide the information as to the existing trees including the condition ratings that will be required for mitigation purposes.
11. Illustrate and label the horizontal clearance from tree trunk to edge of utility on the landscape plan. Landscaping must provide a minimum horizontal clearance of 5 feet for small trees and palms, and a minimum of 10 feet for large trees and palms from underground utilities. Provide a cross section detail to illustrate this clearance.
- a. Please illustrate all off site utilizes on landscape plan.
12. Site is required to be in compliance with today's updated code including but not limited to vehicle use landscape buffer yards. Section 47-21.12.A.2.a and b. Perimeter landscape area.



- a. Along the perimeter of a parcel of land which abuts a street, exclusive of vehicular access points, a perimeter landscape area shall be provided. The depth of the perimeter landscape area shall be a minimum of five (5) feet, a maximum of twenty-eight (28) feet, and an average of ten (10) feet. The ten (10) feet of perimeter landscape area closest to the VUA may be counted as part of the twenty percent (20%) minimum VUA landscape requirement.
 - b. Along the perimeter of a parcel of land which does not abut a street the minimum depth of the landscape area shall be two and one-half (2½) feet. Parcels of land with less than one hundred-foot front width may provide a perimeter masonry wall at least thirty (30) inches in height between the VUA and the abutting property in lieu of the perimeter landscape area.
 - c. During case meeting it was mentioned that shifting the building to the SW corner of the site and being that the VUA is no longer adjacent to the ROW there would be no 10 feet buffer requirement. The VUA being shifted adjacent to the east property, the the VUA would only require a 2.5 feet landscape buffer area to the adjoining east property possibly freeing up some site area.
13. Section 47-25.3.A.b.i. and 47-25.3.A.b.iv.b. *Bufferyard requirements*. Excluding parks, open space and conservation areas, when a use which is subject to the requirements of this [Sec. 47-25.3](#) is contiguous to any residential property, the property where the use is located shall be required to have a landscaped strip area and a physical barrier between it and the residential property. Such landscape strip shall meet the following requirements:
- i. Landscape strip requirements. A ten (10) foot landscape strip shall be required to be located along all property lines which are adjacent to residential property. Such landscape strip shall include trees, shrubs and ground cover as provided in the landscape provisions of Section 47-21, Landscape and Tree Preservation Requirements. The width of the landscape area shall extend to the property line. All required landscaping shall be protected from vehicular encroachment. When walls are required on nonresidential property abutting an alley, required shrubbery shall be installed and located within the landscape area on the exterior of the wall.
 - iv. Wall requirements. A wall shall be required on the nonresidential property, a minimum of five (5) feet in height, constructed in accordance with Section 47-19.5 and subject to the following:
 - b. Shall be located within, and along the length of the property line which abuts the residential property,
 - a. The Vehicle Use Area is required to provide the 10 feet landscape buffer yard and the entire length of the north side is required to have a buffer wall.
 - b. Due to the existing trees along the north property line. Please demonstrate how the wall will be constructed without damage to the trees and placing them into a violation of city ordinance of tree abuse.
14. Section 47-21.12.C.1.a. The first twenty-five percent (25%), or fraction thereof, of the required trees shall be shade species with a three and one-half (3 ½) inch minimum trunk caliper and shall be evenly distributed between interior and perimeter landscape areas.
- a. The Gumbo Limbo trees need to be re-proposed to fulfill this requirement. The Department see that a shift of two of the three Gumbo Limbo trees from the NE corner to the two tree islands on the west side of the building. Please re-compose the Sabal palms in the NE corner to allow the 1 Gumbo Limbo adequate room.
15. Section 47-21.9.G.1. Each tree shall have pervious area surrounding it sufficient to support the species, as determined by the department. The minimum planting area shall be for:
- 1.Shade species with a minimum caliper of three (3) inches, two hundred twenty-five (225) square feet with fifteen (15) feet being the smallest dimension.



a. The 8 feet wide tree islands regarding the shade trees in comment No.12 would require this 15 feet minimum width. In order to maintain the 8 feet tree island width for parking needs and be in compliant with this section. The use of CU Structural Soil or like product; designed for root growth and paved areas, is to be proposed under the pavement adjacent to the tree islands to fulfill this area requirement.

16. Light fixtures with an overall height of more than ten feet shall be located a minimum of 15 feet away from shade trees, as per ULDR Section 47-21.12.
17. Tree and Plant species included on the Florida Exotic Pest Plant Council's Invasive Plant Species List as amended, shall not be planted as required or optional landscaping, as per ULDR Section 47-21.18, and invasive plant species listed shall be removed from the site, as per ULDR Section 47-21.8.I.
 - a. Trees on List No. 1 require no permit, trees on List No. 2 require permit for removal.
18. Provide tree protection barricade detail for existing trees on site to remain, as per ULDR 47-21.15. This barricade must be installed prior to the beginning of proposed work, and a landscape job-check inspection may be scheduled.

GENERAL COMMENTS

The following comments are for informational purposes.

Please consider the following prior to submittal for Building Permit:

1. A separate sub-permit application for Tree Removal, Relocation, and General Landscaping for site is required at time of master permit submittal. These are Landscape and Tree permit application documents different than the Broward County standard applications. Please note this at time of submittal.
2. Relocated trees will be moved by the applicant following the ANSI A 300 standards and guaranteed by the permit holder for one year for trees of less than six inches in caliper and for two years for trees greater than six inches in caliper, as per ULDR 47-21.15. A monetary guarantee of postal money order, certified check or cashier's check may be required to insure compliance with requirements. A tree protection barricade before during and after construction activities may be required to ensure protection of tree or trees. Prep work for relocation requires no permit and should start as soon as possible.
3. Proposed landscaping work in the City's right of way requires engineering permit and approval (GLandscape permit). This approval requires documents to be submitted for Engineering review. Note that Landscape will not approve permit review without these Engineering documents being submitted.
4. Provide separate Plumbing sub permit application for irrigation. Irrigation plans are required at time of Building permit submittal. Plans are to be in compliance with ULDR 47-21.6.A.11 and 47-21.10. Note that planting areas are to be irrigated on a separate zone than the turf areas so that once the plants are established, that particular zone can be shut off based on the season. The overall goal is to decrease water use through irrigation. Plant material must be grouped together based on watering needs (hydrozone) and turf areas must be limited and/or consolidated to less than 50% of the landscaped area. Illustrate hydrozones on planting plan, and include calculations in table.



Case Number: PLN-SITE-19100008

CASE COMMENTS:

Please provide a response to the following:

Noted: An extensive security plan was included with site plan and may address listed comments. Please note the page number when addressing comments.

1. All entry / exit doors should be solid, impact resistant or metal.
2. All entry and exit doors should be equipped with a secondary locking system like door pins, deadbolts or other burglary prevention hardware.
3. Any restricted access door should be labeled as such and equipped with access control features including 180 degrees peepholes or viewports.
4. Maintain a video surveillance system that records continuously 24 hours a day and meets the following criteria: Cameras are fixed in a place that allows for the clear identification of persons and activities in controlled areas of the premises. Controlled areas include grow rooms, processing rooms, storage rooms, disposal rooms or areas, and point-of-sale rooms. Cameras are fixed in entrances and exits to the premises, which shall record from both indoor and outdoor, or ingress and egress, vantage points. Recorded images must clearly and accurately display the time and date. Retain video surveillance recordings for at least 45 days or longer upon the request of a law enforcement agency. Consider parking areas as well.
5. Maintain a fully operational security alarm system that secures all entry points and perimeter windows and is equipped with motion detectors; pressure switches; and duress, panic, and hold-up alarms. The alarm should have battery back-up and or cellular back-up features. Consideration should be given to providing portable "Panic" buttons on site.
6. Ensure that the medical marijuana treatment center's outdoor premises have sufficient lighting from dusk until dawn. All lighting and landscape should follow C.P.T.E.D. guidelines as well.
7. Any safe should be bolted to the floor or affixed in a manner that prevents its removal.
8. Ensure that the indoor premises where dispensing occurs includes a waiting area with sufficient space and seating to accommodate qualified patients and caregivers and at least one private consultation area that is isolated from the waiting area and area where dispensing occurs. A medical marijuana treatment center may not display products or dispense marijuana or marijuana delivery devices in the waiting area. There should be access control strategies to prevent public access to restricted areas. This could be addressed by doors or other physical barriers and appropriate signage.
9. All back doors to the site should be equipped with a 180 degree viewport or peephole that allows employees to identify individuals attempting to access the business.
10. The waste container enclosure should be access controlled to avoid unrestricted access issues.
11. All Cannabis products should be kept in a secured, locked room or a vault and be inaccessible except when dispensing.
12. Any common walls between adjacent businesses should be reinforced to prevent a security breach through the adjoining walls.
13. When transporting - Lock marijuana and marijuana delivery devices in a separate compartment or container within the vehicle; Require employees to have possession of their employee identification card at all times when transporting marijuana or marijuana delivery devices; Require at least two persons to be in a vehicle transporting marijuana or marijuana delivery devices, and require at least one person to remain in the vehicle while the marijuana or marijuana delivery device is being delivered; Provide specific safety and security training to employees transporting or delivering marijuana and marijuana delivery devices.



14. Address all other State regulations and City ordinances (FSS 381.986; Sec. 47-18.46) which may not have been addressed above.

GENERAL COMMENTS

The following comments are for informational purposes.

Please consider the following prior to submittal for Final DRC:

- 1.

Please consider the following prior to submittal for Building Permit:

- 1.

Fully operational lighting and alarms reasonably designed to ensure the safety of persons and to protect the premises from theft, both in the premises and in the surrounding rights-of-way including:

- A silent security alarm that notifies the police department that a crime is taking place;

- A vault, drop safe or cash management device that provides a minimum access to the cash receipts; and,

- A security camera system capable of recording and retrieving, for at least thirty (30) days, an image which shall be operational at all times during and after business hours. The security cameras shall be located:

- At every ingress and egress to the dispensary;
- On the interior where any monetary transaction shall occur; and,
- At the ingress and egress to any area where medical cannabis is stored.



Case Number: PLN-SITE-19100008

CASE COMMENTS:

Please provide a response to the following:

1. Garbage, Recycling and Bulk Trash shall be provided.
2. Recycling reduces the amount of trash your business creates and it is the best way to reduce monthly waste disposal costs and improve your company's bottom line.
3. Solid Waste Services shall be provided by a Private Contractor licensed by the City.
4. Service Days shall be: No restriction for Commercial collection. Service may not occur earlier than 7:00 am or later than 10:00 pm within 250 feet of residential.
5. Solid Waste Collection shall be on private property container shall not be placed, stored or block the public street to perform service (large multifamily and commercial parcels).
6. Containers: must comply with 47-19.4
7. Dumpster enclosure: concrete pad, decorative block wall, gates hung independently, protective bollards, secondary pedestrian side entry, high strengthen apron and driveway approach, night light, hot water, hose bib, drain, low circulating ventilation for dampness, weep holes, landscaping, smooth surface walkway to accommodate wheeled containers.
8. Provide on the site plan a garbage truck turning radii for City review. Indicate how truck will circulate within property.
9. Submit a Solid Waste Management Plan on your letterhead containing name of project, address, DRC case number, number of units if applicable, and indicate whether it is Pre or Final DRC.
 - o This letter is to be approved and signed off by the Sustainability Division, and should be attached to your drawings. Please email an electronic copy to smccutcheon@fortlauderdale.gov. Letter should include an analysis of the expected amounts of solid waste and recyclables that will be generated (if different from current capacity), and container requirements to meet proposed capacity.
 - o Community Inspections will reference this Solid Waste Plan for sanitation compliance issues at this location.

GENERAL COMMENTS

The following comments are for informational purposes.

Please consider the following prior to submittal for Final DRC:

1. None



Case Number: PLN-SITE-19100008

CASE COMMENTS:

1. Continue coordinating with Transportation & Mobility on the parking reduction study and request.
2. Ensure sidewalk is a minimum of 5 feet wide on **N Victoria Park Rd**. This minimum is in reference to clear, unobstructed pathways –Light poles, trees and landscaping is not to be included in this zone. Landscaping should be between the sidewalks and back of curb and a minimum of 4 feet in width.
3. Ensure sidewalk is a minimum of 7 feet wide on **Sunrise Blvd**. This minimum is in reference to clear, unobstructed pathways –Light poles, trees and landscaping is not to be included in this zone. Landscaping should be between the sidewalks and back of curb and a minimum of 4 feet in width.
4. Back of sidewalk should begin on the ultimate right of way/easement dedication line.
5. Continue the concrete sidewalk through the driveway.
6. All loading and unloading must be contained on site including postal delivery services and rideshare pick up and drop off.
7. Please show inbound and outbound stacking requirements from the property line to the first conflict point according to sec 47-20.5 General design of parking facilities for each driveway.
8. Per ULDR Section 47-2.2.Q, show and label sight triangles as appropriate for safe and adequate access of drivers and pedestrians, on the Site Plan, Landscape Plans, and Civil Plans: intersections of driveways with streets and alleys (10' measured from intersection point of pavement edges), alleys with alleys (15' measured from intersection point of extended property lines), alleys with streets (15' measured from intersection point of extended property lines), and streets with streets (25' measured from intersection point of extended property lines). The request for reduction of sight triangle dimensions is subject to review by the City Engineer on a case-by-case basis. Per ULDR Section 47-19.1.E, no accessory use or structure shall be permitted within a sight triangle except as provided in ULDR Section 47-35.
9. Bicycle parking is strongly encouraged. Consult the APBP Bicycle Parking Guidelines, city of Fort Lauderdale Parking Standards and Broward County End-of-Trip Bicycle Facilities Guide. Provide the minimum long term and short term bicycle parking based on requirements in the guide and include total counts on the site plan data sheet.
10. Ensure all access points, sidewalks, walkways, and curb cuts are unobstructed and ADA accessible with appropriate slopes and detectible warning devices and indicate on the site plan.
11. Additional comments may be provided upon further review.
12. Signature required.

GENERAL COMMENTS:

Please address comments below where applicable.



1. Contact Benjamin Restrepo at 954-828-5216 or brestrepo@fortlauderdale.gov to set up an appointment for final plan approval.
2. The City's Transportation & Mobility Department encourages the use of sustainable materials such as permeable pavement and electric car charge stations and installation of multimodal facilities such as bicycle pump stations and bike lockers.
3. Please note that any work within the City's right-of-way will require an MOT approved by Transportation and Mobility and Engineering for permitting. Any full closures of roadways, alleys, or sidewalks that are over 72 hours will require a Revocable License Agreement (RLA) with the City of Fort Lauderdale.



Case Number: PLN-SITE-PL19100008

CASE COMMENTS:

Please provide a response to the following:

1. Pursuant to public participation requirements of the City's Unified Land Development Code (ULDR) Section 47-27.4.A.2.c, the applicant must complete the following:
 - a. Prior to submittal of the application to the Planning and Zoning Board (PZB), the applicant shall:
 1. Provide notice via email and regular mail to the official city-recognized civic organizations(s) within 300 feet of the proposed project, notifying of the date, time and place of the applicant's project presentation meeting to take place prior to the PZB meeting (a listing of officially-recognized neighborhood associations is provided on the City of Fort Lauderdale website: <http://www.fortlauderdale.gov/neighbors/civic-associations>); and,
 2. Provide notice via mailed letter to property owners whose real property is located within 300 feet of the proposed project, notifying of the date, time, and place of applicant's project presentation meeting to take place prior to the PZB meeting.
 - b. The applicant shall then conduct a public participation meeting(s) a minimum of 30 days prior to the PZB. This date and location of the meeting is at the discretion of the applicant. Once the meeting(s) is conducted, the applicant shall provide a written report letter to the Department of Sustainable Development, with copy to subject association(s), documenting the date(s), time(s), location(s), number of participants, presentation material and general summary of the discussion after a public participation meeting(s). The report letter shall summarize the substance of comments expressed during the process and shall be made a part of the administrative case file record; and
 - c. Accordingly, a minimum of ten (10) days prior to the PZB meeting, the applicant shall execute and submit an affidavit of proof of public notice to the Department. If the applicant fails to submit the affidavit, the public hearing will be postponed until the next available hearing date after the affidavit has been supplied.
Note: Please refer to City's Completeness Email dated October 22, 2019 for specific civic association contact.
2. The site is designated Commercial on the City's Future Land Use Map. The proposed use is permitted in this designation. This is not a determination on consistency with Comprehensive Plan Goals, Objectives and Policies.
3. Pursuant to ULDR, Section 47-24, this project requires review and approval by the PZB. A separate application and fee are required for PZB submittal, and the applicant is responsible for all public notice requirements (Sec. 47-27). In addition, the development permit shall not take effect nor shall a building permit be issued until thirty (30) days after approval, and then only if no motion is adopted by the City Commission seeking to review the application.
4. A parking reduction is requested. Pursuant to ULDR, Section 47-20, a separate fee is required for a parking reduction. Contact the Transportation and Mobility Development Review Committee (DRC) representative, Benjamin Restrepo (954-828-5216 or brestrepo@fortlauderdale.gov) to discuss the parking reduction methodology and process. Please note that there is an associated fee for the parking reduction review that will be billed when complete. Should the application for a parking reduction be approved, a parking reduction order must be executed and recorded in the public records of Broward County at the applicant's expense, prior to Final DRC approval.

5. Verify that copy of plat is the most current recorded plat, including notes and amendments, for the proposed site. Provide documentation from the Broward County Planning Council verifying that the site does not require platting or re-platting. If re-platting or platting is not required, contact the Development Review Services Section of the Planning and Environmental Regulation Division of Broward County at (954) 357-6637 to ensure that proposed project is consistent with the latest recorded plat restriction.
6. Indicate the project's compliance with the ULDR Sections 47-20.3.A.3, Parking Reductions and Exemptions by providing a point-by-point narrative response, on letterhead, with date and author indicated
7. Please be advised that pursuant to Section 381.986, Florida Statutes, dispensing organizations require a license by the State of Florida to cultivate, process, transport and dispense medical cannabis. Therefore, a license is required from the State in order to be operate as a medical cannabis dispensing facility in the City.

DEVELOPMENT SITE COMMENTS

8. Pursuant to Section 47-20.11.D.1., a standard off-street motorcycle and scooter parking space shall be a minimum of four (4) feet, four (4) inches in width and the length shall the parking geometric layout by parking angle (30, 45, 60, or 90 degrees) which is 18 feet long. The length to the two (2) proposed motorcycle parking does not meet the standard length of a parking stall.
9. Pursuant to Unified Land Development Regulations (ULDR) Section 47-25.3.A.3.d.i., Neighborhood Compatibility Requirements, Bufferyard Requirements, Excluding parks, open space and conservation areas, when a use which is subject to the requirements of this Sec. 47-25.3 is contiguous to any residential property, the property where the use is located shall be required to have a landscaped strip area and a physical barrier between it and the residential property.
Such landscape strip shall meet the following requirements: Landscape strip requirements.
 - A ten (10) foot landscape strip shall be required to be located along all property lines which are adjacent to residential property. Such landscape strip shall include trees, shrubs and ground cover as provided in the landscape provisions of Section 47-21, Landscape and Tree Preservation Requirements. The width of the landscape area shall extend to the property line. All required landscaping shall be protected from vehicular encroachment. When walls are required on nonresidential property abutting an alley, required shrubbery shall be installed and located within the landscape area on the exterior of the wall.
 - Note: The applicant is required to apply for a variance to the Board of Adjustment in order to reduce the residential landscape buffer from ten (10) feet to five (5) feet along the northern property line.
10. The parking spaces on the southwest corner requires a vehicular use area (VUA) buffer of 10-feet due to the abutting right-of-way (ROW), pursuant to Section 47-21.12.A.1. To alleviate providing a 10-foot VUA, consider shifting the building to the southwest corner of the site and moving the parking spaces to the southeast corner with the front façade being placed in front of the Florida Department of Transportation (FDOT) corner chord. Moving the parking spaces to the southeast corner of the site would only require providing a VUA buffer of 2.5 feet abutting the easterly property.
11. Coordinate and discuss the Security Plan with the Police Representative and ensure that the application addresses criteria as defined in ULDR, Section 47-18.46.D.3, Medical Cannabis Dispensing Facility.



12. Depict/label all mechanical equipment including spot elevations of all mechanical equipment to verify proposed screening adequately shields all equipment from view and/or incorporate these elements onto a seamless design treatment solution. Equipment should be centralized to the extent possible so it's not visible. In addition, indicate all mechanical equipment within the subject site on the site plan and elevations where applicable.
13. It is strongly recommended that bicycle parking is provided in visible, well-lit areas as close as possible to pedestrian entryways/doors. In addition where possible, locate bicycle parking facilities in an area that is sheltered/covered. For more information, please send email to kmendrala@fortlauderdale.gov for information on bicycle parking standards and to obtain a copy of the Assoc. of Pedestrian and Bicycle Professionals [APBP] Bicycle Parking Guidelines and Broward County End-of-Trip Bicycle Facility Guide.
14. The City's Vision is to support sustainable infrastructure. Consider employing green building practices throughout the project such as, but not limited to; charging stations, tank-less water heaters, rain collection systems, pervious pavement where appropriate, bio-swales, Florida Friendly™ plant materials, solar panels and green roofs.

GENERAL COMMENTS

The following comments are for informational purposes.

Please consider the following prior to submittal for Final Development Review Committee ("DRC"):

15. Please be advised that pursuant to Section 166.033, Florida Statutes, development permits which require a quasi-judicial or public hearing decision, must be completed within 180 days, unless an extension of time is mutually agreed upon between the City and the applicant.
16. An additional follow-up coordination meeting may be required to review project changes necessitated by the DRC comments. Prior to routing your plans for Final DRC sign-off, please schedule an appointment with the project planner (954-828-6162 or kgrant@fortlauderdale.gov) to review project revisions and/or to obtain a signature routing stamp.
17. Additional comments may be forthcoming at the DRC meeting.

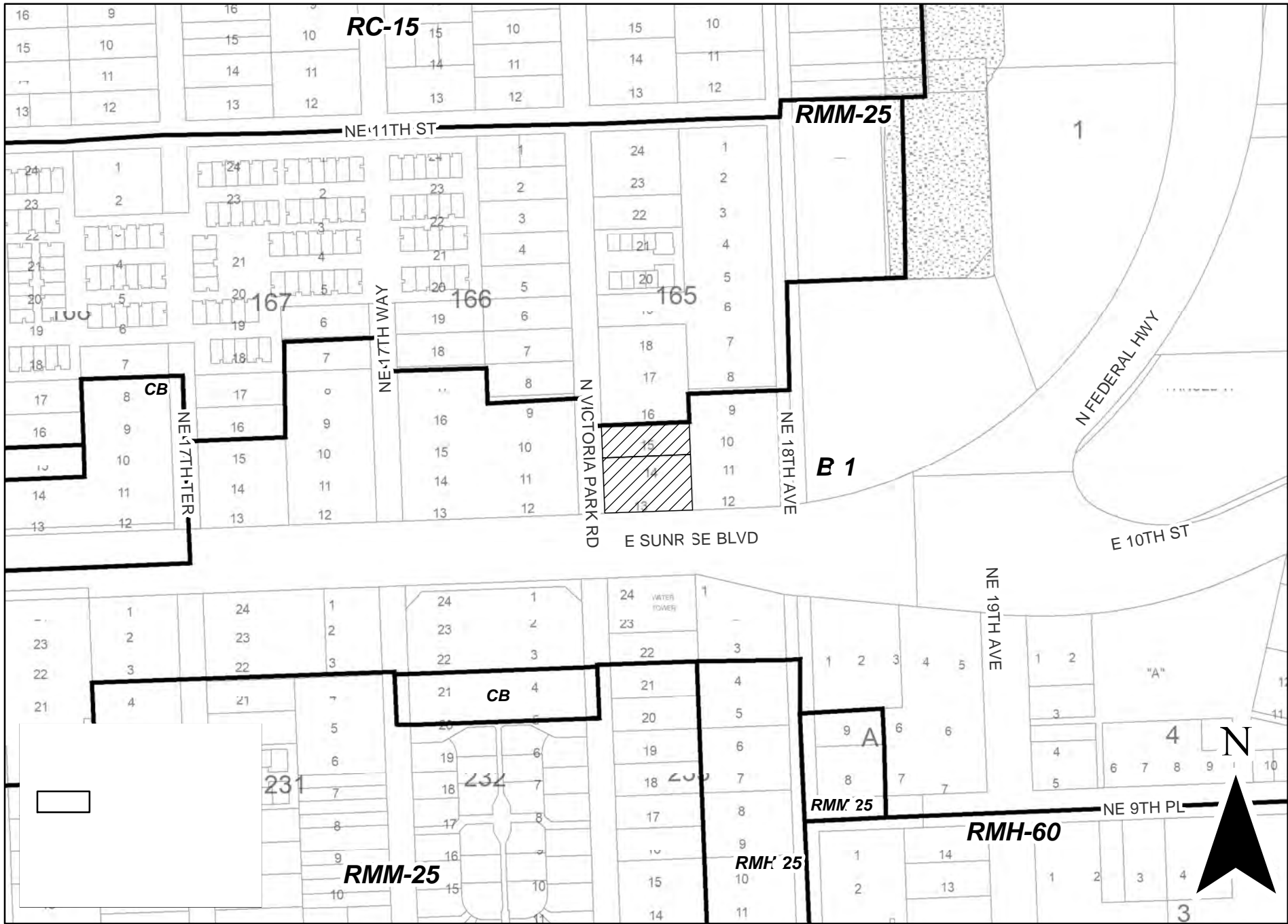

PLN-SITE-19100008

