

MAINTENANCE OF TRAFFIC (MOT) FORM

SECTION 1: APPLICANT INFORMATION

Applicant Name: Brian Pittman Applicant Phone: 615-498-0575
 Applicant Email: BrianPittman@LiveNation.com
 Applicant Address: 410 Chestnut St Nashville, TN
(Address, City, State, Zip Code)
 City Project Manager (if applicable): _____ Phone: _____
 Agency responsible for this project: City County FDOT Other: _____
 On-site/Emergency Contact Phone: 615-498-0575

MOT APPROVAL
CITY OF FORT LAUDERDALE
TRANSPORTATION AND MOBILITY

SECTION 2: PROJECT INFORMATION

ENG Permit # (obtain from Department of Sustainable Development (DSD)): Special Event
 Project Name: Tortuga Music Festival
 Project Address: 1100 Seabreeze Fort Lauderdale, FL
(Address, City, State, Zip Code)

Specific Dates and Times Requested for MOT Implementation:

Please identify a start date that is at least two weeks from the submittal date. The approval of an MOT application may require up to two weeks from the time that all required documents are received by TAM staff.

Begin Date: 3/27/23 Begin Time: 7:00am
 End Date: 4/21/23 End Time: 7:00pm

SECTION 3: PROJECT DETAILS

Partial or Shoulder Closure
 Full Road Closure (detour): Under 72 Hours
 Sidewalk Closure: Under 72 Hours
 Full Road/Sidewalk Closure: More than 72 Hours

Daily Setup/ Breakdown YES NO
 Using Crane in ROW* YES NO
 Parking Meters Impacted* YES NO

*Crane and parking meter mitigation must be done prior to MOT approval. Please refer to the MOT Guidelines for crane definitions.

SECTION 4: TYPE OF WORK DESCRIPTION

Please make sure to include the following information in the description:

- List the names of affected streets and the nearest intersection. Use complete street names, including directionals.
- Describe the nature of the construction and any phasing plans. A separate MOT application is required for each phase.
- Describe any specific safety hazards that the work may produce during construction (i.e., large holes, etc.).

SE 5th St will be closed between A1A North Bound and Seabreeze South Bound. We will use this road for production load in prior to event and loud out post event. Show days we will operate our staff shuttle program on SE 5th St.

Southbound Seabreeze one lane will be closed to create pedestrian walk way. Due to construction on Seabreeze

SECTION 5: FDOT DESIGN STANDARD INDEX DRAWING NUMBERS/MUTCD TYPICAL APPLICATION

(State which FDOT Standard Index 600 series will be followed. The indexes must include the north arrow and the names of the main and cross streets. Also, state whether trenches will be covered or backfilled during non-working hours.)

TA-20

MAINTENANCE OF TRAFFIC (MOT) FORM

SECTION 6: MOT DESCRIPTION

Please make sure to include the following information in the description:

- List the lanes that will be open and closed on each street and describe any necessary detours in detail. If detours are not required, please state that below.
- State if flagmen will be provided.
- State if the MOT will be continuous or intermittent. If intermittent, state the times of the day the MOT will be in effect.
- State any other special considerations related to this request.

MOT APPROVAL
CITY OF FORT LAUDERDALE
TRANSPORTATION AND MOBILITY

SE 5th Street between A1A and Seabreeze Blvd will be closed. Vehicles will be detoured north to E Las Olas Blvd

Flagmen not required. MOT will be continuous during event

SECTION 7: MOT FORM CHECKLIST (Provide one copy of each attachment.)

- | | |
|--|--|
| <input type="checkbox"/> Completed Required Signatures Form | <input type="checkbox"/> Certification(s) for Traffic Control Technician or Traffic Control Supervisor must be embedded on MOT plans along with FDOT indexes/MUTCD documents |
| <input type="checkbox"/> Color aerial(s)/MOT Plan with index overlay | |
| <input type="checkbox"/> County and State approvals (if required) | <input type="checkbox"/> Plan of work (optional, but preferred) |
| <input type="checkbox"/> Crane and Parking Mitigation (if required) | |
| <input type="checkbox"/> FDOT Index MUTCD Reference Drawing(s) | |

SECTION 8: ADDITIONAL COMMENTS

Please Note: The approval of an MOT application may require up to two weeks from the time that all required documents in the checklist above are received by TAM staff. Any rejected MOT submittal that is corrected and sent back will be considered a new submittal, which may require up to two additional weeks to approve. Additional time may be needed for more complex plans or plans requiring additional coordination/information.

In signing this application, I understand that separate City and/or County and/or State permits may be required for this project. Furthermore, I am aware that I am responsible for ensuring that the project is completed in accordance with the plans and specifications as stipulated in the permit approval condition.



(APPLICANT SIGNATURE)

Brian Pittman - Site Director

(PRINT NAME/TITLE)

4/5/23

(DATE SIGNED)

As a consideration for the permission granted herein, Tortuga Music Festival agrees to indemnify and hold harmless the City of Fort Lauderdale for any damages, claims, or injuries that may result from the MOT plan approved under the PERMIT.
(APPLICANT)

(NAME OF COMPANY)

BY: _____
(COMPANY AUTHORIZED AGENT)

REQUIRED SIGNATURES FORM

Applicant must collect all required signatures. To expedite processing, individual signatures may be obtained and submitted to MOT@fortlauderdale.gov separately on this page. A signature and comment must be submitted before two-week review process begins.

MOT APPROVAL
CITY OF FORT LAUDERDALE
TRANSPORTATION AND MOBILITY

R. DIETRICH

Print Name

Signature

Police Department

1300 W. Broward Boulevard | Tel: 954-828-5477

Call for Appointment

*Required only if MOT includes a detour for any direction of travel.

4/6/23

(Date)

Print Name

Signature

Fire Rescue Department

528 N.W. 2nd Street | Tel: 954-828-6800

Call for Appointment

*Required only if MOT includes a detour for any direction of travel.

(Date)

Print Name

Signature

Broward County Traffic Engineering Division

2300 W. Commercial Boulevard | Tel: 954-847-2653

Call for Appointment. Walk-ins NOT accepted.

*Required only if MOT/detour affects Broward County road or intersection.

(Date)

After all applicable signatures are collected, applicant should submit the MOT plan and this routing form to the Transportation and Mobility Department at mot@fortlauderdale.gov.

OFFICE USE ONLY

Department Director's Signature (requested by City staff if required)

Morgan Dunn

Print Name

Morgan Dunn

Signature

Transportation and Mobility Department

290 N.E. 3rd Avenue | Tel: 954- 828-4997 | Email: MOT@fortlauderdale.gov

Call for Appointment. Walk-ins and hard copies NOT accepted.

4/6/23

(Date)

Lisa Marie Glover for Ben Rogers

Lisa Marie Glover for Ben Rogers (Apr 7, 2023 12:22 EDT)

Signature

Transportation and Mobility Department

Ben Rogers, Director

(Date)

A copy of the final permit and this MOT form shall be kept on site and be made available to the City inspector at all times.

Traffic modifications required for special events shall be coordinated through the Parks and Recreation's Special Events Department. Please call 954-828-4349 or email BHenry@fortlauderdale.gov.

MOT plans for City Capital Improvement Projects shall be coordinated through the City of Fort Lauderdale Public Works Department. Please call 954-828-5772 or email ralvarez@fortlauderdale.gov.

REQUIRED SIGNATURES FORM

Applicant must collect all required signatures. To expedite processing, individual signatures may be obtained and submitted to MOT@fortlauderdale.gov separately on this page. All signatures and comments must be submitted before two-week review process begins.

MOT APPROVAL

CITY OF FORT LAUDERDALE
TRANSPORTATION AND MOBILITY

<p>_____ Print Name</p> <p style="text-align: center;">Police Department 1300 W. Broward Boulevard Tel: 954-828-5477 <i>Call for Appointment</i></p> <p>*Required only if MOT includes a detour for any direction of travel.</p>	<p>_____ Signature</p> <p style="text-align: right;">(Date)</p>	
<p>John F. San Angelo Print Name</p> <p style="text-align: center;">Fire Rescue Department 528 N.W. 2nd Street Tel: 954-828-6800 <i>Call for Appointment</i></p> <p>*Required only if MOT includes a detour for any direction of travel.</p>	<p style="text-align: center;"><i>John F. San Angelo</i> Signature</p> <p style="text-align: right;">04/06/23 _____ (Date)</p>	
<p>_____ Print Name</p> <p style="text-align: center;">Broward County Traffic Engineering Division 2300 W. Commercial Boulevard Tel: 954-847-2653 <i>Call for Appointment. Walk-ins NOT accepted.</i></p> <p>*Required only if MOT/detour affects Broward County road or intersection.</p>	<p>_____ Signature</p> <p style="text-align: right;">_____ (Date)</p>	
<p>After all applicable signatures are collected, applicant should submit the MOT plan and this routing form to the Transportation and Mobility Department at mot@fortlauderdale.gov.</p>		
<p>OFFICE USE ONLY</p>		
<p>Department Director's Signature (requested by City staff if required)</p>		
<p>_____ Print Name</p> <p style="text-align: center;">Transportation and Mobility Department 290 N.E. 3rd Avenue Tel: 954- 828-4997 Email: MOT@fortlauderdale.gov <i>Call for Appointment. Walk-ins and hard copies NOT accepted.</i></p>	<p>_____ Signature</p> <p style="text-align: right;">_____ (Date)</p>	
<p style="text-align: center;">_____ Signature</p> <p style="text-align: center;">Transportation and Mobility Department Ben Rogers, Director</p>	<p style="text-align: right;">_____ (Date)</p>	

A copy of the final permit and this MOT form shall be kept on site and be made available to the City inspector at all times.

Traffic modifications required for special events shall be coordinated through the Parks and Recreation's Special Events Department. Please call 954-828-4349 or email BHenry@fortlauderdale.gov.

MOT plans for City Capital Improvement Projects shall be coordinated through the City of Fort Lauderdale Public Works Department. Please call 954-828-5772 or email ralvarez@fortlauderdale.gov.

MARK MEYERS

 This Certifies that
Mark Meyers
 Has Completed a Florida Department of Transportation Approved
 Temporary Traffic Control (TTC) Advanced (Refresher) Course.
 Date Expires: 02/11/2023 Certificate # 47529
 Instructor: Richard Cabrera FDOT Provider # 37

ATSSA
 Phone: 540-368-1701
 15 Riverside Parkway Ste.100
 Fredericksburg, VA
 www.atssa.com
 donna.clark@atssa.com

 SAFER ROADS SAVE LIVES

**MOT APPROVAL
CITY OF FORT LAUDERDALE
TRANSPORTATION AND MOBILITY**

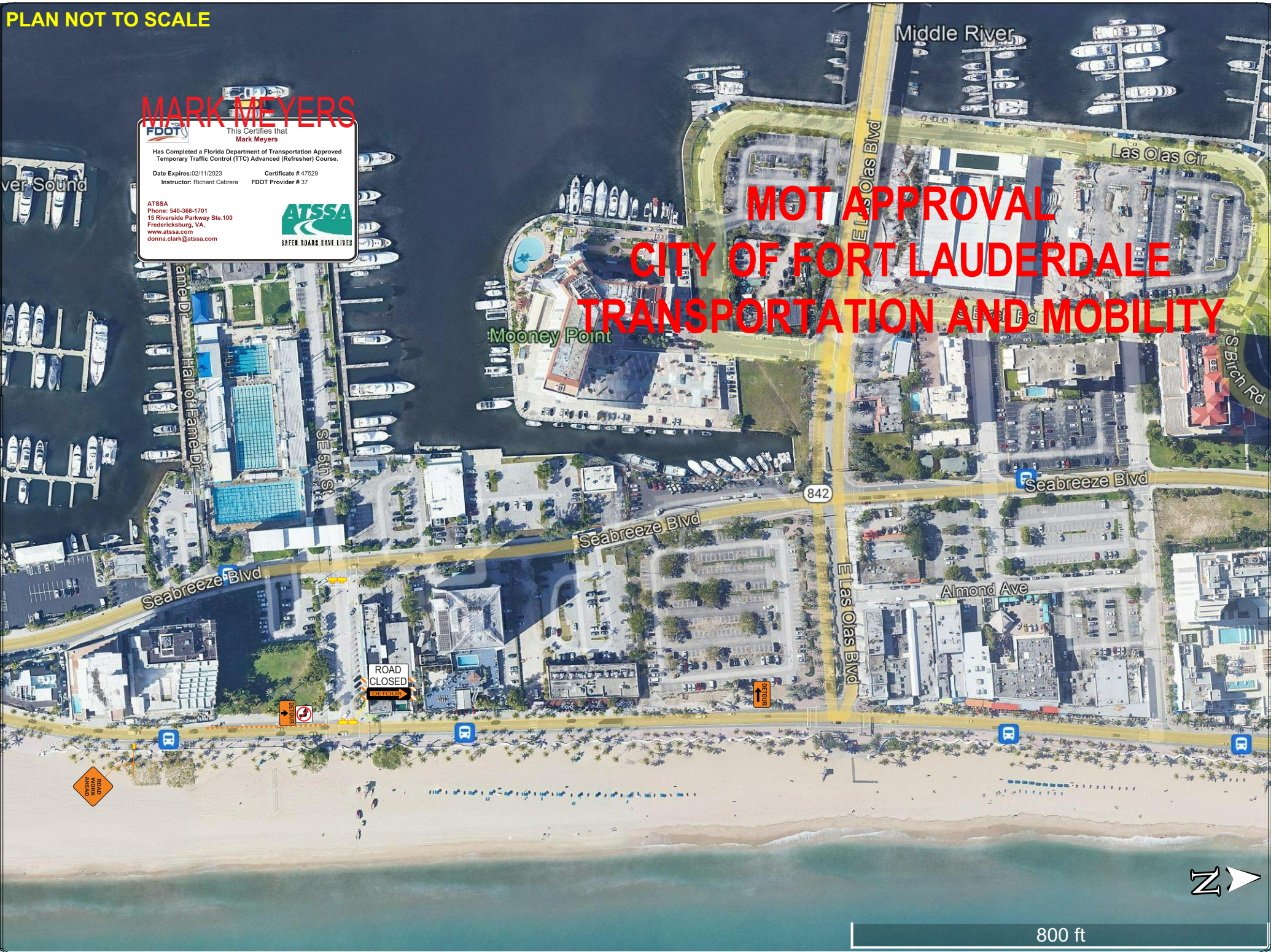

Notes for Figure 6H-20—Typical Application 20
Detour for a Closed Street

Guidance:

1. *This plan should be used for streets without posted route numbers.*
2. *On multi-lane streets, Detour signs with an Advance Turn Arrow should be used in advance of a turn.*

Option:

3. Flashing warning lights and/or flags may be used to call attention to the advance warning signs.
4. Flashing warning lights may be used on Type 3 Barricades.
5. Detour signs may be located on the far side of intersections. A Detour sign with an advance arrow may be used in advance of a turn.
6. A Street Name sign may be mounted with the Detour sign. The Street Name sign may be either white on green or black on orange.

Standard:

- 7. When used, the Street Name sign shall be placed above the Detour sign.**

Support:

8. See Figure 6H-9 for the information for detouring a numbered highway.

MOT APPROVAL
CITY OF FORT LAUDERDALE
TRANSPORTATION AND MOBILITY

Figure 6H-20. Detour for a Closed Street (TA-20)

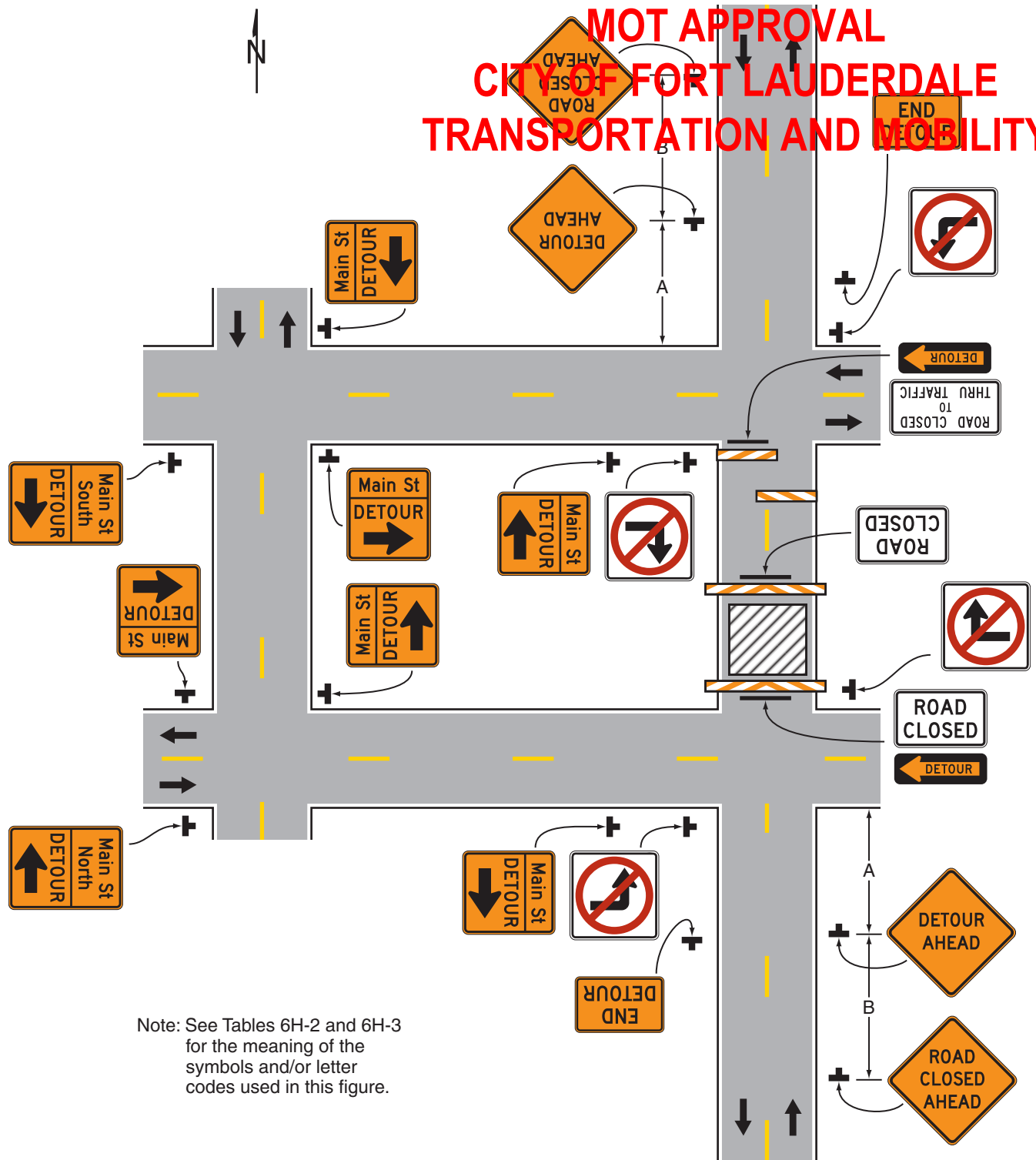

Typical Application 20







TAM-MOT-23040009 Special Event

Final Audit Report

2023-04-07

Created:	2023-04-06
By:	Morgan Dunn (MDunn@fortlauderdale.gov)
Status:	Signed
Transaction ID:	CBJCHBCAABAAiXIk7XjcPNG5uEgdRtFCEpGKT2QM3EjL

"TAM-MOT-23040009 Special Event" History

-  Document created by Morgan Dunn (MDunn@fortlauderdale.gov)
2023-04-06 - 8:00:16 PM GMT- IP address: 207.203.28.2
-  Document emailed to Lisa Marie Glover (LGlover@fortlauderdale.gov) for signature
2023-04-06 - 8:01:00 PM GMT
-  Email viewed by Lisa Marie Glover (LGlover@fortlauderdale.gov)
2023-04-07 - 4:22:14 PM GMT- IP address: 207.203.28.2
-  Signer Lisa Marie Glover (LGlover@fortlauderdale.gov) entered name at signing as Lisa Marie Glover for Ben Rogers
2023-04-07 - 4:22:28 PM GMT- IP address: 207.203.28.2
-  Document e-signed by Lisa Marie Glover for Ben Rogers (LGlover@fortlauderdale.gov)
Signature Date: 2023-04-07 - 4:22:30 PM GMT - Time Source: server- IP address: 207.203.28.2
-  Agreement completed.
2023-04-07 - 4:22:30 PM GMT

Names and email addresses are entered into the Acrobat Sign service by Acrobat Sign users and are unverified unless otherwise noted.



Powered by
Adobe
Acrobat Sign