

# MAINTENANCE OF TRAFFIC (MOT) FORM

## SECTION 1: APPLICANT INFORMATION

Applicant Name: Ft. Lauderdale Air Show Kyle Smith **MOT APPROVAL** Applicant Phone: 320-699-0470  
 Applicant Email: Kyle@air.Show **CITY OF FORT LAUDERDALE**  
 Applicant Address: PO Box 360857, Melbourne, FL 32936 **TRANSPORTATION AND MOBILITY**  
(Address, City, State, Zip Code)  
 City Project Manager (if applicable): \_\_\_\_\_ Phone: \_\_\_\_\_  
 Agency responsible for this project:  City  County  FDOT  Other: \_\_\_\_\_  
 On-site/Emergency Contact Phone: Kyle Smith 320-699-0470

## SECTION 2: PROJECT INFORMATION

ENG Permit # (obtain from Department of Sustainable Development (DSD)): Special Event  
 Project Name: Las Olas Closure  
 Project Address: Las Olas Blvd b/w NB & SB A1A  
(Address, City, State, Zip Code)

### Specific Dates and Times Requested for MOT Implementation:

Please identify a start date that is at least two weeks from the submittal date. The approval of an MOT application may require up to two weeks from the time that all required documents are received by TAM staff.

Begin Date: 4/28/23 Begin Time: 6 am  
 End Date: 5/1/23 End Time: 8 am

## SECTION 3: PROJECT DETAILS

- Partial or Shoulder Closure
- Full Road Closure (detour): Under 72 Hours
- Sidewalk Closure: Under 72 Hours
- Full Road/Sidewalk Closure: More than 72 Hours

- Daily Setup/ Breakdown  YES  NO
- Using Crane in ROW\*  YES  NO
- Parking Meters Impacted\*  YES  NO

\*Crane and parking meter mitigation must be done prior to MOT approval. Please refer to the MOT Guidelines for crane definitions.

## SECTION 4: TYPE OF WORK DESCRIPTION

Please make sure to include the following information in the description:

- List the names of affected streets and the nearest intersection. Use complete street names, including directionals.
- Describe the nature of the construction and any phasing plans. A separate MOT application is required for each phase.
- Describe any specific safety hazards that the work may produce during construction (i.e., large holes, etc.).

Closure of Las Olas Blvd b/w NB & SB A1A

## SECTION 5: FDOT DESIGN STANDARD INDEX DRAWING NUMBERS/MUTCD TYPICAL APPLICATION

(State which FDOT Standard Index 600 series will be followed. The indexes must include the north arrow and the names of the main and cross streets. Also, state whether trenches will be covered or backfilled during non-working hours.)

TA-20

# MAINTENANCE OF TRAFFIC (MOT) FORM

## SECTION 6: MOT DESCRIPTION

Please make sure to include the following information in the description:

- List the lanes that will be open and closed on each street and describe any necessary details in detail. If details are not required, please state that below.
- State if flagmen will be provided.
- State if the MOT will be continuous or intermittent. If intermittent, state the times of the day the MOT will be in effect.
- State any other special considerations related to this request.

**MOT APPROVAL  
CITY OF FORT LAUDERDALE  
TRANSPORTATION AND MOBILITY**

## SECTION 7: MOT FORM CHECKLIST (Provide one copy of each attachment.)

- Completed Required Signatures Form
- Certification(s) for Traffic Control Technician or Traffic Control Supervisor must be embedded on MOT plans along with FDOT indexes/MUTCD documents
- Color aerial(s)/MOT Plan with index overlay
- County and State approvals (if required)
- Crane and Parking Mitigation (if required)
- FDOT Index MUTCD Reference Drawing(s)
- Plan of work (optional, but preferred)

## SECTION 8: ADDITIONAL COMMENTS

**Please Note: The approval of an MOT application may require up to two weeks from the time that all required documents in the checklist above are received by TAM staff. Any rejected MOT submittal that is corrected and sent back will be considered a new submittal, which may require up to two additional weeks to approve. Additional time may be needed for more complex plans or plans requiring additional coordination/information.**

In signing this application, I understand that separate City and/or County and/or State permits may be required for this project. Furthermore, I am aware that I am responsible for ensuring that the project is completed in accordance with the plans and specifications as stipulated in the permit approval condition.

  
 \_\_\_\_\_  
 (APPLICANT SIGNATURE)  
 4/17/23  
 \_\_\_\_\_  
 (DATE SIGNED)

Kyle J. Smith, Event Manager  
 \_\_\_\_\_  
 (PRINT NAME/TITLE)

As a consideration for the permission granted herein, Ft. Lauderdale Air Show agrees to indemnify and hold harmless the City of Fort Lauderdale for any damages, claims, or injuries that may result from the MOT plan approved under the PERMIT.  
 (APPLICANT)

Lauderdale Air Show, LLC  
 \_\_\_\_\_  
 (NAME OF COMPANY)

BY:   
 \_\_\_\_\_  
 (COMPANY AUTHORIZED AGENT)



# REQUIRED SIGNATURES FORM

Applicant must collect all required signatures. To expedite processing, individual signatures may be obtained and submitted to [MOT@fortlauderdale.gov](mailto:MOT@fortlauderdale.gov) separately on this page. All signatures and comments must be submitted before two-week review process begins.

**MOT APPROVAL**

**CITY OF FORT LAUDERDALE  
TRANSPORTATION AND MOBILITY**

_____ Print Name	_____ Signature	_____ (Date)
<b>Police Department</b> 1300 W. Broward Boulevard   Tel: 954-828-5477 <i>Call for Appointment</i>		
*Required only if MOT includes a detour for any direction of travel.		

_____ Print Name	_____ Signature	_____ (Date)
<b>Fire Rescue Department</b> 528 N.W. 2 <sup>nd</sup> Street   Tel: 954-828-6800 <i>Call for Appointment</i>		
*Required only if MOT includes a detour for any direction of travel.		

_____ Print Name	_____ Signature	_____ (Date)
<b>Broward County Traffic Engineering Division</b> 2300 W. Commercial Boulevard   Tel: 954-847-2653 <i>Call for Appointment. Walk-ins NOT accepted.</i>		
*Required only if MOT/detour affects Broward County road or intersection.		

After all applicable signatures are collected, applicant should submit the MOT plan and this routing form to the Transportation and Mobility Department at [mot@fortlauderdale.gov](mailto:mot@fortlauderdale.gov).

### OFFICE USE ONLY

Department Director's Signature (requested by City staff if required)

Morgan Dunn _____ Print Name	 _____ Signature	4/25/23 _____ (Date)
<b>Transportation and Mobility Department</b> 290 N.E. 3 <sup>rd</sup> Avenue   Tel: 954- 828-4997   Email: <a href="mailto:MOT@fortlauderdale.gov">MOT@fortlauderdale.gov</a> <i>Call for Appointment. Walk-ins and hard copies NOT accepted.</i>		

 <small>Lisa Marie Glover for Ben Rogers (Apr 27, 2023 09:08 EDT)</small> _____ Signature	<b>Transportation and Mobility Department</b> Ben Rogers, Director	_____ (Date)
---	---	-----------------

A copy of the final permit and this MOT form shall be kept on site and be made available to the City inspector at all times.

Traffic modifications required for special events shall be coordinated through the Parks and Recreation's Special Events Department. Please call 954-828-4349 or email [BHenry@fortlauderdale.gov](mailto:BHenry@fortlauderdale.gov).

MOT plans for City Capital Improvement Projects shall be coordinated through the City of Fort Lauderdale Public Works Department. Please call 954-828-5772 or email [ralvarez@fortlauderdale.gov](mailto:ralvarez@fortlauderdale.gov).

**From:** [Kyle](#)  
**To:** [Morgan Dunn](#)  
**Subject:** [EXTERNAL:CAUTION!]- Fw: OSP – Permit # 2023-F-491-00016 - Permit Approved  
**Date:** Monday, April 24, 2023 4:02:02 PM

---

**[::CAUTION!:] This email originated from outside The City of Fort Lauderdale.**  
**Do Not Reply, click links, or open attachments from an unknown or suspicious origin. Confirm the email address is from an expected source before taking action.**  
**Report any suspicious emails to [spamadmin@fortlauderdale.gov](mailto:spamadmin@fortlauderdale.gov)**

**MOT APPROVAL**  
**CITY OF FORT LAUDERDALE**  
**TRANSPORTATION AND MOBILITY**

---

Here's the approval note from FDOT. And I got it on the 1<sup>st</sup> try!

Amazing!

Take care,

Kyle J. Smith - Vice President, Sales

Cell: (320) 699-0470

[kyle@air.show](mailto:kyle@air.show)

*See Us in 2023:*

*Cocoa Beach Air Show - April 15 & 16*

*Fort Lauderdale Air Show - April 29 & 30*

*Augusta Air Show - May 13 & 14*

*Ocean City (MD) Air Show - June 10 & 11*

*New York Air Show - June 24 & 25*

*Atlanta Air Show - October 7 & 8*

*Orlando Air Show - October 28 & 29*

---

**From:** [donotreplyapps@dot.state.fl.us](mailto:donotreplyapps@dot.state.fl.us) <[donotreplyapps@dot.state.fl.us](mailto:donotreplyapps@dot.state.fl.us)>

**Sent:** Friday, April 21, 2023 5:25 PM

**To:** Kyle <[kyle@blilley.com](mailto:kyle@blilley.com)>

**Subject:** OSP – Permit # 2023-F-491-00016 - Permit Approved

FDOT has approved Permit # 2023-F-491-00016 | Project Name: "City of Ft. Lauderdale Lauderdale Air Show".

You may log in to [One-Stop Permitting](#) to view your approved permit package.

[Click here to download the approved package.](#)

**Comments:**

Approved.

**Please do not reply to this email. Replies to this email will not be monitored or responded to.**



PLAN NOT TO SCALE

MARK MEYERS

**FDOT** Mark Meyers

Certificate: Has Completed a FDOT Approved Temporary Traffic Control: Advanced Course.  
605769

Issued: 02/13/2023 Training Provider: myTTOnline  
83 Geneva Dr. Ste. 621394  
Oviedo, FL 32762  
Expires: 02/02/2027 myTTOnline  
Instructor: M.H. Oviedo, FL 32762  
Ph: 407-901-0206

Verify this Certificate at [www.moladmin.com](http://www.moladmin.com).

MOT APPROVAL  
CITY OF FORT LAUDERDALE  
TRANSPORTATION AND MOBILITY

TABLE 1 CHANNELIZING DEVICE SPACING					TABLE 2 TAPER LENGTH "L"	
Work Zone Speed (mph)	Max. Spacing (feet)				Work Zone Speed (mph)	Min. Length (feet)
	Cones or Temporary Tubular Markers	Type I Barricades, Vertical Panels, or Drums	Taper	Tangent		
≤ 45	25	50	25	Tangent	≤ 45	L = WS
≥ 50	25	50	50	Tangent	≥ 45	L = WS

Where: W = width of offset in feet  
S = speed in mph

TABLE 3 WORK ZONE SIGN SPACING "X"			TABLE 4 BUFFER LENGTH "B"	
Road Type	Min. Spacing (feet)	Work Zone Speed (mph)	Work Zone Speed (mph)	Min. Length (feet)
Arterials and Collectors with Work Zone Speed ≤ 40 mph	200	25	155	200
Arterials and Collectors with Work Zone Speed ≥ 45 mph	500	30	200	250
Limited Access Roadways	1,500	35	250	305
* For Limited access roadways with work zone speed ≥ 50 mph, the minimum spacing may be reduced in accordance with the MUTCD and as approved by the Engineer.				
		40	360	425
		45	495	570
		60	645	720
		70		

Note: When Buffer Length "B" cannot be attained due to geometric constraints, use the greatest length possible, but not less than 155 feet.



KEY:

- - Indicates 36" FDOT approved cone
- ▨ - Indicates Type III Barricade
- ◊ - Indicates Work Zone Signage



# CITY OF FORT LAUDERDALE TRANSPORTATION AND MOBILITY

SHEET	TABLE OF CONTENTS
1	General Notes, TTC Tables
2	Definitions
	Temporary Traffic Control Devices
	Overhead Work
	Railroads
	Sight Distance
3	Above Ground Hazard
	Clear Zone Widths For Work Zones
	Superelevation
	Length Of Lane Closures
	Overweight/Oversize Vehicles
4	Lane Widths
	High-Visibility Safety Apparel
	Speed Reduction Signing
	Flagger Control
	Survey Work Zones
5	Signs
5	Work Zone Sign Supports
6	Commonly Used Warning and Regulatory Signs In Work Zones
7	Manholes/Crosswalks/Joints
	Truck Mounted Attenuators
	Signals
	Channelizing Devices
	Channelizing Devices Consistency
8	Advanced Warning Arrow Boards
	Drop-Offs In Work Zones
9	Business Entrance
9	Temporary Asphalt Separator
	Channelizing Devices Notes
10	Temporary Barrier Notes
	Pavement Markings
11	

### GENERAL NOTES:

- This Index contains information specific to the Federal and State guidelines and standards for the preparation of traffic control plans and for the use of temporary traffic control devices, for construction and maintenance operations and for the use of highways, roads and streets on the State Highway System. Certain requirements in this Index are based on the unique nature of State Highways. For highways, roads and streets off the State Highway System, the local agency (City/County) having jurisdiction may adopt requirements based on the minimum requirements allowed in the MUTCD.
- Use this Index in accordance with the Plans and Index 100-600 or 102-800 devices 100-101 through 102-680 are Department-specific typical applications of commonly encountered situations. Adjust device location or number thereof as recommended by the Worksite Traffic Supervisor and approved by the Traffic Control Supervisor. This Index includes the minimum requirements for the use of temporary traffic control devices, including the use of flaggers, portable buffer zones, and other markings and markings that may be used in conjunction with MUTCD or a local agency's equipment criteria for daily changes and temporary closure for the change.
- Except for emergencies, any road closure on State Highway System must comply with Section 335.15, F.S.

**TABLE 1  
CHANNELIZING DEVICE SPACING**

Work Zone Speed (mph)	Max. Spacing (feet)			
	Cones or Temporary Tubular Markers		Type I Barricades, Type II Barricades, Vertical Panels, or Drums	
	Taper	Tangent	Taper	Tangent
≤ 45	25	50	25	50
≥ 50	25	50	50	100

**TABLE 2  
TAPER LENGTH "L"**

Work Zone Speed (mph)	Min. Length (feet)
≤ 40	$L = \frac{WS^2}{60}$
≥ 45	$L = WS$

Where: W = width of offset in feet  
S = speed in mph

**TABLE 3  
WORK ZONE SIGN SPACING "X"**

Road Type	Min. Spacing (feet)
Arterials and Collectors with Work Zone Speed ≤ 40 mph	200
Arterials and Collectors with Work Zone Speed ≥ 45 mph	500
Limited Access Roadways *	1,500

\* For Limited access roadways with work zone speed ≤ 55 mph, the minimum spacing may be reduced in accordance with the MUTCD and as approved by the Engineer.

**TABLE 4  
BUFFER LENGTH "B"**

Work Zone Speed (mph)	Min. Length (feet)
25	155
30	200
35	250
40	305
45	360
50	425
55	495
60	570
65	645
70	730

Note: When Buffer Length "B" cannot be attained due to geometric constraints, use the greatest length possible, but not less than 155 feet.

## MARK MEYERS

**Mark Meyers**

Certificate: 605769  
 Has Completed a FDOT Approved Temporary Traffic Control: Advanced Course.

Issued: 02/13/2023 Training Provider: myTTConline  
 Expires: 02/02/2027  
 Instructor: M.H.

83 Geneva Dr. Ste. 621394  
 Ovelo, FL 32762  
 Ph: 407-901-0206

Verify this Certificate at [www.motadmin.com](http://www.motadmin.com)

LAST REVISION	DESCRIPTION:
11/01/20	

**FY 2022-23  
STANDARD PLANS**

**GENERAL INFORMATION FOR TRAFFIC CONTROL THROUGH WORK ZONES**

INDEX	SHEET
102-600	1 of 11

9/23/2021 2:46:07 PM

9/23/2021 2:40:49 PM

**MARK MEYERS**

	<b>Mark Meyers</b>
Certificate: <b>605769</b>	Has Completed a FDOT Approved Temporary Traffic Control: Advanced Course.
Issued: 02/13/2023	Training Provider: myTTOnline
Expires: 02/02/2027	83 Geneva Dr. Ste. 621394 Oviedo, FL 32762 Ph: 407-901-0206
Instructor: M. H.	Verify this Certificate at <a href="http://www.moladmin.com">www.moladmin.com</a> .

**MOT APPROVAL  
CITY OF FORT LAUDERDALE  
TRANSPORTATION AND MOBILITY**

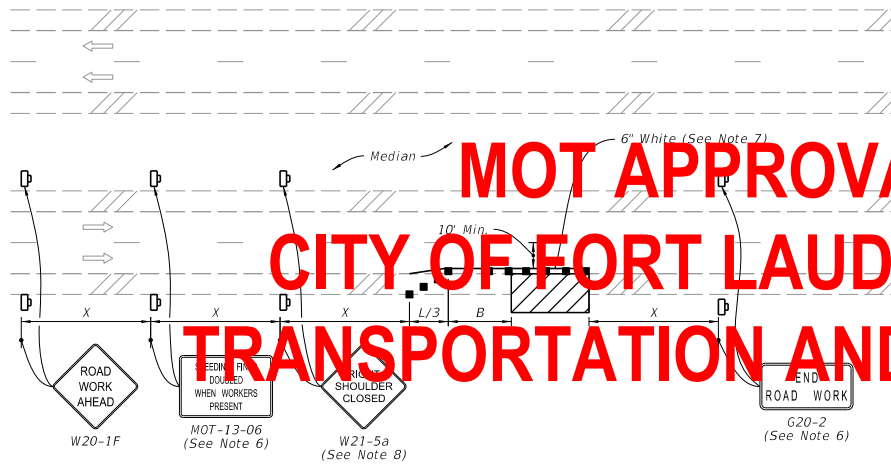

MULTILANE ROADWAY  
SHOULDER WORK LESS THAN 2' FROM THE TRAVELED WAY  
WITH WORK ZONE SPEED OF 45 MPH OR LESS

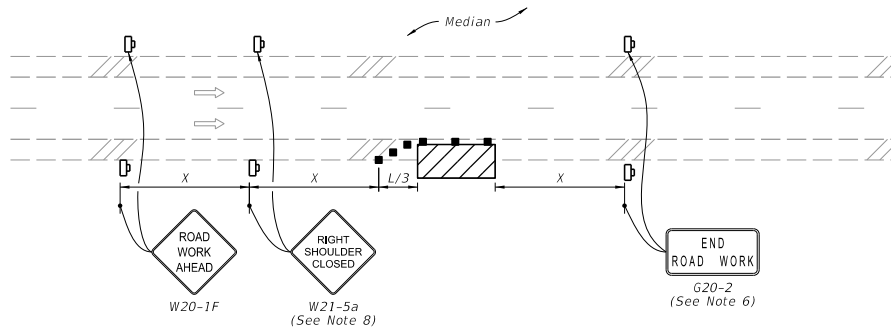
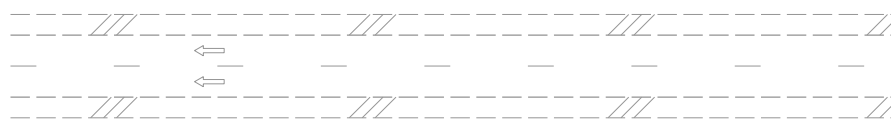

MULTILANE ROADWAY  
SHOULDER WORK BETWEEN 2' AND 15' FROM THE TRAVELED WAY

- SYMBOLS:**
- Work Area
  - Channelizing Device (See Index 102-600)
  - Work Zone Sign
  - Lane Identification and Direction of Traffic

LAST REVISION 11/01/20	DESCRIPTION:	 FY 2022-23 STANDARD PLANS	TWO-LANE AND MULTILANE, WORK ON SHOULDER	INDEX 102-602	SHEET 2 of 2
---------------------------	--------------	----------------------------------	--	------------------	-----------------

### Notes for Figure 6H-20—Typical Application 20 Detour for a Closed Street

**Guidance:**

1. *This plan should be used for streets without posted route numbers.*
  2. *On multi-lane streets, Detour signs with an Advance Turn Arrow should be used in advance of a turn.*
- Option:**
3. Flashing warning lights and/or flags may be used to call attention to the advance warning signs.
  4. Flashing warning lights may be used on Type 3 Barricades.
  5. Detour signs may be located on the far side of intersections. A Detour sign with an advance arrow may be used in advance of a turn.
  6. A Street Name sign may be mounted with the Detour sign. The Street Name sign may be either white on green or black on orange.

**Standard:**

7. **When used, the Street Name sign shall be placed above the Detour sign.**

**Support:**

8. See Figure 6H-9 for the information for detouring a numbered highway.

**MOT APPROVAL  
CITY OF FORT LAUDERDALE  
TRANSPORTATION AND MOBILITY**





Figure 6H-20. Detour for a Closed Street (TA-20)

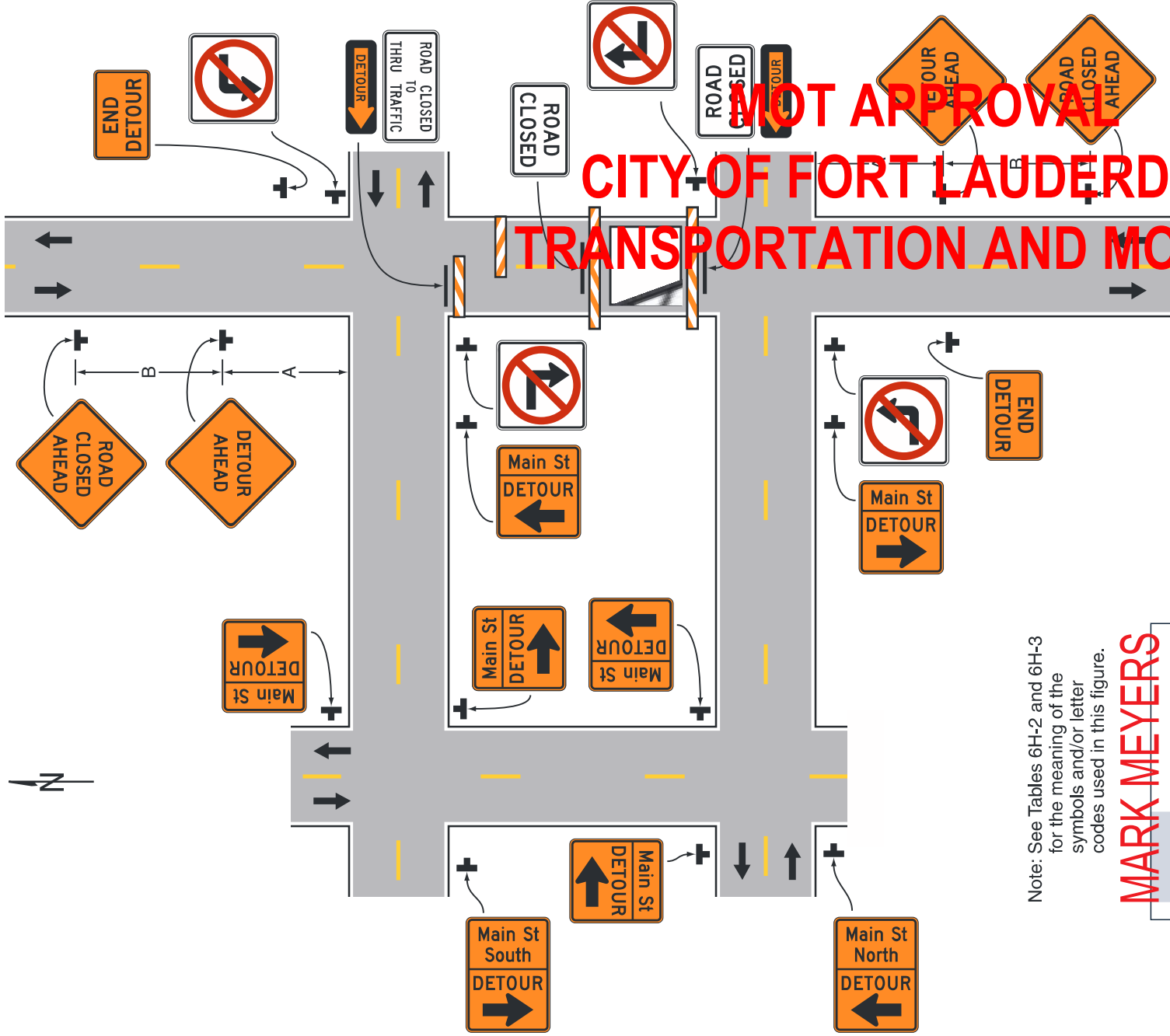

**NOT APPROVAL**  
**CITY OF FORT LAUDERDALE**  
**TRANSPORTATION AND MOBILITY**

Note: See Tables 6H-2 and 6H-3 for the meaning of the symbols and/or letter codes used in this figure.

**MARK MEYERS**

Mark Meyers	
Certificate:	Has Completed a FDOT Approved Temporary Traffic Control: Advanced Course.
605769	
Issued:	02/13/2023 Training Provider: myTTConline
Expires:	02/02/2027
Instructor:	H
83 Geneva Dr., Ste. 621394 Oviedo, FL 32762 Ph: 407-901-0206	
Verify this Certificate at <a href="http://www.fdot.com">www.fdot.com</a> .	

Typical Application 20







# TAM-MOT-23040039 Air Show - Las Olas Blvd

Final Audit Report

2023-04-27

Created:	2023-04-25
By:	Morgan Dunn (MDunn@fortlauderdale.gov)
Status:	Signed
Transaction ID:	CBJCHBCAABAAjWqvG-Je9mCDHqfyysnvHi_8O8YGPnyT

## "TAM-MOT-23040039 Air Show - Las Olas Blvd" History

-  Document created by Morgan Dunn (MDunn@fortlauderdale.gov)  
2023-04-25 - 4:42:30 PM GMT- IP address: 50.232.252.93
-  Document emailed to Lisa Marie Glover (LGlover@fortlauderdale.gov) for signature  
2023-04-25 - 4:42:52 PM GMT
-  Email viewed by Lisa Marie Glover (LGlover@fortlauderdale.gov)  
2023-04-27 - 1:07:33 PM GMT- IP address: 104.47.65.254
-  Signer Lisa Marie Glover (LGlover@fortlauderdale.gov) entered name at signing as Lisa Marie Glover for Ben Rogers  
2023-04-27 - 1:08:01 PM GMT- IP address: 50.232.252.93
-  Document e-signed by Lisa Marie Glover for Ben Rogers (LGlover@fortlauderdale.gov)  
Signature Date: 2023-04-27 - 1:08:03 PM GMT - Time Source: server- IP address: 50.232.252.93
-  Agreement completed.  
2023-04-27 - 1:08:03 PM GMT



Powered by  
**Adobe**  
Acrobat Sign