



Memorandum

Memorandum No: 23-108

Date: August 31, 2023

To: Honorable Mayor, Vice Mayor, and Commissioners

From: Greg Chavarria, City Manager 
Greg Chavarria (Sep 6, 2023 13:10 EDT)

Re: **Laudertrail Update**

This memorandum shall serve as an update to the LauderTrail initiative. The Parks Bond allocated \$5,000,000 towards LauderTrail and the Transportation and Mobility Department has four active efforts underway.

1) Downtown Mobility Hub to Carter Park (Attachments 1 and 2):

The City onboarded Kittleson utilizing Parks Bond funds to design this segment of the trail. The design is scheduled to take 12 months with public input at 30% and 60% of the design. The 30% design is currently being reviewed by City staff and public outreach to start thereafter.

2) Flagler Greenway to Holiday Park (Attachments 1 and 3):

The City onboarded Kittleson utilizing Parks Bond funds to design this segment of the trail. The design is scheduled to take 12 months with public input at 30% and 60% of the design. The 30% design is currently being reviewed by City staff and public outreach to start thereafter.

3) Downtown Mobility Hub North Extension (Attachment 4):

The original Mobility Hub project did not expend all of the grant funding and there is a balance of \$247,753. The Broward Metropolitan Planning Organization and the City are drafting a new sub-recipient agreement in order to extend the trail one block to the north. The City onboarded Kimley-Horn utilizing Parks Bond funds for the design. Construction will be funded with the remaining grant funds and then with Parks Bond funds.

4) Holiday Park to George English Park:

City staff submitted an application to the Florida Recreational Trails Program for this segment. The City has been notified that the project has been deemed eligible and selected for funding, contingent on available funds. The City anticipates receiving additional information if funding will be provided or not sometime in October 2023. Should funding be made available, the City will be required to provide a local match and execute an agreement. After which, staff will identify a consultant to start the design process. If State funding is not awarded, this segment's efforts will be deferred to a future date.

If you have any questions, please contact Ben Rogers, Director of Transportation and Mobility at 954-828-3781 or brogers@fortlauderdale.gov.

Attachments:

Attachment 1: Lauderdale Model Segment Design Flyer

Attachment 2: Carter Park Connection

Attachment 3: Holiday Park Connection

Attachment 4: Mobility Hub North Extension

c: Anthony G. Fajardo, Assistant City Manager
Susan Grant, Assistant City Manager
D'Wayne M. Spence, Interim City Attorney
David R. Soloman, City Clerk
Patrick Reilly, City Auditor
Department Directors
CMO Managers

LAUDERTRAIL DESIGN BEGINS



The City of Fort Lauderdale has secured \$5 million in funding and partnered with Kittelson and Associates, Inc. to design the new LauderTrail system. Public engagement—including an online survey and public meeting—will occur throughout the design process. Check out the timeline to learn more!

A TRAIL SYSTEM FOR EVERYONE

Designed for pedestrians and bicyclists who want low stress routes and separation from traffic, the LauderTrail Master Plan uses 8 miles of existing trails, incorporates 3 miles of programmed trails, and adds 31 miles of new trail. The LauderTrail estimated construction cost is \$90 million dollars.

The completed trail system will connect

-  270 businesses
-  45 parks & green spaces
-  35 neighborhoods
-  17 bus routes
-  12 schools
-  12 water taxi stops
-  2 railroad stations

COMMUNITY PLANNED & COMMUNITY LED

LauderTrail was a true community effort, with a planning team of residents from the City's four districts, one at-large neighbor, and representatives from Parks and Recreation, Planning and Zoning, Transportation and Mobility, Sustainable Development, Public Works, and the Strategic Communications Office.

Together, they worked with the Path Foundation, a non-profit that has helped communities build trails since 1991, and stakeholders from the City of Fort Lauderdale, Broward County, Brightline, the Florida East Coast Railway (FEC), FDOT, and members of the public.

SEGMENT 1 & SEGMENT 2 DESIGN

The LauderTrail Master Plan is organized into five segments numbered according to their implementation phase. Segments 1 and 2 are moving into the design phase.

DESIGN TIMELINE Segment 1 & Segment 2

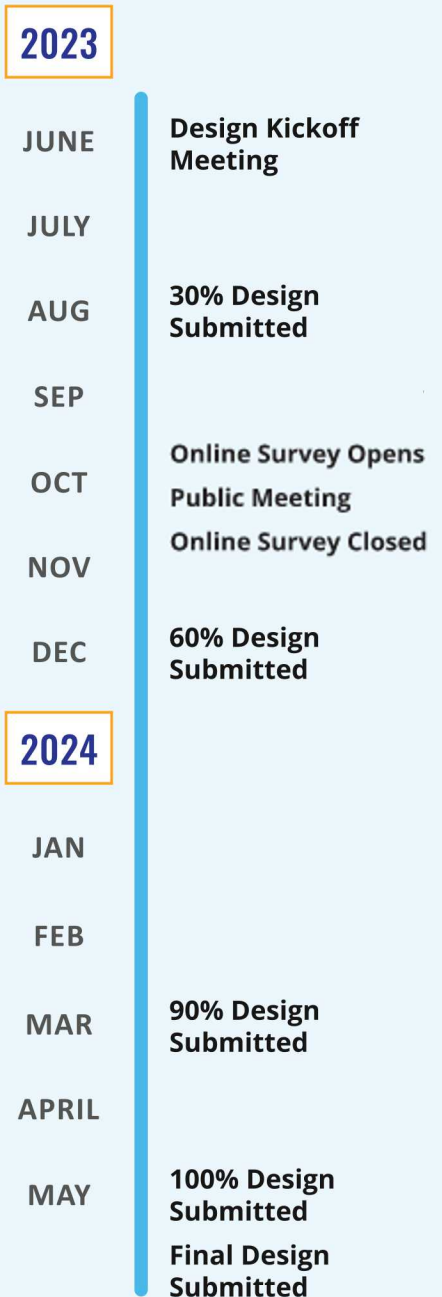

SEGMENT 1 | EASTSIDE TRAIL

NW Flagler Ave at NW 4th St to N Dixie Highway at NE 17th Ct | 4.86 miles

The Eastside Trail completes the northern spine trail along the FEC and connects the FEC corridor to Holiday Park and the southern end of Bayview Drive.

- **Connections**—Mobility Hub, Joint Government Center, FAT Village, Searstown Development, Holiday Park, Victoria Park Neighborhood, George English Park, North Dixie Highway
- **Benefits**—The trail will link existing trail segments, spur economic development along the corridor, create partnership opportunities with FDOT for intersection bike and pedestrian enhancements to US 1, and spark additions and improvements to existing park infrastructure.

SEGMENT 2 | CENTRAL LOOP

Loop between westside neighborhoods, the existing Riverwalk, and the spine trail parallel to FEC tracks | 5.79 miles

The Central Loop combines designated, quiet, low volume neighborhood streets north of the river and west of downtown, parks and green space along the river and I-95, and existing parkland and alleyways.

- **Connections**—Mills Pond Park, Delevoe Park, North Fork Elementary School, Sailboat Bend Neighborhood, Riverwalk, Brightline Station, Carter Park, Walker Elementary School
- **Benefits**—The loop will create multiple access points from surrounding streets in the northwest neighborhoods, incorporate seawall and stormwater improvements, connect schools and parks, and add public green space along the New River.

Segment 1 & Segment 2 Map

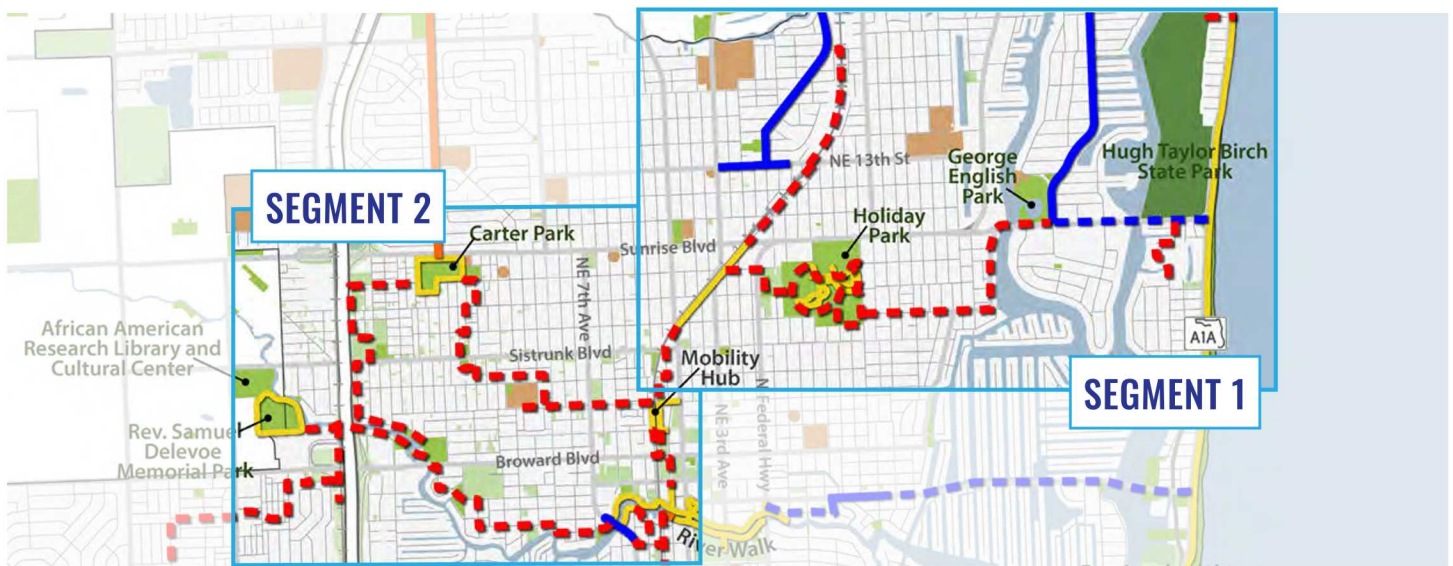

Programmed bicycle or pedestrian improvements

Suggested bicycle or pedestrian improvements

Proposed trails

Programmed trails

Existing Trails

Scan for the LauderTrail website



LEARN MORE

Visit the LauderTrail website at

<https://fortlauderdale.civilspace.io/en/projects/laudertrail-connecting-ftl>

Contact

Kristin Thompson, Division Manager

954-828-3721 | krthompson@fortlauderdale.gov

Andre Eugent, Senior Project Manager

954-828-5734 | aeugent@fortlauderdale.gov

H:\23\23330 - CITY OF FTL TRAFFIC ENGINEERING CONTRACT\012 - LAUDERTRAIL DESIGN\DESIGN\EXHIBITS\20230809 - 30PERCPLANS\E-PS_23330_P2.DWG

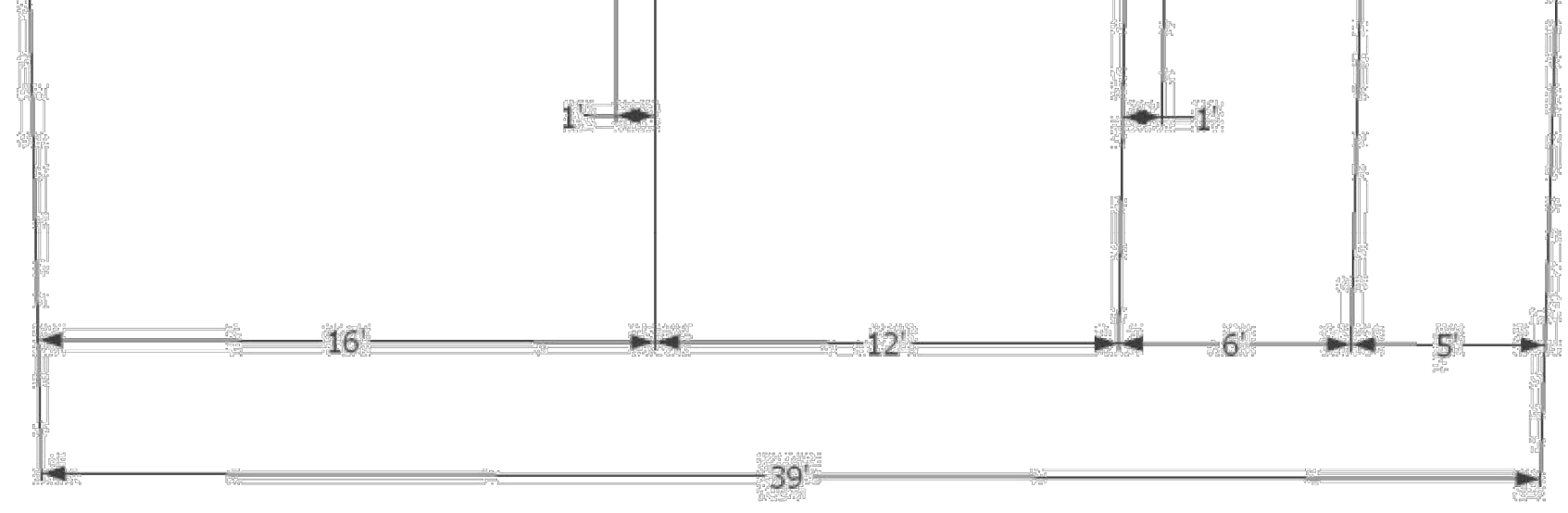
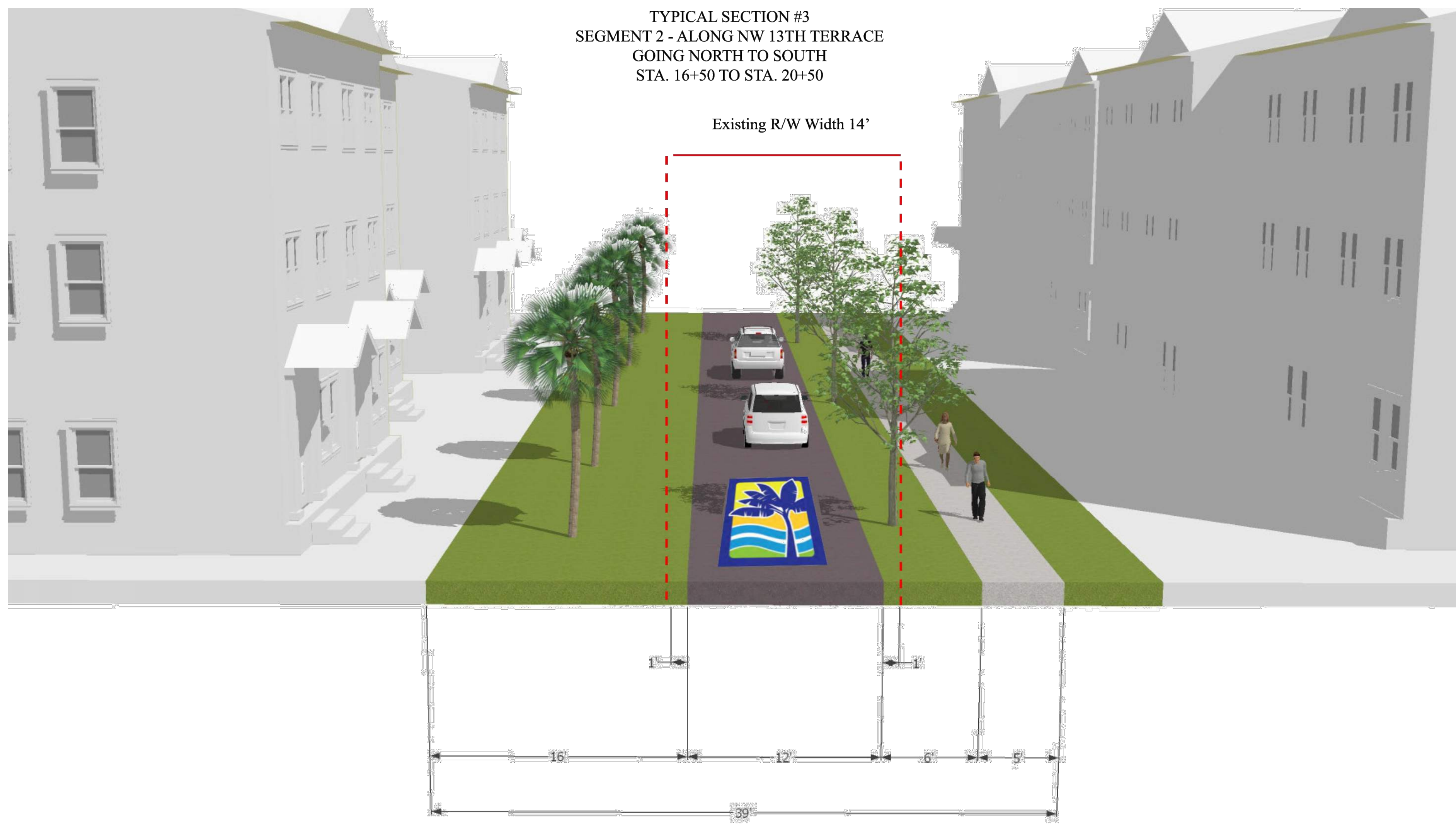
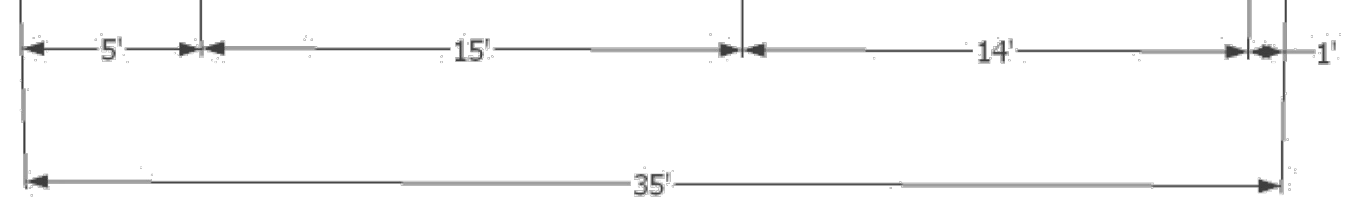

TYPICAL SECTION #3
SEGMENT 2 - ALONG NW 13TH TERRACE
GOING NORTH TO SOUTH
STA. 16+50 TO STA. 20+50

TYPICAL SECTION #4
SEGMENT 2 - ALONG NW 13TH TERRACE
GOING NORTH TO SOUTH
STA. 20+50 TO STA. 22+50

30% DESIGN - NOT FOR CONSTRUCTION OR BID

DRAWN BY:	DATE:
KAI	8/9/2023
DESIGNED BY:	SCALE:
KAI	1"=20'
CHECKED BY:	FIELD BOOK:
KAI	

CITY OF FORT LAUDERDALE
TRANSPORTATION & MOBILITY



290 NE 3RD AVE., FORT LAUDERDALE, FL 33301

NO.	REVISIONS		DESCRIPTION
	DATE	BY	

PROJECT # P23330_012
LAUDERTRAIL
SEGMENT 1 IMPROVEMENT PLAN
30% CONCEPT PLANS
FORT LAUDERDALE, FLORIDA

SHEET NO.	OF
T1.1	
TOTAL:	
CAD FILE:	
E-PS_23330_P2	
DRAWING FILE NO.	
4-XXX-XX	

H:\23\23330 - CITY OF FTL TRAFFIC ENGINEERING CONTRACT\012 - LAUDERTRAIL DESIGN\DESIGN\EXHIBITS\20230809 - 30PERCPLANS\E-PS_23330_P2.DWG

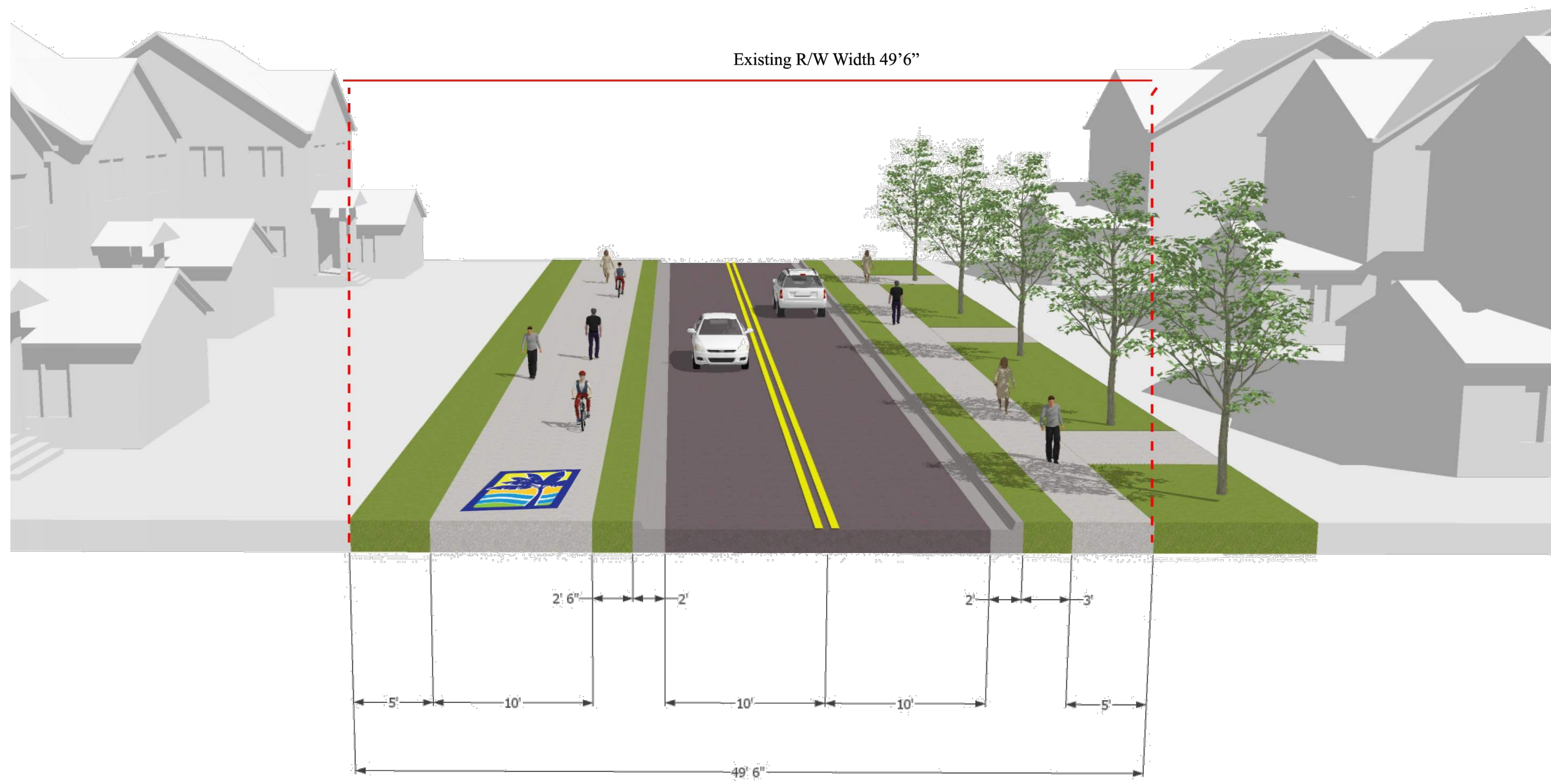

TYPICAL SECTION #5
SEGMENT 2 - ALONG NW 13TH TERRACE
GOING NORTH TO SOUTH
STA. 22+50 TO STA. 29+00

Existing R/W Width 70'

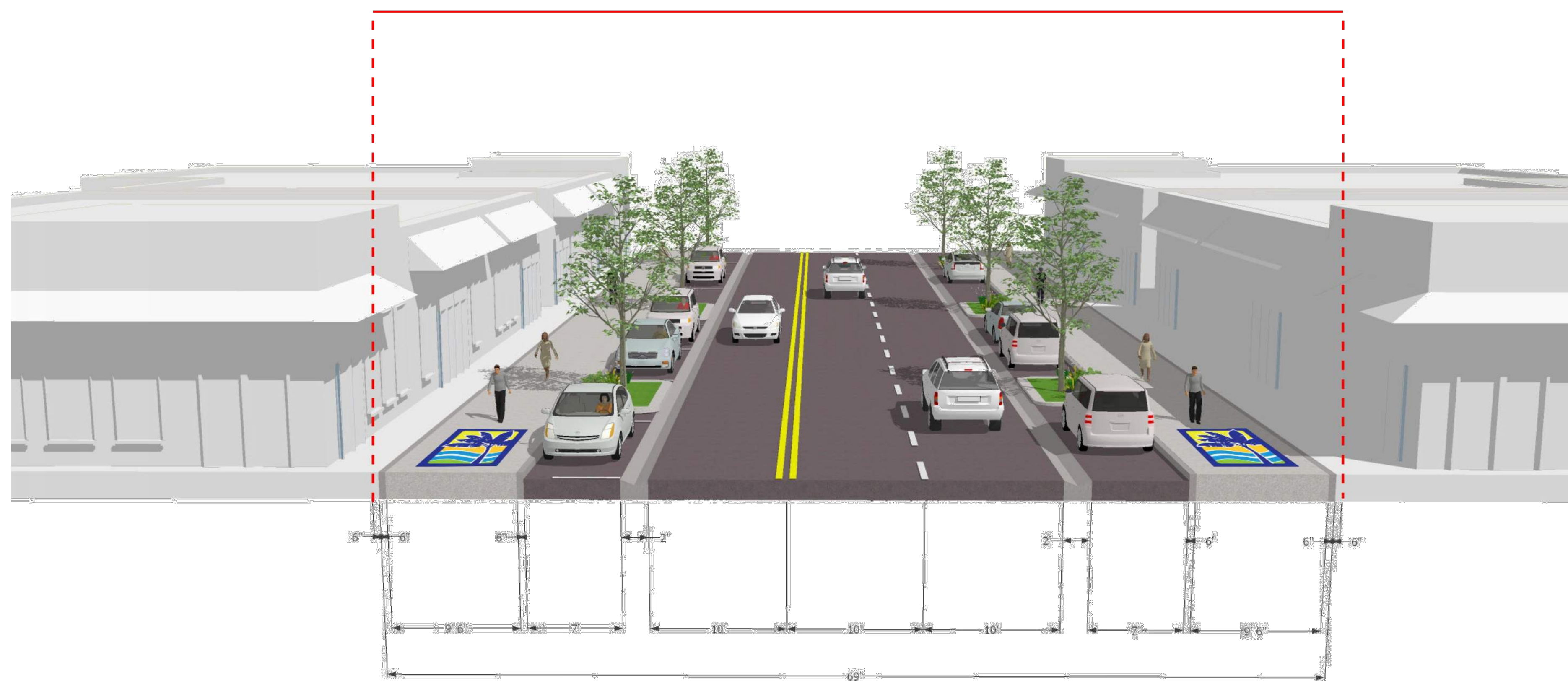

TYPICAL SECTION #6
SEGMENT 2 - ALONG NW 6TH ST
GOING WEST TO EAST
STA. 29+50 TO STA. 33+50

30% DESIGN - NOT FOR CONSTRUCTION OR BID

PROJECT # P23330_012
LAUDERTRAIL
SEGMENT 1 IMPROVEMENT PLAN
30% CONCEPT PLANS
FORT LAUDERDALE, FLORIDA

SHEET NO. OF
T1.2
TOTAL:
CAD FILE:
E-PS_23330_P2
DRAWING FILE NO.
4-XXX-XX

NO.	DATE	BY	CHK'D	REVISIONS DESCRIPTION

CITY OF FORT LAUDERDALE
TRANSPORTATION & MOBILITY



290 NE 3RD AVE., FORT LAUDERDALE, FL 33301

DRAWN BY: KAI	DATE: 8/9/2023
DESIGNED BY: KAI	SCALE: 1"=20'
CHECKED BY: KAI	FIELD BOOK:

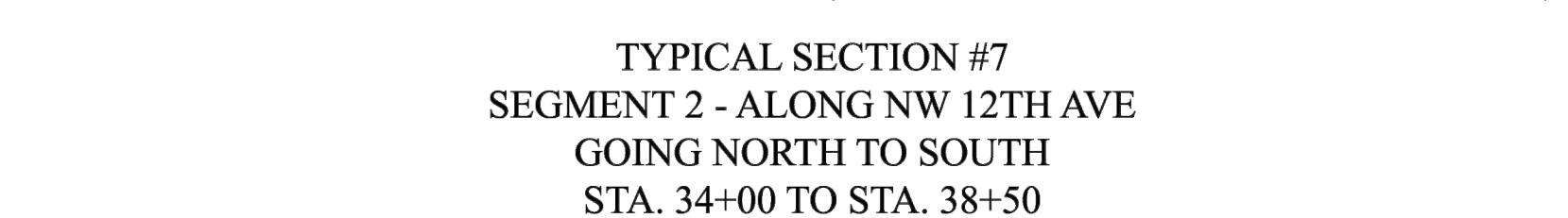

TYPICAL SECTION #7
SEGMENT 2 - ALONG NW 12TH AVE
GOING NORTH TO SOUTH
STA. 34+00 TO STA. 38+50

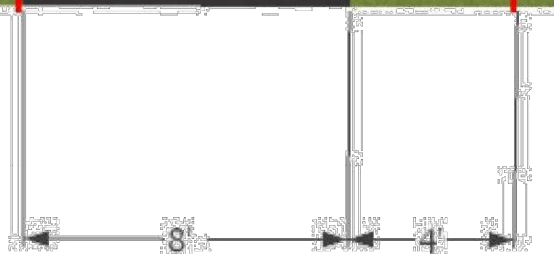
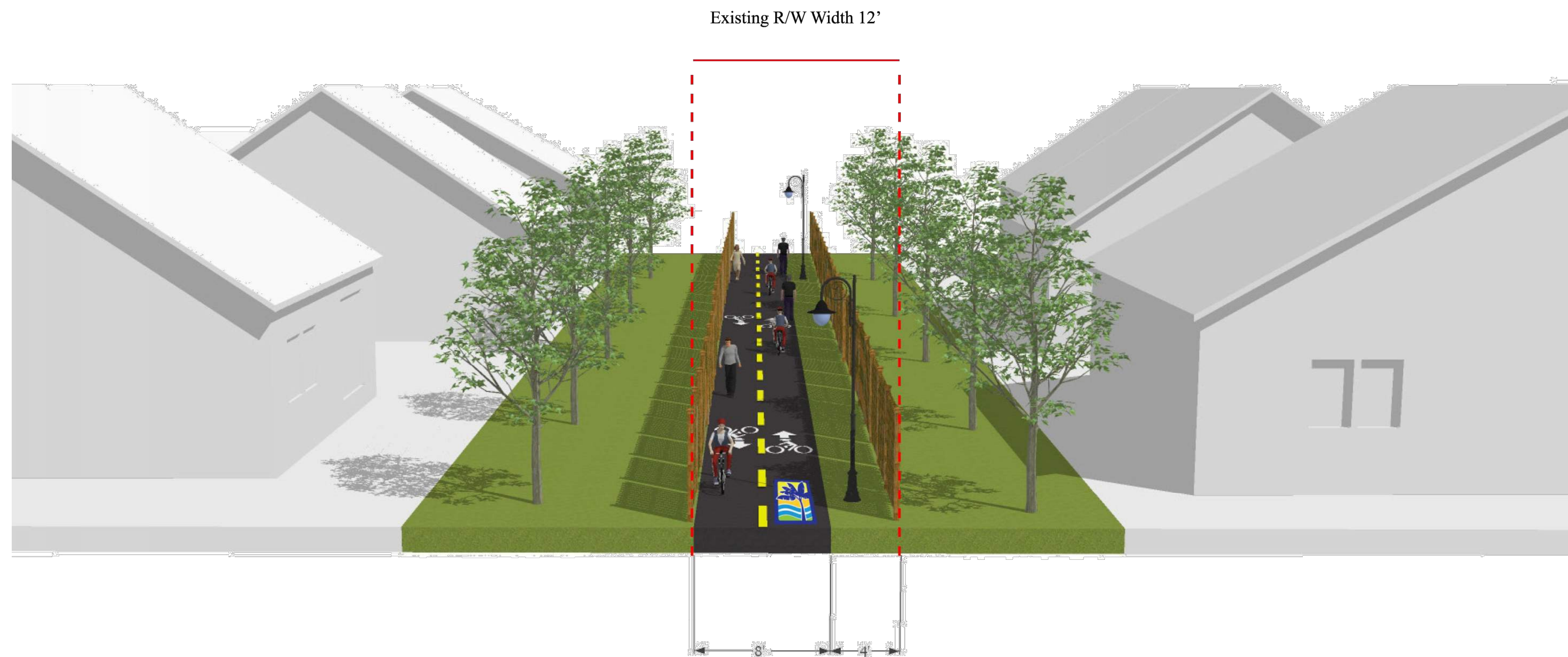

TYPICAL SECTION #8
SEGMENT 2 - ALONG NW 5TH CT ALLEYWAY
WEST TO EAST
STA. 38+50 TO STA. 48+50

30% DESIGN - NOT FOR CONSTRUCTION OR BID

PROJECT # P23330_012
LAUDERTRAIL
SEGMENT 1 IMPROVEMENT PLAN
30% CONCEPT PLANS
FORT LAUDERDALE, FLORIDA

SHEET NO.	OF
T1.3	
TOTAL:	
CAD FILE:	
E-PS_23330_P2	
DRAWING FILE NO.	
4-XXX-XX	

NO.	REVISIONS		DESCRIPTION
	DATE	BY	

CITY OF FORT LAUDERDALE
TRANSPORTATION
&
MOBILITY

290 NE 3RD AVE, FORT LAUDERDALE, FL 33301

DRAWN BY:	DATE:
KAI	8/9/2023
DESIGNED BY:	SCALE:
KAI	1"=20'
CHECKED BY:	FIELD BOOK:
KAI	

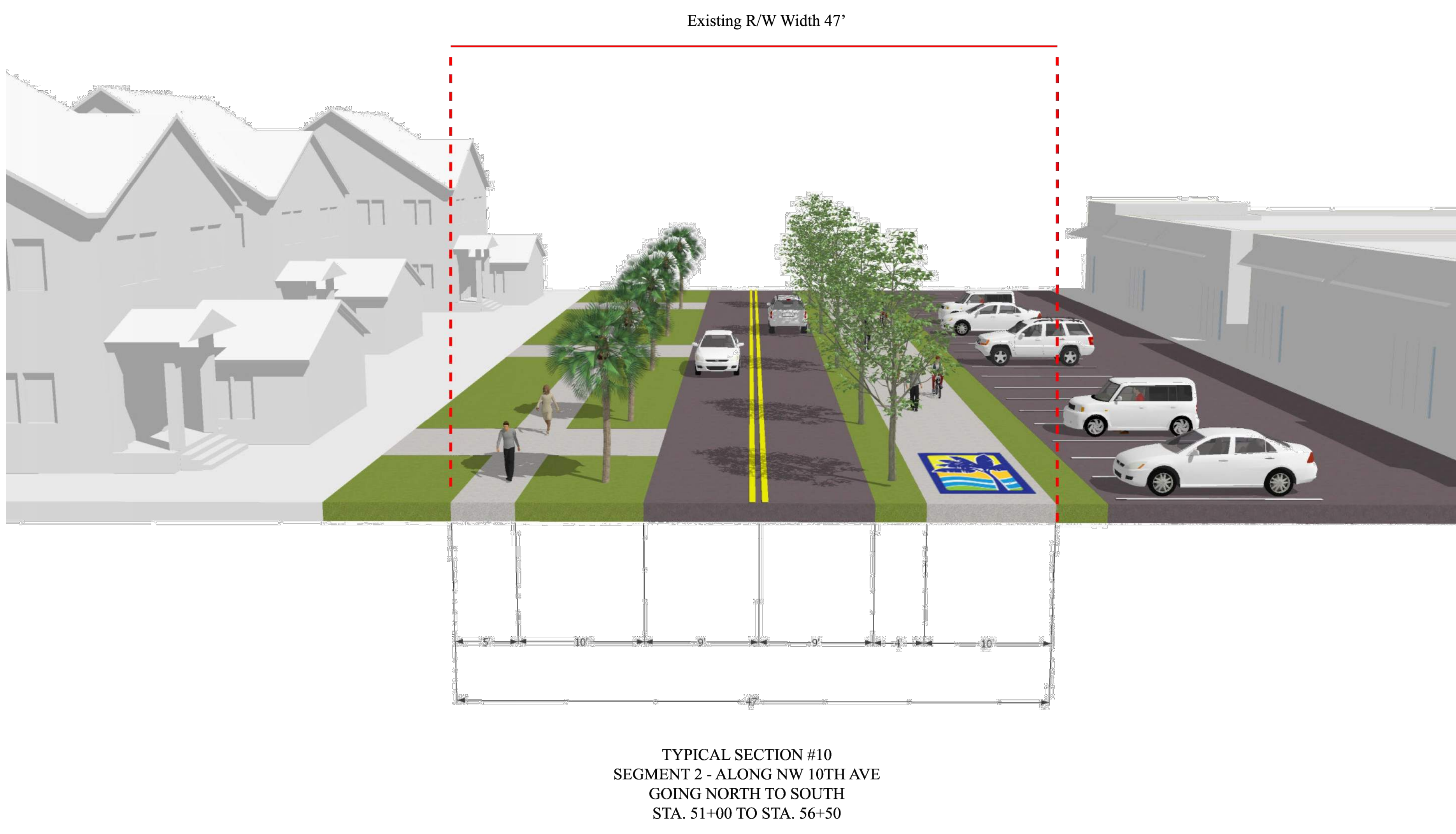
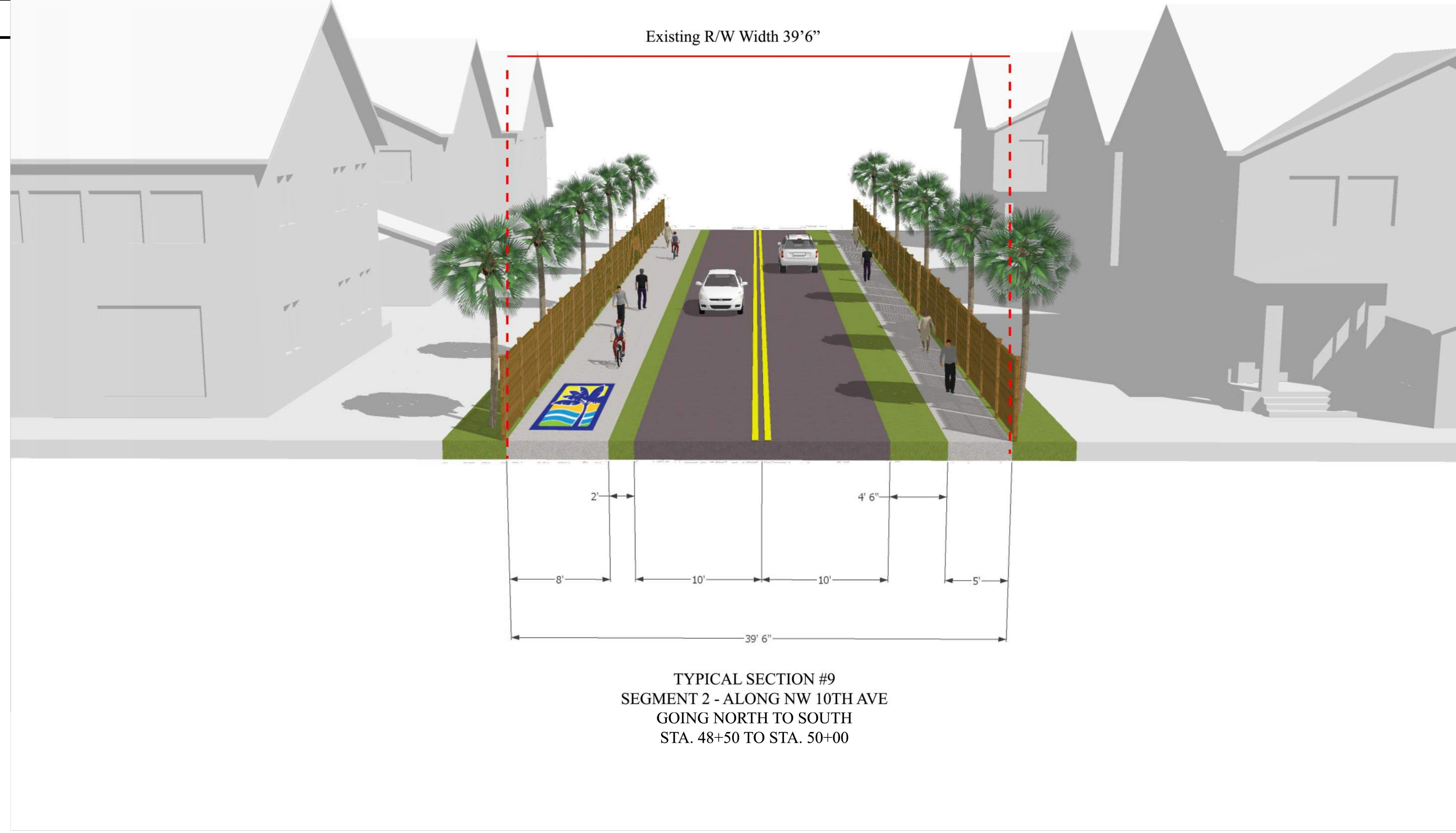

30% DESIGN - NOT FOR CONSTRUCTION OR BID

PROJECT # P23330_012
LAUDERTRAIL
SEGMENT 1 IMPROVEMENT PLAN
30% CONCEPT PLANS
FORT LAUDERDALE, FLORIDA

SHEET NO.	OF
T1.4	
TOTAL:	
CAD FILE: E-PS_23330_P2	
DRAWING FILE NO. 4-XXX-XX	

NO.	DATE	BY	CHK'D	REVISIONS
				DESCRIPTION

CITY OF FORT LAUDERDALE
TRANSPORTATION
&
MOBILITY

290 NE 3RD AVE., FORT LAUDERDALE, FL 33301

DRAWN BY: KAI	DATE: 8/9/2023
DESIGNED BY: KAI	SCALE: 1"=20'
CHECKED BY: KAI	FIELD BOOK:

H:\23\23330 - CITY OF FTL TRAFFIC ENGINEERING CONTRACT\012 - LAUDERTRAIL DESIGN\DESIGN\EXHIBITS\20230809 - 30PERCPLANS\E-PS_23330_P2.DWG

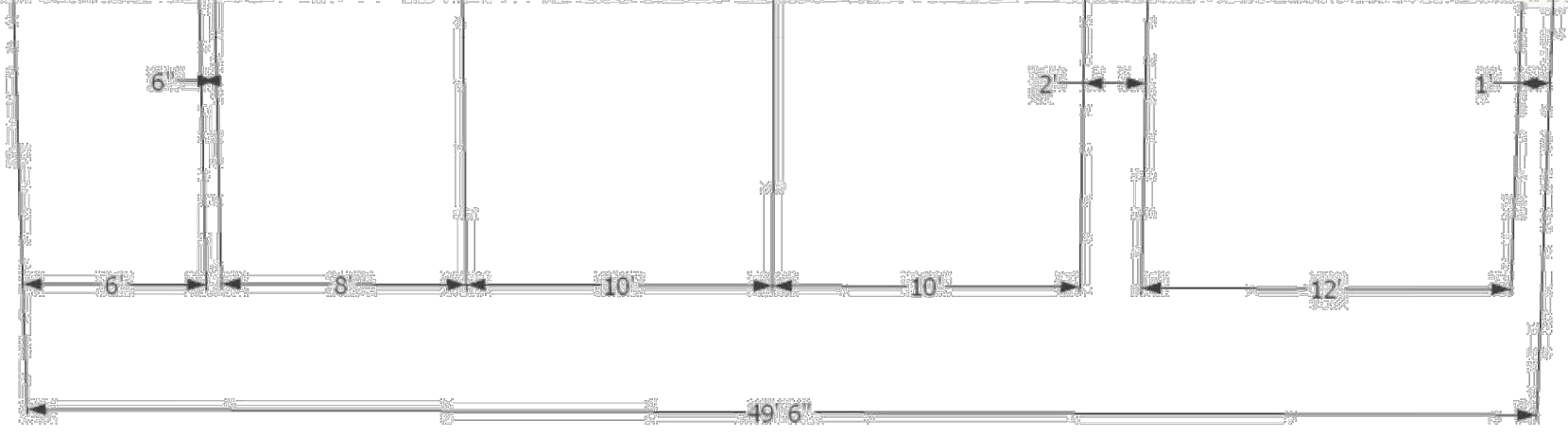
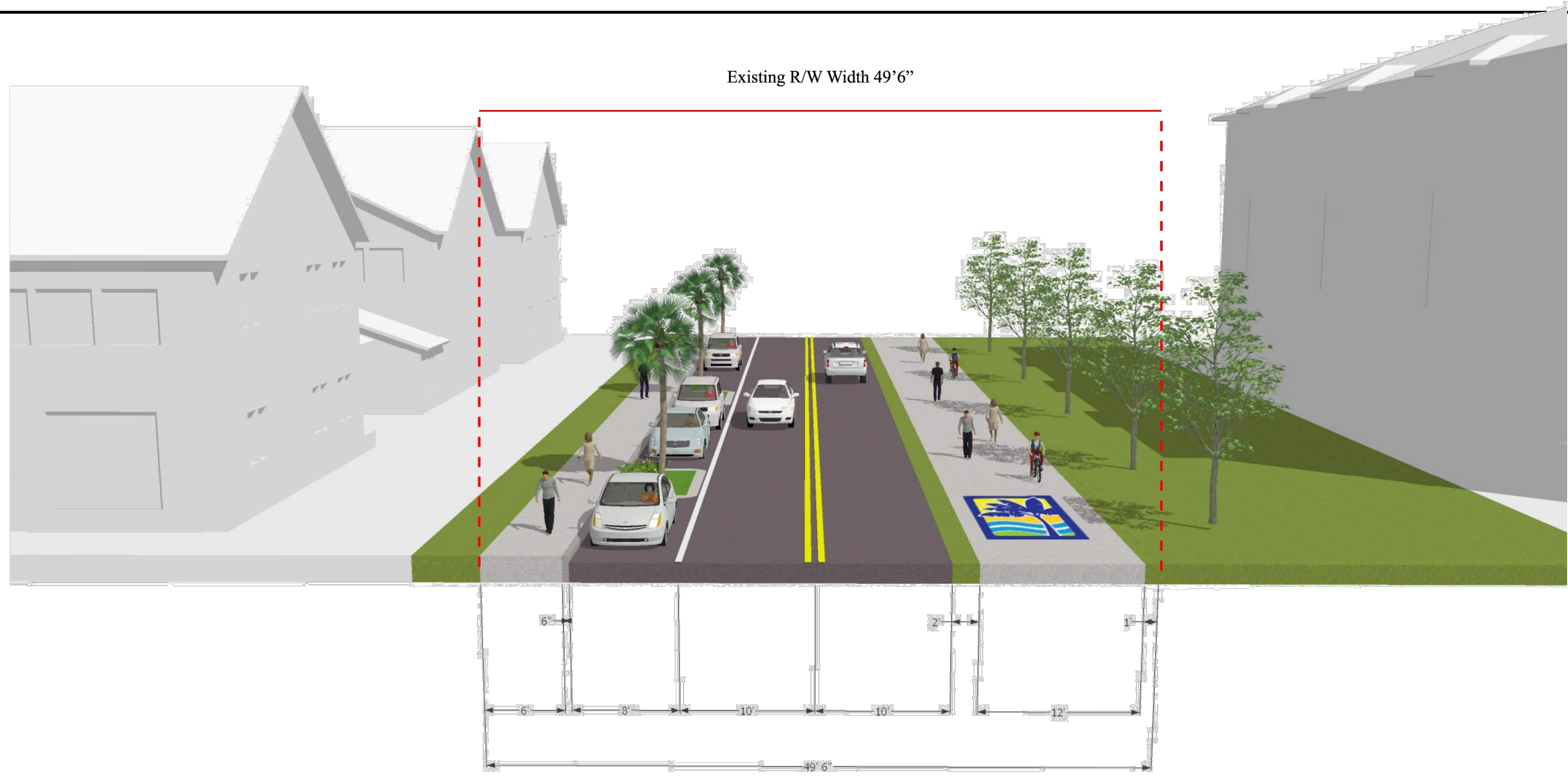

TYPICAL SECTION #11
SEGMENT 2 - ALONG NW 4TH ST

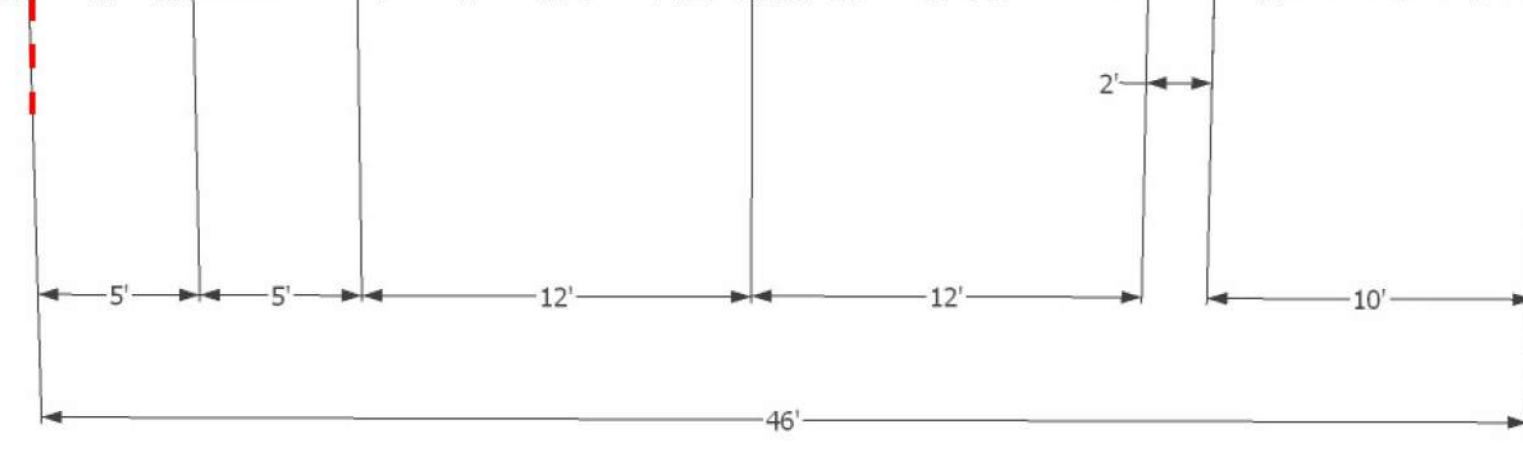
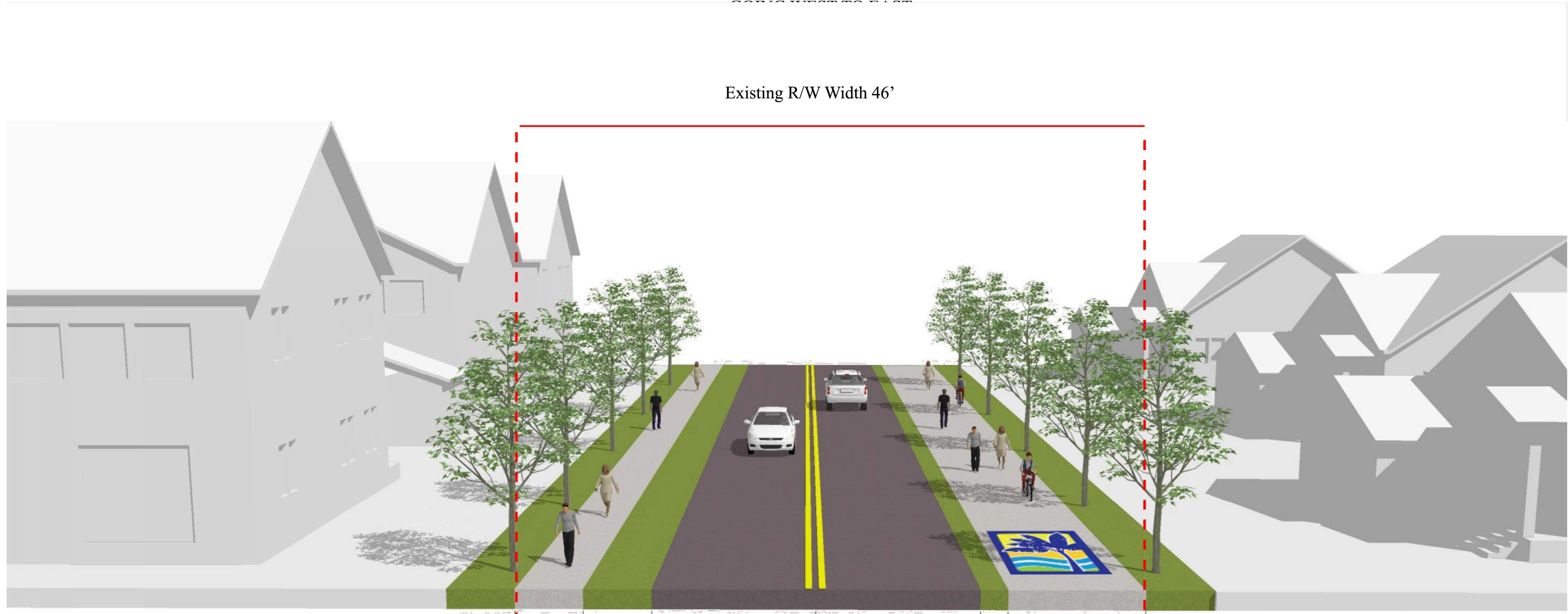

TYPICAL SECTION #12
SEGMENT 2 - ALONG NW 4TH ST
GOING WEST TO EAST
STA. 60+50 TO STA. 70+50

30% DESIGN - NOT FOR CONSTRUCTION OR BID

PROJECT # P23330_012
LAUDERTRAIL
SEGMENT 1 IMPROVEMENT PLAN
30% CONCEPT PLANS
FORT LAUDERDALE, FLORIDA

SHEET NO. **T1.5** OF

TOTAL:
CAD FILE:
E-PS_23330_P2
DRAWING FILE NO.
4-XXX-XX

NO.	REVISIONS		DESCRIPTION
	DATE	BY	

CITY OF FORT LAUDERDALE
TRANSPORTATION
&
MOBILITY



290 NE 3RD AVE., FORT LAUDERDALE, FL 33301

DRAWN BY: KAI	DATE: 8/9/2023
DESIGNED BY: KAI	SCALE: 1"=20'
CHECKED BY: KAI	FIELD BOOK:

H:\23\23330 - CITY OF FTL TRAFFIC ENGINEERING CONTRACT\012 - LAUDERTRAIL DESIGN\DESIGN\EXHIBITS\20230809 - 30PERCPLANS\E-PS_23330_P2.DWG

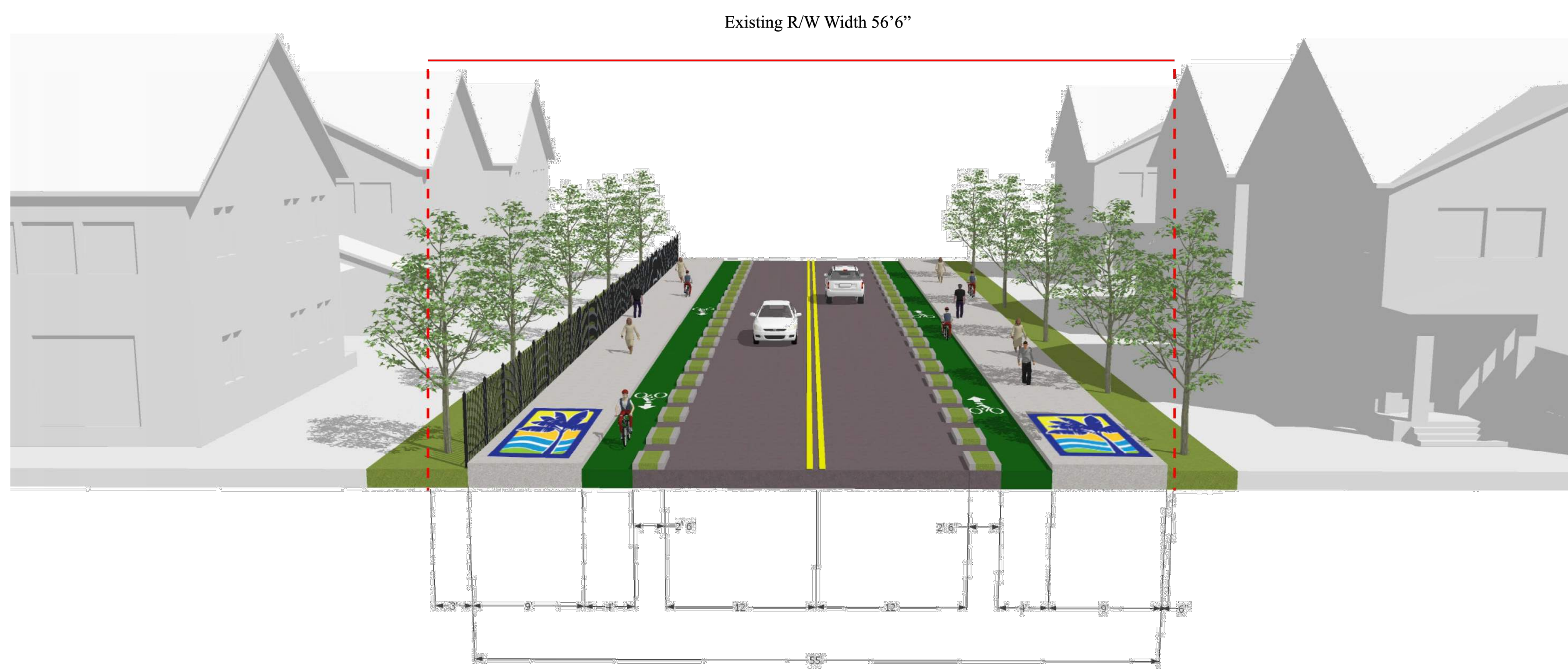

TYPICAL SECTION #13
SEGMENT 2 - ALONG NW 4TH ST
GOING WEST TO EAST
STA. 70+50 TO STA. 86+00

30% DESIGN - NOT FOR CONSTRUCTION OR BID

PROJECT # P23330_012
LAUDERTRAIL
SEGMENT 1 IMPROVEMENT PLAN
30% CONCEPT PLANS
FORT LAUDERDALE, FLORIDA

SHEET NO.	OF
T1.6	
TOTAL:	
CAD FILE: E-PS_23330_P2	
DRAWING FILE NO. 4-XXX-XX	

NO.	REVISIONS		DESCRIPTION
	DATE	BY	

CITY OF FORT LAUDERDALE
TRANSPORTATION
&
MOBILITY

290 NE 3RD AVE., FORT LAUDERDALE, FL 33301

DRAWN BY: KAI	DATE: 8/9/2023
DESIGNED BY: KAI	SCALE: 1"=20'
CHECKED BY: KAI	FIELD BOOK:

H:\23\23330 - CITY OF FTL TRAFFIC ENGINEERING CONTRACT\012 - LAUDERTRAIL DESIGN\DESIGN\EXHIBITS\20230809 - 30PERCPLANS\E-PS_23330_P1.DWG

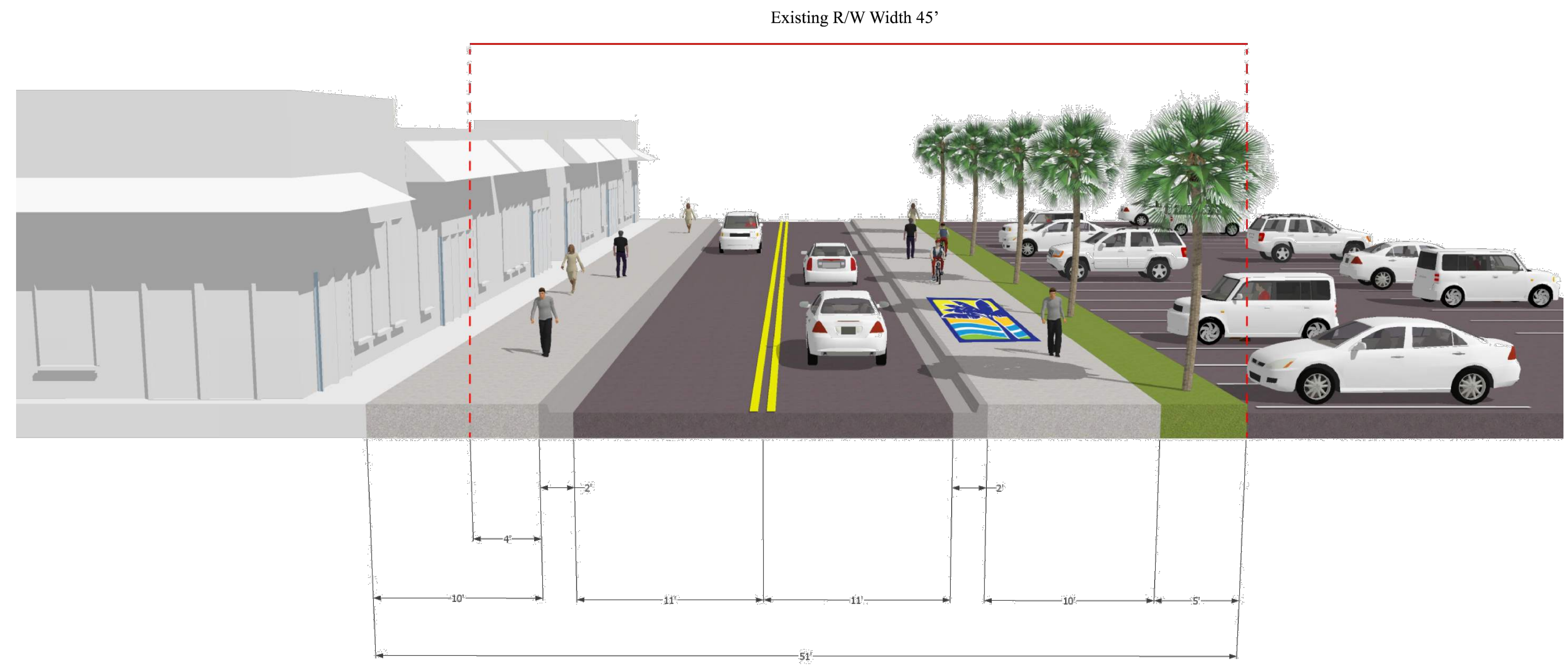

TYPICAL SECTION #1
SEGMENT 1 - ALONG NE 9TH ST
GOING WEST TO EAST
STA. 0+85.91 TO STA. 3+11.78

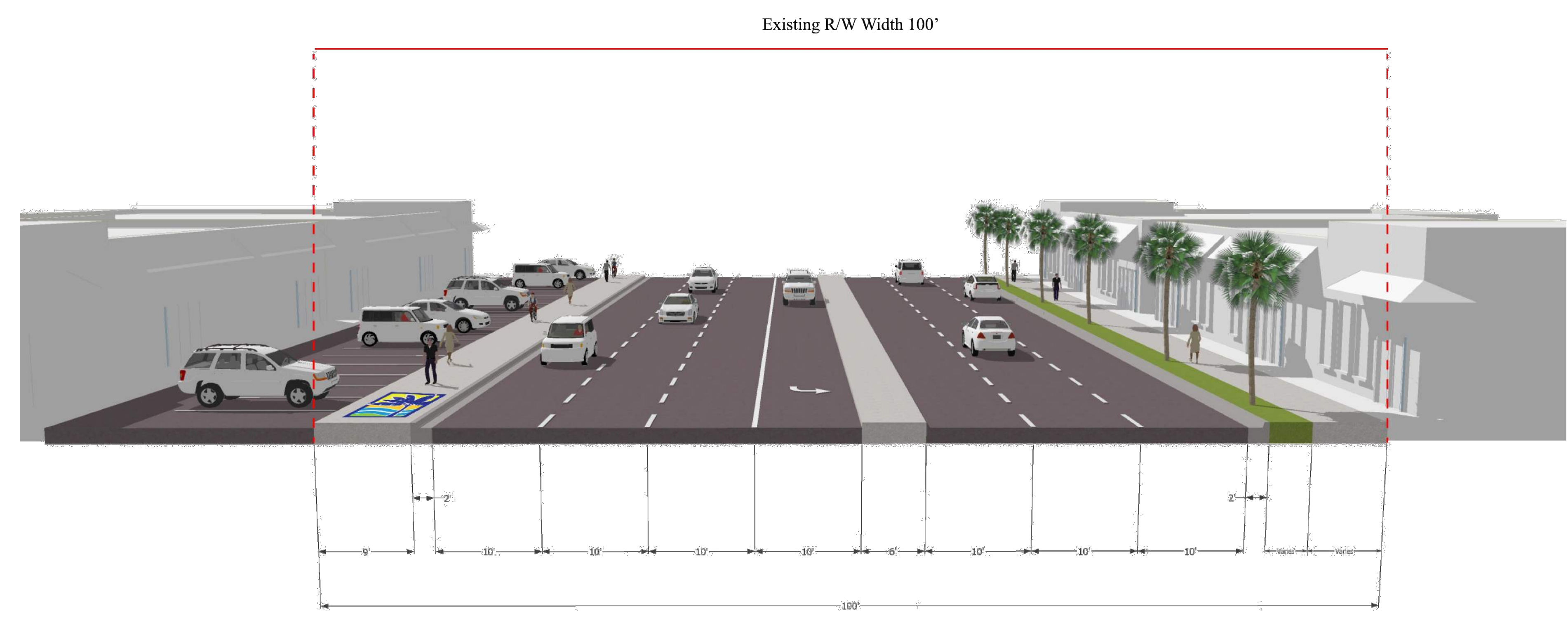

TYPICAL SECTION #2
SEGMENT 1 - ALONG US-1
GOING NORTH TO SOUTH
STA. 7+85.13 TO STA. 9+05.65

30% DESIGN - NOT FOR CONSTRUCTION OR BID

DATE:	8/9/2023
DRAWN BY:	KAI
DESIGNED BY:	KAI
CHECKED BY:	KAI
SCALE:	1"=20'
FIELD BOOK:	

CITY OF FORT LAUDERDALE
TRANSPORTATION & MOBILITY



290 NE 3RD AVE., FORT LAUDERDALE, FL 33301

NO.	REVISIONS		DESCRIPTION
	DATE	BY	

PROJECT # P23330_012
LAUDERTRAIL
SEGMENT 1 IMPROVEMENT PLAN
30% CONCEPT PLANS
FORT LAUDERDALE, FLORIDA

SHEET NO.	OF
T1.0	
TOTAL:	
CAD FILE:	E-PS_23330_P1
DRAWING FILE NO.	4-XXX-XX

H:\23\23330 - CITY OF FTL TRAFFIC ENGINEERING CONTRACT\012 - LAUDERTRAIL DESIGN\DESIGN\EXHIBITS\20230809 - 30PERCPLANS\E-PS_23330_P1.DWG

Existing R/W Width 190'

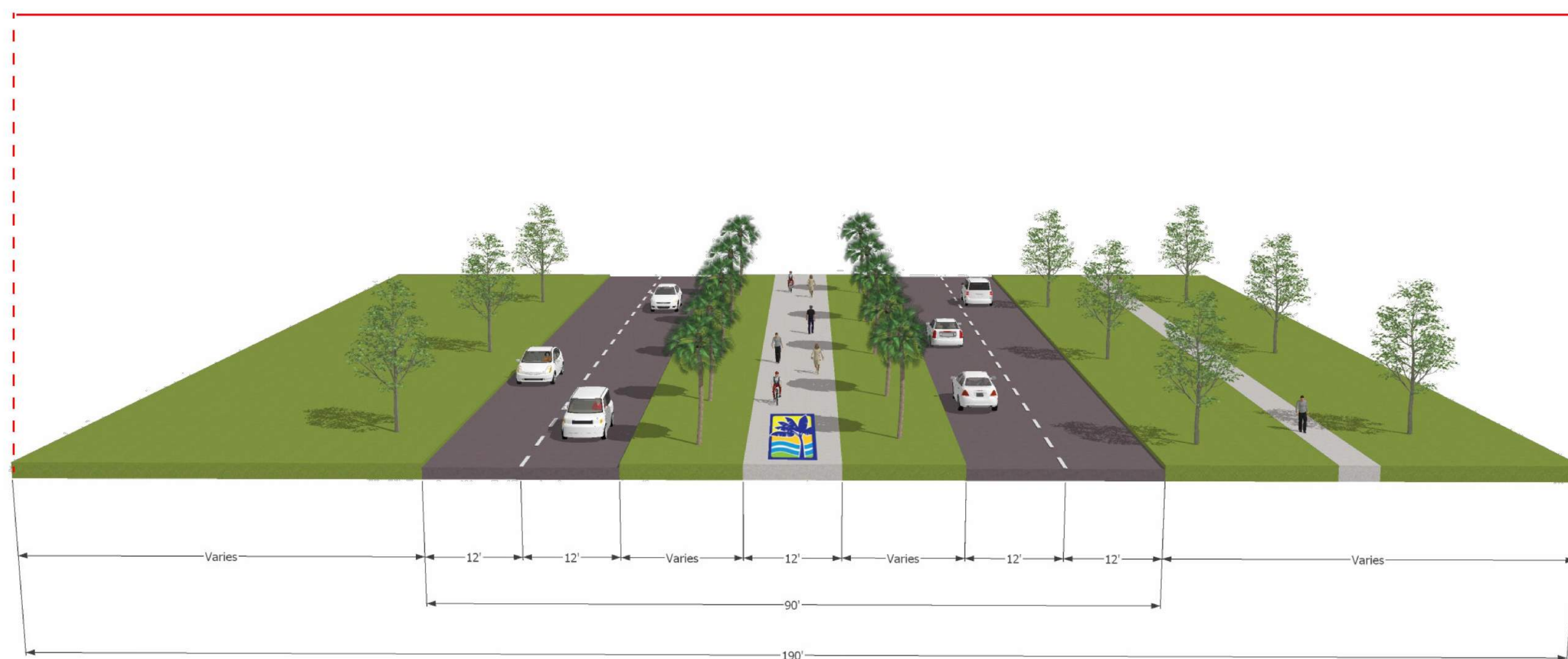

TYPICAL SECTION #3 - OPTION 1
SEGMENT 1 - ALONG NE 8TH ST
GOING WEST TO EAST
STA. 13+58.50 TO STA. 22+85.00

Existing R/W Width 190'

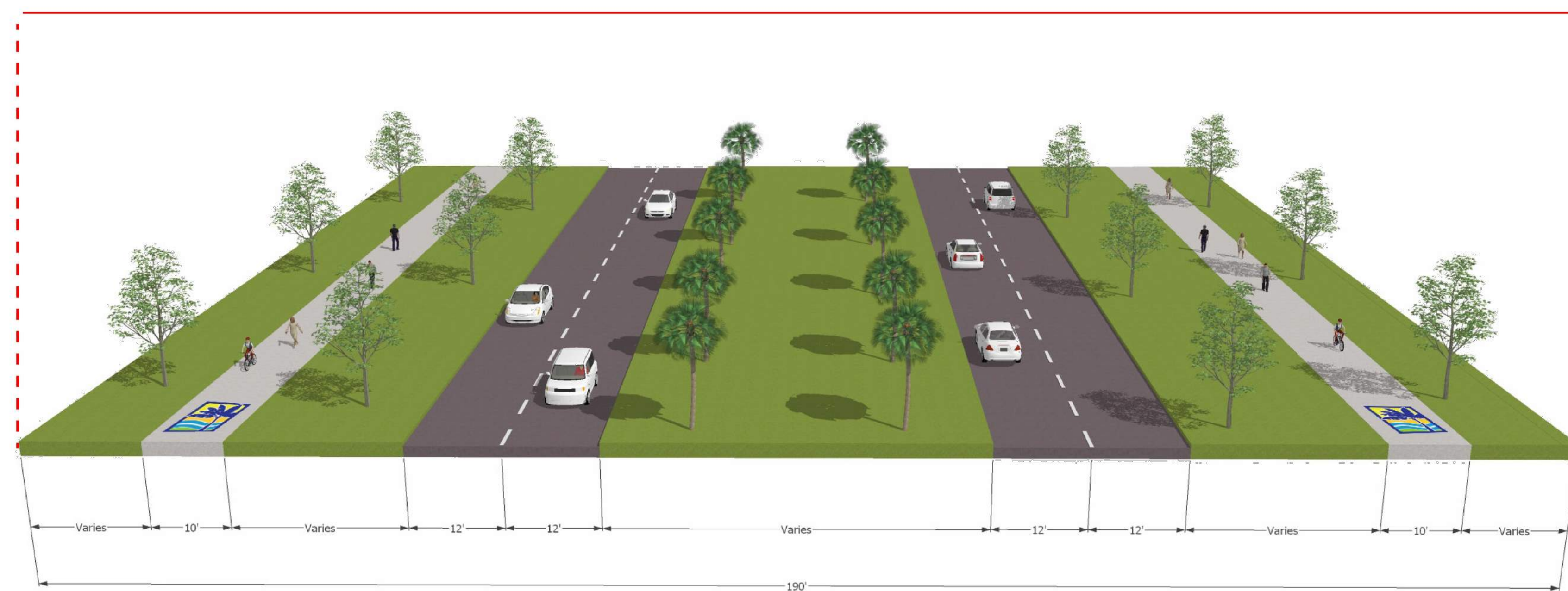

TYPICAL SECTION #3 - OPTION 2
SEGMENT 1 - ALONG NE 8TH ST
GOING WEST TO EAST
STA. 13+58.50 TO STA. 22+85.00

30% DESIGN - NOT FOR CONSTRUCTION OR BID

DATE:	8/9/2023
DRAWN BY:	KAI
DESIGNED BY:	KAI
CHECKED BY:	KAI
SCALE:	1"=20'
FIELD BOOK:	

CITY OF FORT LAUDERDALE
TRANSPORTATION & MOBILITY



290 NE 3RD AVE., FORT LAUDERDALE, FL 33301

NO.	DATE	BY	CHK'D	REVISIONS DESCRIPTION

PROJECT # P23330_012
LAUDERTRAIL
SEGMENT 1 IMPROVEMENT PLAN
30% CONCEPT PLANS
FORT LAUDERDALE, FLORIDA

SHEET NO.	OF
T1.1	

TOTAL:
CAD FILE:
E-PS_23330_P1
DRAWING FILE NO.
4-XXX-XX

